

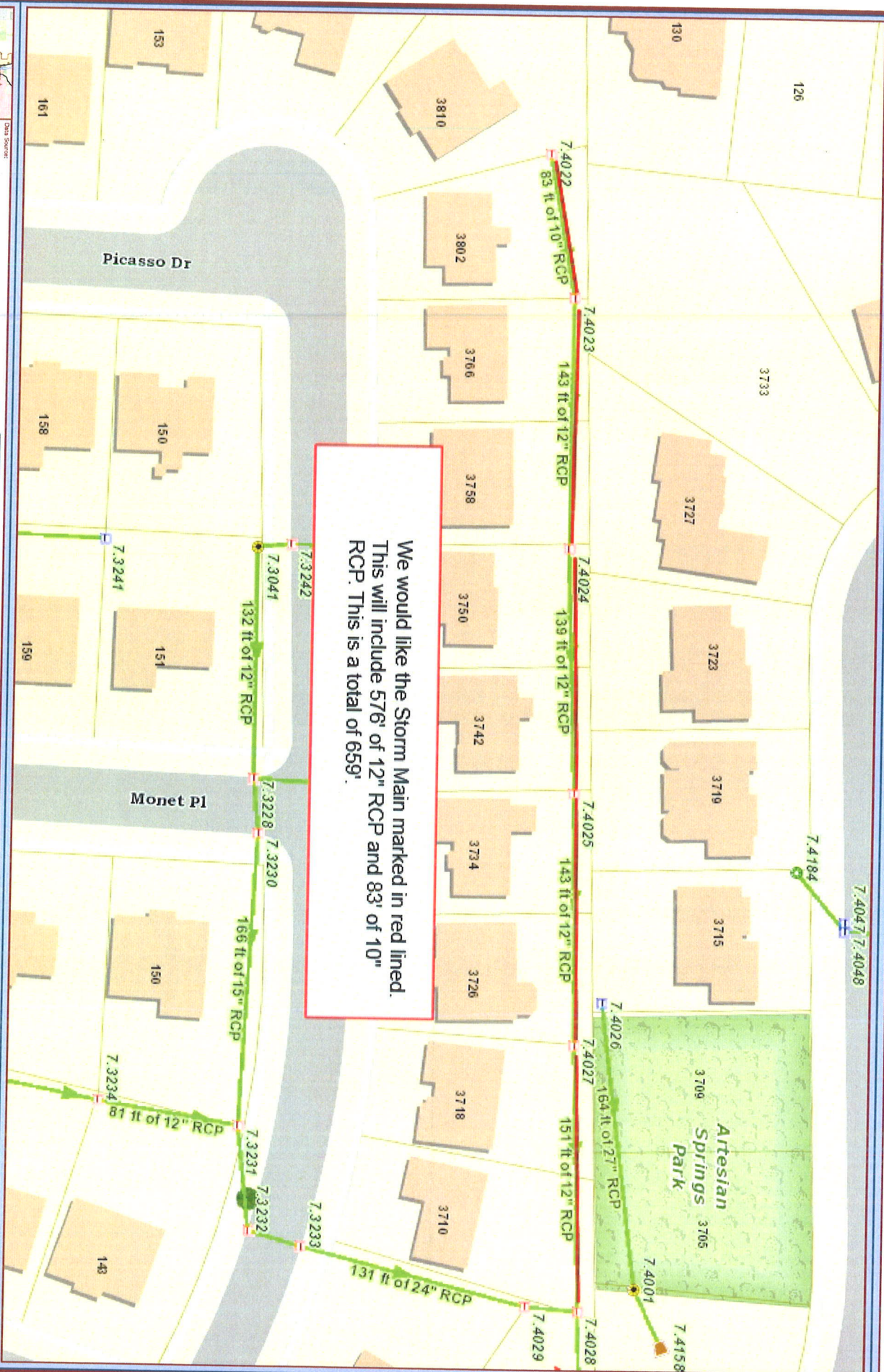

**City of St. Charles, Illinois**  
 Two East Main Street St. Charles, IL 60174-1084  
 Phone: (630) 577-4400 Fax: (630) 577-4440 [www.stcharles.il.gov](http://www.stcharles.il.gov)

# Precision GIS

**RAYMOND ROGINA** Mayor  
**MARK KOENEN** City Administrator



We would like the Storm Main marked in red lined. This will include 576' of 12" RCP and 83' of 10" RCP. This is a total of 659'.



Data Source:  
 City of St. Charles, Illinois  
 Kane County, Illinois  
 Projection: Transverse Mercator  
 Coordinate System: Illinois State Plane East  
 Contour Interval: 10 Feet  
 Printed on: March 10, 2010 02:23 PM

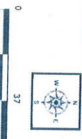

This work was created for planning purposes only and is provided as is, without warranty of any kind, either expressed or implied, including but not limited to, accuracy, completeness, and reliability. The City of St. Charles and its employees do not assume any liability for any errors or omissions that may appear in this report. The City of St. Charles and its employees do not assume any liability for any damages, including but not limited to, direct, indirect, or consequential damages, arising out of the use of this report. The City of St. Charles and its employees do not assume any liability for any damages, including but not limited to, direct, indirect, or consequential damages, arising out of the use of this report. The City of St. Charles and its employees do not assume any liability for any damages, including but not limited to, direct, indirect, or consequential damages, arising out of the use of this report.

