

5' TO 10' (TYP.)
PUBLIC UTILITY
EASEMENT

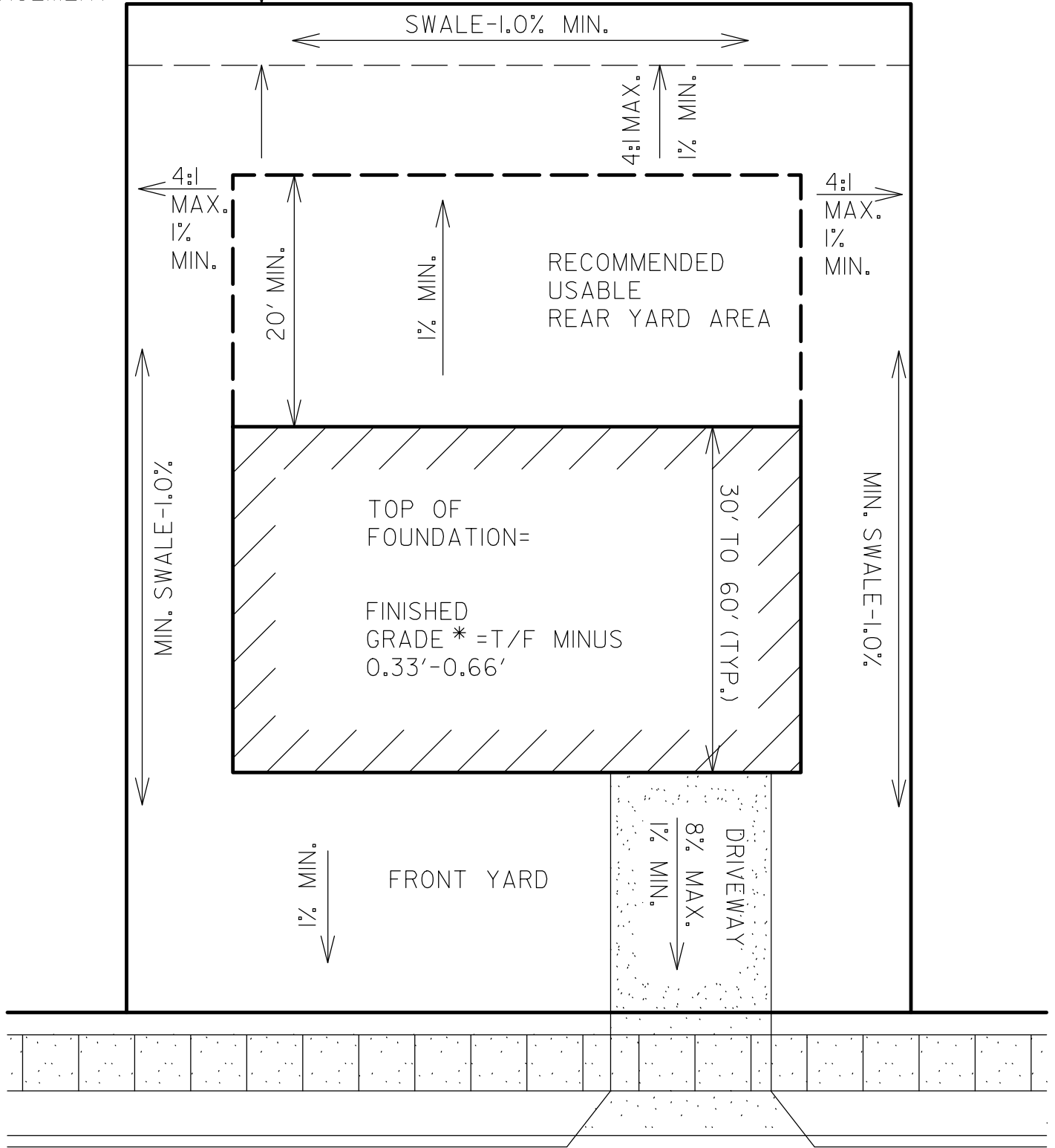

* IF THE BUILDING IS MULTI-LEVEL, SHOW PROPOSED TOP OF FOUNDATION AND FINISHED GRADE AT ALL LEVELS.

STREET

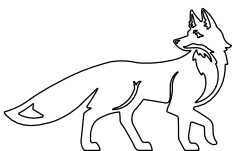

CITY OF ST. CHARLES
ILLINOIS • SINCE 1834
Pride of the Fox

LOT GRADING GUIDELINES

DATE: 5-12-2021

NOT TO SCALE

REVISED:

DRAWING NO. F-06