	HISTORIC PRESERVATION COMMISSION AGENDA ITEM EXECUTIVE SUMMARY			
	Agenda Item Title/Address:	COA: 203 N 4 <sup>th</sup> Ave.		
	Significance:	N/A		
	Petitioner:	Kristin Kotsakis		
	Project Type:	Porch Railing		
	PUBLIC HEARING		MEETING 8/18/20	X
Agenda Item Category:				
	Preliminary Review		Grant	
X	Certificate of Appropriateness (COA)		Other Commission Business	
	Landmark/District Designation		Commission Business	
Attached Documents:		Additional Requested Documents:		
Application, Railing Information, photos		None		
Project Description:				
<ul style="list-style-type: none"> <li>Proposed is to install black iron railings on the porch steps.</li> </ul>				
Staff Comments:				
Recommendation / Suggested Action:				
<ul style="list-style-type: none"> <li>Provide feedback and recommendation on approval of the COA</li> </ul>				

**APPLICATION FOR COA REVIEW**  
**HISTORIC PRESERVATION "CERTIFICATE OF APPROPRIATENESS"**



COMMUNITY & ECONOMIC DEVELOPMENT DEPARTMENT / CITY OF ST. CHARLES

(630) 377-4443

To be filled out by City Staff

Permit #: \_\_\_\_\_ Date Submitted: 8 / 11 / 2020 COA # \_\_\_\_\_ Admin. Approval: \_\_\_\_\_

**APPLICATION INFORMATION**

Address of Property: 203 N. 4th Avenue St. Charles

Use of Property: ☐ Commercial, business name: \_\_\_\_\_  
☒ Residential ☐ Other: \_\_\_\_\_

**Project Type:**

- |  |   |   |
|--|---|---|
| <input checked="" type="checkbox"/> Exterior Alteration/Repair | <input type="checkbox"/> New Construction   | <input type="checkbox"/> Demolition             |
| <input type="checkbox"/> Windows                               | <input type="checkbox"/> Primary Structure  | <input type="checkbox"/> Primary Structure      |
| <input type="checkbox"/> Doors                                 | <input type="checkbox"/> Additions          | <input type="checkbox"/> Garage/Outbuilding     |
| <input type="checkbox"/> Siding - Type: _____                  | <input type="checkbox"/> Deck/Porch         | <input type="checkbox"/> Other _____            |
| <input type="checkbox"/> Masonry Repair                        | <input type="checkbox"/> Garage/Outbuilding | <input type="checkbox"/> Relocation of Building |
| <input checked="" type="checkbox"/> Other _____                | <input type="checkbox"/> Other _____        |   |
| <input type="checkbox"/> Awnings/Signs                         |   |   |

**Description:**

Front porch railing

**Applicant Information:**

Name (print): Kristin Kotsakis  
Address: 203 N. 4th Avenue  
Phone: 630-602-2490  
Email: kmk1986@sbcglobal.net

Applicant is (check all that apply):

- ☒ Property Owner  
☐ Business Tenant  
☐ Project contractor  
☐ Architect/Designer

**Property Owner Information (if not the Applicant)**

Name (print): Same  
Address: \_\_\_\_\_  
Signature: \_\_\_\_\_

**APPLICANT/AUTHORIZED AGENT SIGNATURE**

I agree that all work shall be in accordance with the plans, specifications and conditions which accompany this application, and I have read and understand the Historic Preservation COA General Conditions.

Signature: Kristin Kotsakis Date: 07/29/20

**PEERLESS FENCE**

A Division of Peerless Enterprises, Inc.  
 33 W 401 Roosevelt Road \* West Chicago, IL 60185  
 (630) 584-7710 \* Fax (630) 584-7746

**PROPOSAL AND  
ACCEPTANCE**

Attn: Kristin

<b>Proposal submitted to: Kristin Kotsakis</b>		<b>Home Phone:</b>	<b>Date:</b> 5-6-20
<b>Street Address: 203 N. 4th Ave</b>		<b>Fax:</b>	<b>Cell Phone:</b> 630-602-2490
<b>City, State and Zip Code: St Charles, IL 60174</b>		<b>Project Name: Same</b>	
<b>Architect</b>	<b>Date of Plans</b>	<b>Project Location: Same</b>	

**IRON RAILING**

Product: EI Brand

Style: #109 with ALL straight pickets

Approximately 16.5lineal feet of 36" high custom ornamental iron railing to include:

1-3/4" Top rail/hand-rail

1" x 1/2" channel bottom rail

1/2" square solid pickets spaced 4" apart

1" square tube posts cored into steps

Primed and powder coated BLACK

**Total Price Installed: \$3,182.00****Deposit: \$1,591.00****Balance: \$1,591.00**

We propose hereby to furnish material and labor – complete in accordance with above specification.

Payment to be made as follows: Terms upon credit approval or 50% down and balance due upon completion.

**ALL PERMITS MUST BE OBTAINED BY OWNER.**

All material is guaranteed to be as specified. All work to be completed in a workmanlike manner, on a regular time basis according to standard practices. Any alteration or deviation from above specifications involving extra costs will be executed only upon written orders, and will become an extra charge over and above the estimate. All agreements contingent upon strikes, accidents or delays beyond our control. Owner to carry fire, tornado and other necessary insurance. Our workers are fully covered by Workman's Compensation Insurance.

Customer hereby assumes full responsibility for the location of the line upon which fence materials are to be installed and locate any and all private cable to include sprinkler systems, electric, septic fields, gas lines, grills, lighting, etc. Peerless Fence to Call J.U.L.I.E.

I, THE UNDERSIGNED, HEREBY AGREE THAT IN THE EVENT OF DEFAULT IN THE PAYMENT OF ANY AMOUNT DUE, AND IF THIS ACCOUNT IS PLACED IN THE HANDS OF AN AGENCY OR ATTORNEY FOR COLLECTION OR LEGAL ACTION, TO PAY AN ADDITIONAL CHARGE EQUAL TO THE COST OF COLLECTIONS INCLUDING AGENCY AND ATTORNEY FEES AND COURT COSTS INCURRED AND PERMITTED BY LAWS GOVERNING THESE TRANSACTIONS. ALL PAST DUE ACCOUNTS WILL BE CHARGED AT THE RATE OF 1.5% ON UNPAID MONTHLY BALANCE.

ACCEPTANCE OF PROPOSAL. The above prices, specifications and conditions are satisfactory and are hereby accepted. You are authorized to do the work as specified. Payment will be made as outlined above.

Date of Acceptance \_\_\_\_\_

Authorized Signature:

Tom Muckian

Tom Muckian, Project Manager

**PEERLESS FENCE**

Note: This proposal may be withdrawn by us if not accepted within 15 days.

Signature \_\_\_\_\_

Signature \_\_\_\_\_

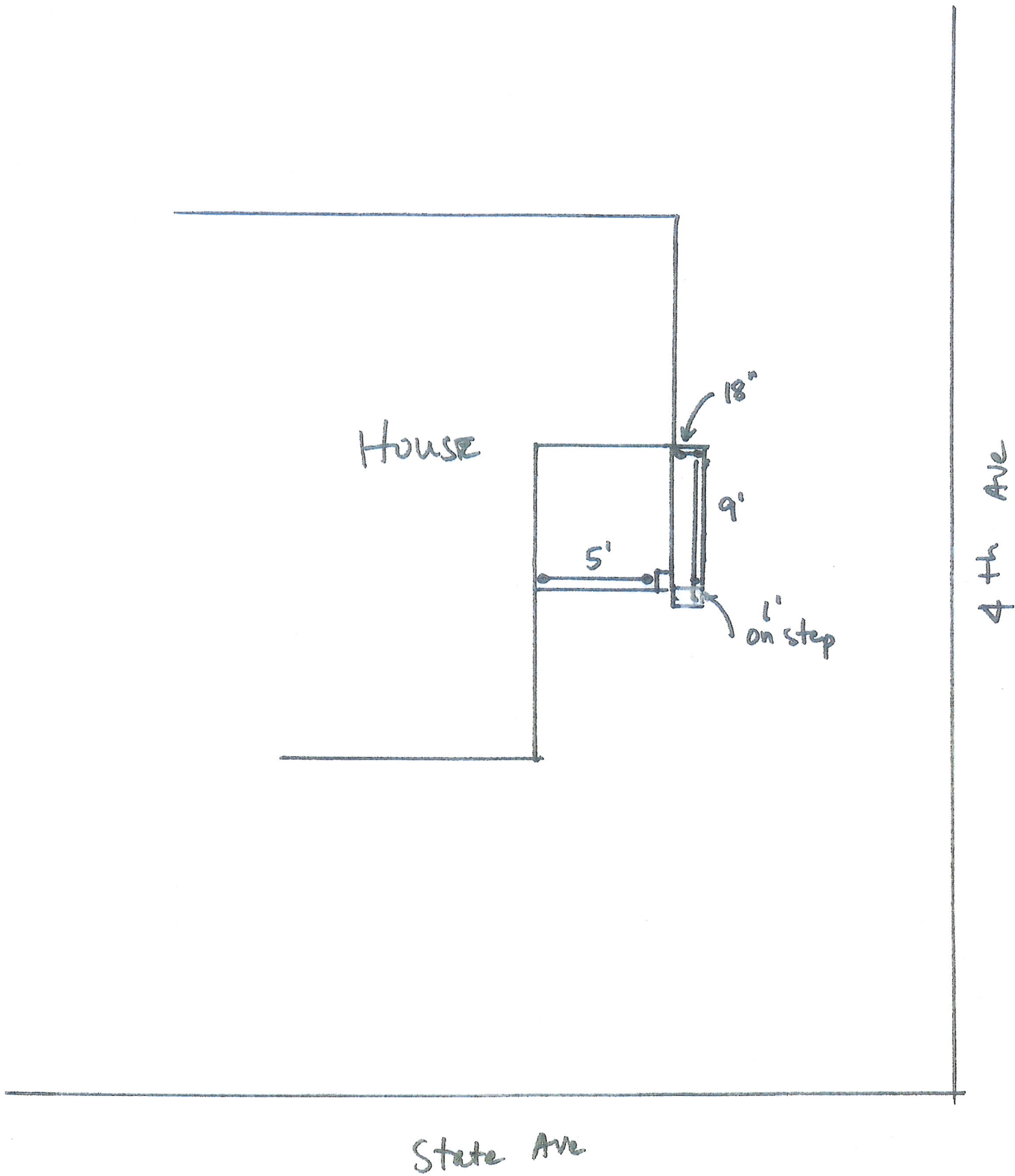



## Sample Railing









