	HISTORIC PRESERVATION COMMISSION AGENDA ITEM EXECUTIVE SUMMARY			
	Agenda Item Title/Address:	COA: 311 Park Ave.		
	Significance:	N/A		
	Petitioner:	David Kaknes		
	Project Type:	Fence		
	PUBLIC HEARING			MEETING 10/7/20
Agenda Item Category:				
	Preliminary Review		Grant	
X	Certificate of Appropriateness (COA)		Other Commission Business	
	Landmark/District Designation		Commission Business	
Attached Documents:			Additional Requested Documents:	
Application, fence details			None	
Project Description:				
<ul style="list-style-type: none"> Proposed is to install a 30ft long 6ft high Cedar fence along the interior lot line. 				
Staff Comments:				
Recommendation / Suggested Action:				
<ul style="list-style-type: none"> Provide feedback and recommendation on approval of the COA 				

APPLICATION FOR COA REVIEW
HISTORIC PRESERVATION "CERTIFICATE OF APPROPRIATENESS"



COMMUNITY & ECONOMIC DEVELOPMENT DEPARTMENT / CITY OF ST. CHARLES

(630) 377-4443

To be filled out by City Staff

Permit #: 2020-01914 Date Submitted: 10/5/2020 COA # - Admin. Approval:

APPLICATION INFORMATION

Address of Property: 311 Park Ave. St. Charles, IL

Use of Property: ☐ Commercial, business name:
☒ Residential ☐ Other:

Project Type:

- | | | |
|---|---|---|
| <input type="checkbox"/> Exterior Alteration/Repair
<input type="checkbox"/> Windows
<input type="checkbox"/> Doors
<input type="checkbox"/> Siding - Type: <u> </u>
<input type="checkbox"/> Masonry Repair
<input type="checkbox"/> Other <u> </u>
<input type="checkbox"/> Awnings/Signs | <input type="checkbox"/> New Construction
<input type="checkbox"/> Primary Structure
<input type="checkbox"/> Additions
<input type="checkbox"/> Deck/Porch
<input type="checkbox"/> Garage/Outbuilding
<input checked="" type="checkbox"/> Other <u>Fence</u> | <input type="checkbox"/> Demolition
<input type="checkbox"/> Primary Structure
<input type="checkbox"/> Garage/Outbuilding
<input type="checkbox"/> Other <u> </u>

<input type="checkbox"/> Relocation of Building |
|---|---|---|

Description:

Approx 30' linear feet of 6' High "Board on Board"
Cedar Fence

Applicant Information:

Name (print): DAVID KALKNES
Address: 311 PARK Ave, St.C.
Phone: 630-514-2262
Email: DAVEKALKNES@GMAIL.COM

Applicant is (check all that apply):

- ☒ Property Owner
☐ Business Tenant
☐ Project contractor
☐ Architect/Designer

Property Owner Information (if not the Applicant)

Name (print):
Address:
Signature:

APPLICANT/AUTHORIZED AGENT SIGNATURE

I agree that all work shall be in accordance with the plans, specifications and conditions which accompany this application, and I have read and understand the Historic Preservation COA General Conditions.

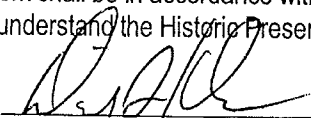
Signature:  Date: 10/5/2020

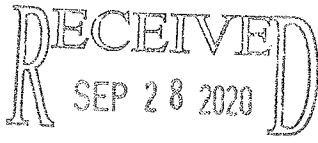

Building & Code Enforcement
St. Charles, IL

CITY OF ST CHARLES

Application for Building Permit for Fence

Historic



Building & Code Enforcement Division

Phone: (630) 377-4406

Application Date: _____ Parcel No. _____ Permit No. 202001914

PLEASE PRINT ALL INFORMATION

I, David Kaknes do hereby apply for a permit for the following described

work located at 311 Pack Ave St. Charles 60174.

Number of lineal feet: 30

Estimated Cost: 2000.00

Description of proposed fence (i.e. height, style): 30' x 6' H, Shadow-Box Cedar Fence

Check List for Submittal of Application:

- ☐ Is your property located in the Historic Preservation District? Yes/No If yes, your application and plans will need to be reviewed by the Historic Preservation Committee.
- ☐ Building Permit Application – Completely Filled Out.
- ☐ Three-3 Copies of Plat Of Survey – highlight location of proposed fence.
- ☐ Three-3 Copies of specifications from fence contractor.
- ☐ Fence Release and Indemnity Agreement – a fence located inside a Public Utility or Drainage Easement is required to have a notarized Release and Indemnity Agreement. Notaries are available at the Municipal Center.
- ☐ Submittal fee – to be paid at time of submitting the application.
 - o Fence- \$85.00 **In addition a recording fee may apply, see below.
 - o Recording Fee – \$52.00 (only if fence is located in an easement)
- ☐ PAYMENT IS TO BE BY CHECK PAYABLE TO THE CITY OF ST. CHARLES OR BY CASH.

Owner of the Property:

Name: David Kaknes
 Address: 311 Pack Ave
 City/State/Zip Code: St. Charles, IL 60174
 Telephone NO. 630-514-2262
 Email address: DAVEKAKNES@Gmail.com

Fence Contractor:

Name: Royal Fence
 Address: 348 Willis Street
 City/State/Zip Code: South Elgin, IL 60177
 Telephone NO. 847-531-5635
 Email address: _____

I, the undersigned, certify that if a permit is issued to me, I will comply with all provisions of the building, plumbing, electric and other applicable ordinances of the City of St. Charles and shall perform all work, or cause all work to be performed according to the provisions of said ordinances. I, or my agent, shall personally supervise the work and shall do, or cause to have done, said work according to plans, specifications and other written information supplied as a part of this application. I am familiar with the applicable ordinances and the provision thereof and in signing this application do willingly become responsible for all work accomplished under the permit by all contractors, tradesmen and workmen, and shall call for inspections as required at a minimum of 24-hours before they become due.

PRINT NAME: David Kaknes SIGNATURE: [Signature]

For Office Use Only REPORT OF THE BUILDING OFFICIAL

Remarks _____

Accepted _____ Rejected _____ Date _____ Receipt No. _____

Amount Paid at Submittal _____ Date Received: _____ Check No. _____

Signature(s) of Building Official(s) _____

Copies distributed to: Electric: _____ Development Engineering: _____ Historic Pres: _____

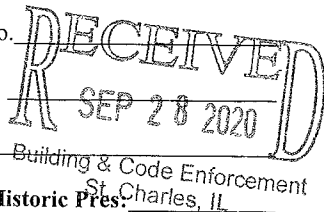

J.U.L.I.E. # 3708

CONTACT DATE JULIE READY

EXPIRATION DATE

COUNTY

SUBDIVISION TOWNSHIP

SALESPERSON: Ernesto SV. MOBILE: 847-980-2749

Please read the following terms and conditions:

1. Royal Fence is responsible for contacting J.U.L.I.E. and scheduling post hole inspection if required.
2. Customer is responsible for obtaining the following items:
 - a. Municipal Permits
 - b. Home Owners Association approvals
 - c. Scheduling final inspections if applicable
3. Customer is responsible for providing Royal Fence with a permit number, signed contract, plat of survey, and deposit as stated on the contract in order to schedule the fence project.

Warranties
3 years Labor
5 years Wood
Steel post 15 years

(36)

Paid 9-12-2020
Check # 9016

COMPLETE PRICE	DOWN PAYMENT	BALANCE	TERMS OF SALE
2,000.00	1,000.00	1,000.00	On Completion

to obtain at his cost. Royal Fence Inc. can only be responsible for the location of property lines where

the time this contract is executed. Initial _____ Royal Fence is not responsible UNDER ANY
any other buried lines or objects not professionally located by _____ or Digger including but

and I agree to pay the amount mentioned in said proposal. Payment will be made as outlined above.

royalty fees plus 2% per month on past due balance. This proposal may be withdrawn and voided if no CHANGES TO ORIGINAL CONTRACT OR ANY ADDITIONAL WORK

1 1 1 1 1

1/12/2020 Ernesto Acosta 9-12-2020

Date _____ Respectfully submitted by _____ Date _____

If any construction permit may be required, purchaser agrees to obtain at his cost. Royal Fence Inc. can only be responsible for the location of property lines when supplied with a current and accurate plat of survey at the time this contract is executed. Initial _____ Royal Fence is not responsible UNDER ANY CIRCUMSTANCES, for damages to private utilities and/or any other buried lines or objects not professionally located by J.U.L.I.E. or Digger, including but not limited to, sprinkler systems, drain tiles, private gas, private electric, pool equipment lines, invisible pet fence, landscape lighting, private water, septic system, etc. I hereby accept the terms and conditions on this contract and I agree to pay the amount mentioned in said proposal. Payment will be made as outlined above. Customer agrees to pay collection cost and reasonable attorney fees plus 2% per month on past due balance. This proposal may be withdrawn and voided if not accepted within 10 days. **CUSTOMER AGREES TO PAY FOR ALL CHANGES TO ORIGINAL CONTRACT OR ANY ADDITIONAL WORK.**

X [Signature] X 9/12/2020 Ernest Acosta 9-12-2020
Purchaser's Signature Date Respectfully submitted by Date

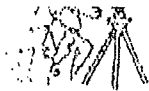

SCALE: 1" = 25.0'

Plat of Survey



OF PROPERTY DESCRIBED AS: THE NORTHERLY 50 FEET OF LOT 7, AND THE NORTHERLY 50 FEET OF LOT 8 (EXCEPT THE NORTHERLY 20 FEET THEREOF) AND LOT 2, ALL IN BLOCK 37 OF WARD'S ADDITION TO ST. CHARLES, IN THE CITY OF ST. CHARLES, KANE COUNTY, ILLINOIS.

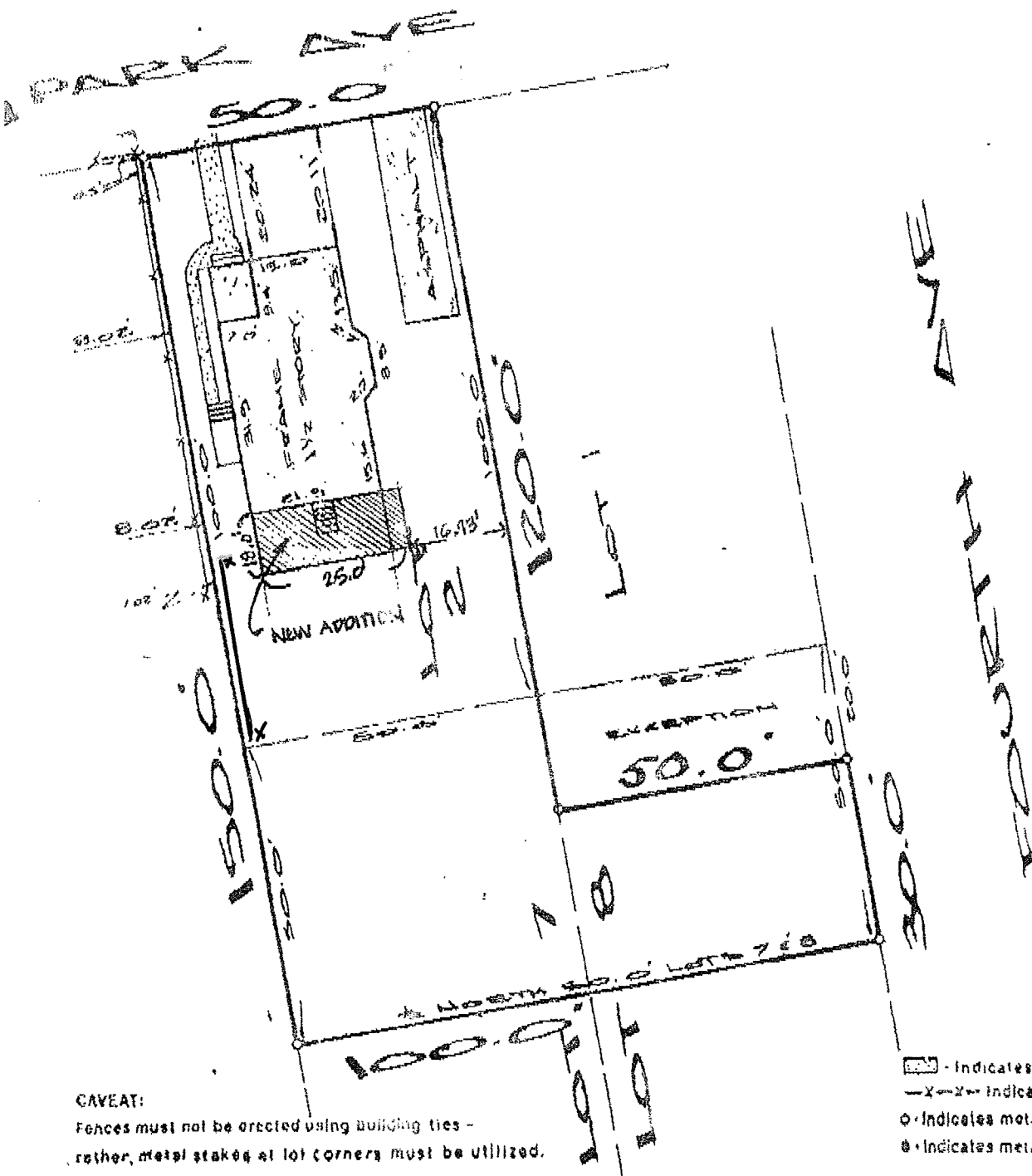

CAVEAT:

Fences must not be erected using building ties - rather, metal stakes at lot corners must be utilized.

PREPARED FOR, MR. KEN BLOOD, ATTORNEY

PROPERTY ADDRESS 311 PARK AVENUE

ST. CHARLES, ILLINOIS

STATE OF ILLINOIS) BUYER: KAKNES
COUNTY OF KANE) SS

We, Village Green Assoc., Inc., do hereby certify that the buildings on the lot shown are within the property lines and that the adjoining building improvements do not encroach on said lot, except if, and where, noted thusly. *

DATED: SEPTEMBER 3, 1952 A.D.

STATE OF ILLINOIS)
COUNTY OF KANE) SS

We, Village Green Assoc., Inc., do hereby certify that we have surveyed the above described property according to the official record, and that the above plat correctly represents said survey.

James T. Stowell
JAMES T. STOWELL R.L.S. NO. 1952



Village Green Assoc., Inc.