

		HISTORIC PRESERVATION COMMISSION AGENDA ITEM EXECUTIVE SUMMARY			
		Agenda Item Title/Address:		COA: 118 N 4 th Ave.	
		Proposal:		Stairs	
		Petitioner:		Karla Goldie	
		Please check appropriate box (x)			
		PUBLIC HEARING		MEETING 4/17/19	X
AGENDA ITEM CATEGORY:					
<input checked="" type="checkbox"/>	Certificate of Appropriateness (COA)			Façade Improvement Plan	
	Preliminary Review			Landmark/District Designation	
	Discussion Item			Commission Business	
ATTACHMENTS:					
COA Application					
Architectural Survey					
Design Drawings					
Photo of existing stairs					
EXECUTIVE SUMMARY:					
<p>Proposed is to replace the side staircase at 118 N 4th Ave, with a new one in the same material and style. The proposed second floor landing will be slightly larger to conform to building codes.</p> <p>The wood will be treated/ AC2 and the spindles and railings will replicate what is there now.</p>					
RECOMMENDATION / SUGGESTED ACTION:					
Provide feedback and recommendations on approval of the COA.					

APPLICATION FOR COA REVIEW
HISTORIC PRESERVATION "CERTIFICATE OF APPROPRIATENESS"



COMMUNITY & ECONOMIC DEVELOPMENT DEPARTMENT / CITY OF ST. CHARLES

(630) 377-4443

To be filled out by City Staff

Permit #: _____ Date Submitted: 4 / 11 / 19 COA # _____ Admin. Approval: _____

APPLICATION INFORMATION

Address of Property: 118 N 4th Ave

Use of Property: ☐ Commercial, business name: _____
☒ Residential ☐ Other: _____

Project Type:

- | | | |
|---|---|---|
| <input checked="" type="checkbox"/> Exterior Alteration/Repair
<input type="checkbox"/> Windows
<input type="checkbox"/> Doors
<input type="checkbox"/> Siding - Type: _____
<input type="checkbox"/> Masonry Repair
<input checked="" type="checkbox"/> Other <u>2nd floor stairs</u>
<input type="checkbox"/> Awnings/Signs | <input type="checkbox"/> New Construction
<input type="checkbox"/> Primary Structure
<input type="checkbox"/> Additions
<input type="checkbox"/> Deck/Porch
<input type="checkbox"/> Garage/Outbuilding
<input type="checkbox"/> Other _____ | <input type="checkbox"/> Demolition
<input type="checkbox"/> Primary Structure
<input type="checkbox"/> Garage/Outbuilding
<input type="checkbox"/> Other _____

<input type="checkbox"/> Relocation of Building |
|---|---|---|

Description:

remove decrepit wood stairs to 2nd unit
and replace with new wood stairs (all outside)

Applicant Information:

Name (print): Karla Goldie
Address: 1541 110th St, M.P., WI 53158
Phone: 630-940-5344
Email: Kgoldie08@gmail.com

Applicant is (check all that apply):

- ☒ Property Owner
☐ Business Tenant
☐ Project contractor
☐ Architect/Designer

Property Owner Information (if not the Applicant)

Name (print): Karla Goldie
Address: _____
Signature: Karla Goldie

APPLICANT/AUTHORIZED AGENT SIGNATURE

I agree that all work shall be in accordance with the plans, specifications and conditions which accompany this application, and I have read and understand the Historic Preservation COA General Conditions.

Signature: Karla Goldie Date: 4/11/19



ARCHITECTURAL SURVEY

CENTRAL HISTORIC DISTRICT

ST. CHARLES, ILLINOIS

ST. CHARLES HISTORIC PRESERVATION COMMISSION

Primary Structure

ADDRESS 118-118 1/2 N 4th Ave

1994 Photo

Roll: 14

Negative: 14, 12, 13

Photo: Aug. 2003



ARCHITECTURAL SIGNIFICANCE

- ☐ Significant
- ☒ Contributing
- ☐ Non-Contributing
- ☐ Potential for Individual National Register Designation

BUILDING CONDITION

- ☒ Excellent
- ☐ Good
- ☐ Fair
- ☐ Poor

ARCHITECTURAL INFORMATION

Architectural Style/Type: Prairie/American Foursquare

Exterior Walls (Current): _____

Architectural Features: _____

Exterior Walls (Original): _____

Date of Construction: 1935

Foundation: _____

Source: _____

Roof Type/Material: _____

Overall Plan Configuration: _____

Window Material/Type: _____

ARCHITECTURAL FEATURES: Two-story wood frame structure with low pitched roof and widely overhanging eaves. One story porch at south elevation. Inappropriate gable roof over entry door.

ALTERATIONS: Minor alteration to first floor.

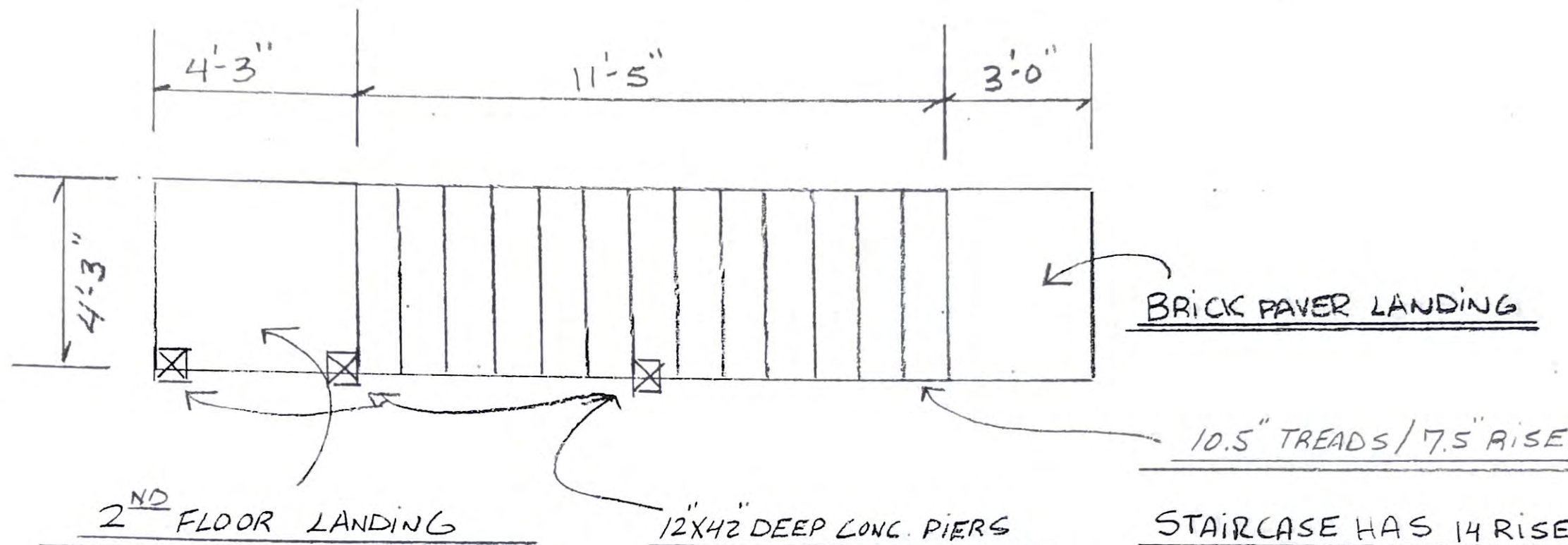

RAILINGS 37" TALL / 4" O.C. SPINDLES

HAND RAILS 34" TO 38" TALL
ATTACHED TO HOUSE WALL

SCALE = 1/4" = 1'-0"

OWNER: KARLA GOLDIE
DATE: 4-11-2019
ADDRESS: 118 N 4th AVE.
STAIRCASE WORK



Google