 <p>CITY OF ST. CHARLES ILLINOIS • 1834</p>	HISTORIC PRESERVATION COMMISSION AGENDA ITEM EXECUTIVE SUMMARY			
	Agenda Item Title/Address:	COA: 203 N 4 th Ave.		
	Significance:	N/A		
	Petitioner:	Kristin Kotsakis		
	Project Type:	Deck		
PUBLIC HEARING			MEETING 10/6/21	X
Agenda Item Category:				
	Preliminary Review		Grant	
X	Certificate of Appropriateness (COA)		Other Commission Business	
	Landmark/District Designation		Commission Business	
Attached Documents:			Additional Requested Documents:	
Application, deck information, photos				
Project Description:				
<ul style="list-style-type: none"> Proposed is to install a 19' x15' trek deck on the back of the house. 				
Staff Comments:				
Recommendation / Suggested Action:				
<ul style="list-style-type: none"> Provide feedback and recommendation on approval of the COA 				

APPLICATION FOR COA REVIEW
HISTORIC PRESERVATION "CERTIFICATE OF APPROPRIATENESS"



COMMUNITY & ECONOMIC DEVELOPMENT DEPARTMENT / CITY OF ST. CHARLES

(630) 377-4443

To be filled out by City Staff

Permit #: 2021 - 01890 Date Submitted: 9/14/21 COA # _____ - _____ Admin. Approval: _____

APPLICATION INFORMATION

Address of Property: 203 N. 4th Avenue

Use of Property: Commercial, business name: _____
 Residential Other: _____



Project Type:

- | | | |
|---|--|---|
| <input type="checkbox"/> Exterior Alteration/Repair | <input type="checkbox"/> New Construction | <input type="checkbox"/> Demolition |
| <input type="checkbox"/> Windows | <input type="checkbox"/> Primary Structure | <input type="checkbox"/> Primary Structure |
| <input type="checkbox"/> Doors | <input type="checkbox"/> Additions | <input type="checkbox"/> Garage/Outbuilding |
| <input type="checkbox"/> Siding - Type: _____ | <input checked="" type="checkbox"/> Deck/Porch | <input type="checkbox"/> Other _____ |
| <input type="checkbox"/> Masonry Repair | <input type="checkbox"/> Garage/Outbuilding | <input type="checkbox"/> Relocation of Building |
| <input type="checkbox"/> Other _____ | <input type="checkbox"/> Other _____ | |
| <input type="checkbox"/> Awnings/Signs | | |

Description:

Trex deck

Applicant Information:

Name (print): Kristin Kotsakis
Address: 203 N. 4th Avenue
Phone: 630-602-2490
Email: kmk1986@sbcglobal.net

Applicant is (check all that apply):

- Property Owner
- Business Tenant
- Project contractor
- Architect/Designer

Property Owner Information (if not the Applicant)

Name (print): _____
Address: _____
Signature: _____

APPLICANT/AUTHORIZED AGENT SIGNATURE

I agree that all work shall be in accordance with the plans, specifications and conditions which accompany this application, and I have read and understand the Historic Preservation COA General Conditions.

Signature: Kristin M. Kotsakis Date: 09/14/2021

PLAT OF SURVEY

DALE FLOYD LAND SURVEYING

2600 Keelinger Road, Suite 15
Geneva, Illinois 60134

Phone: (630) 232-7705 Fax: (630) 232-7726

LOT 7 AND 8 IN BLOCK 28 OF THE ORIGINAL TOWN OF ST. CHARLES NOW THE CITY OF ST. CHARLES,
KANE COUNTY, ILLINOIS.
COMMONLY KNOWN AS: 203 NORTH FOURTH AVENUE, ST. CHARLES, ILLINOIS.



Scale: 1" = 20'

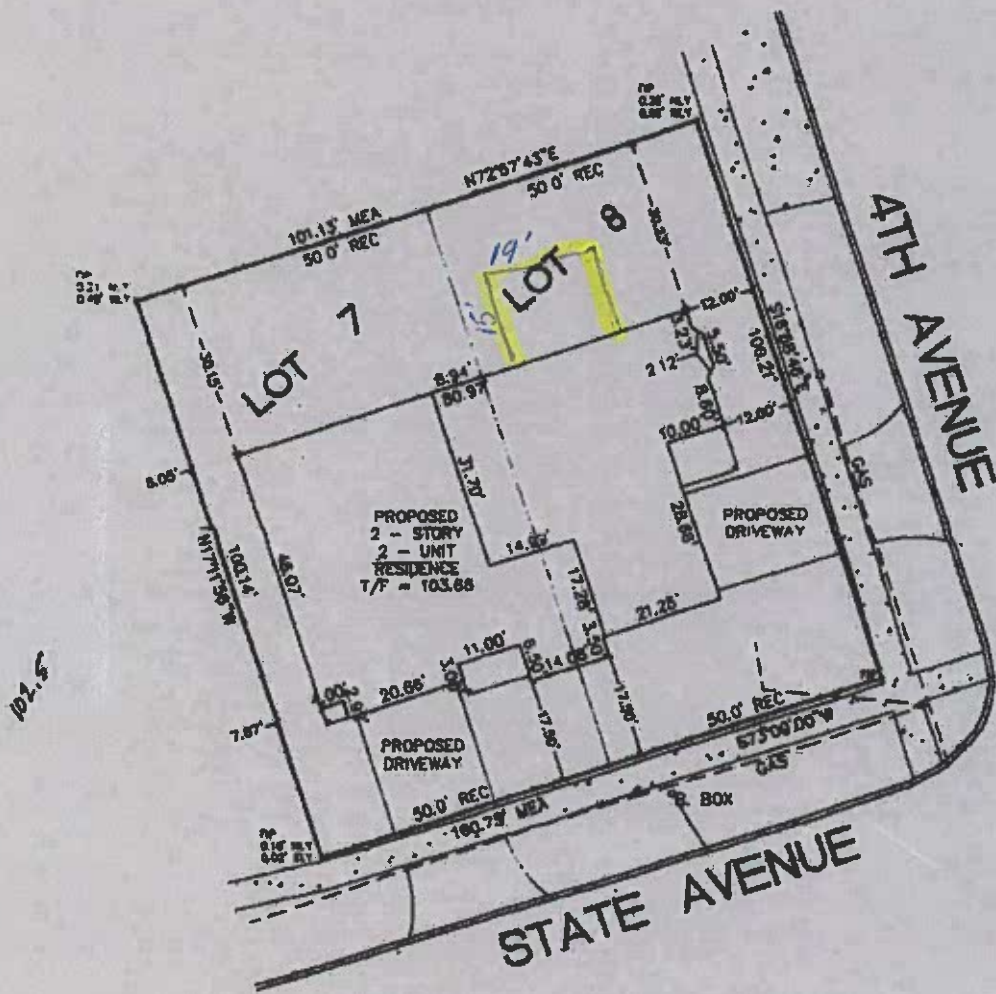

NOTE: This professional service conforms to the current Illinois minimum standards for a boundary survey.

Compare all points before building by same and at once report any difference

Structure located and initial survey completed 8-10-2002

Dale A. Floyd
Illinois Professional Land Surveyor No. 035-002876
Job No. 00102-14 License expiration date 11-30-04



State of Illinois 88
County of Kane

I, DALE A. FLOYD, do hereby certify that the above described property has been surveyed under my supervision, in the manner represented on the plat hereon drawn.
Dimensions are shown in feet and decimal parts thereof.

Geneva, Illinois 9-22 A.D. 2003

Dale A. Floyd
Illinois Professional Land Surveyor No. 035-002876

577 313 PM





KRISTIN KOTSAKIS
203 N 4TH STREET
ST. CHARLES, IL 60174

PROJECT: TREX TRANSCEND DECK

- REMOVE ENTIRE CONCRETE PATIO
- INSTALL NEW PRESSURE TREATED STRUCTURE
- INSTALL TREX TRANSCEND DECK BOARDS. COLOR SPICED RUM WITH PICTURE FRAME BORDER
- INSTALL TREX FASCIA TO MATCH
- INSTALL TREX SKIRT SYSTEM (VERTICAL DECK BOARDS)
- INSTALL TREX TRANSCEND RAILING SYSTEM COLOR VINTAGE LANTERN
 - FLAT LED POST CAPS
 - BLACK ROUND ALUMINUM BALUSTERS
- INSTALL TREX HIDDEN FASCENERS
- INSTALL 6 RISER LIGHTS
- 30 AMP TREX TRANSFORMER AND ALL TREX WIRING AND SPLITTERS
- MATCHING DECK AND FASCIA COMPOSITE SCREWS WHERE APPLICABLE
- PROCURE DRAWINGS PER CITY CODE
- PROCURE PERMIT
 - CUSTOMER TO PROVIDE PLAT OF SURVEY FOR PERMIT
- REMOVE AND HAUL-AWAY EXISTING DECK
- SEE DRAWING FOR SPECS



Photo © 2018 Scripps Networks, LLC.
Used with permission; all rights reserved.

TrexSignature® RAILING

Effortless style,
exceptional strength.



TrexTranscend® RAILING

Quick-and-easy customization.



TrexSelect® RAILING

The simple choice for your backyard.



Trex[®] Fascia

BEAUTY FROM EVERY ANGLE

With Trex[®] Fascia, your outdoor space stands out, side on. Engineered to retain its rich color just as long as your deck surface, our fascia adds wonderful depth and dimension to your design.

GIVE YOUR DECK AN EDGE

Try Universal White Fascia for a crisp, clean finish.

... More edging ideas at trex.com/fascia

AVAILABLE IN ALL DECKING COLORS:



Universal
White Fascia

Trex Transcend®

TROPICALS

ELEVATED AESTHETICS PAIRED WITH
THE HIGHEST LEVEL OF PERFORMANCE

Big, bold notions of outdoor living come to life with Trex Transcend® Tropicals. Our premium line combines second-to-none performance and hassle-free maintenance with the beauty of exotic teak and ipe. The result? Naturally streaked hues that make a vibrant statement.

A luxurious look that lasts



Rich, multi-tonal colors

BOARD PROFILES

Square edge



Grooved edge



Curveable boards for endless design possibilities

Use Trex Hideaway® Hidden Fastening System for a clean, fastener-free appearance

To Blend & Match w/brick



AVAILABLE COLORS:



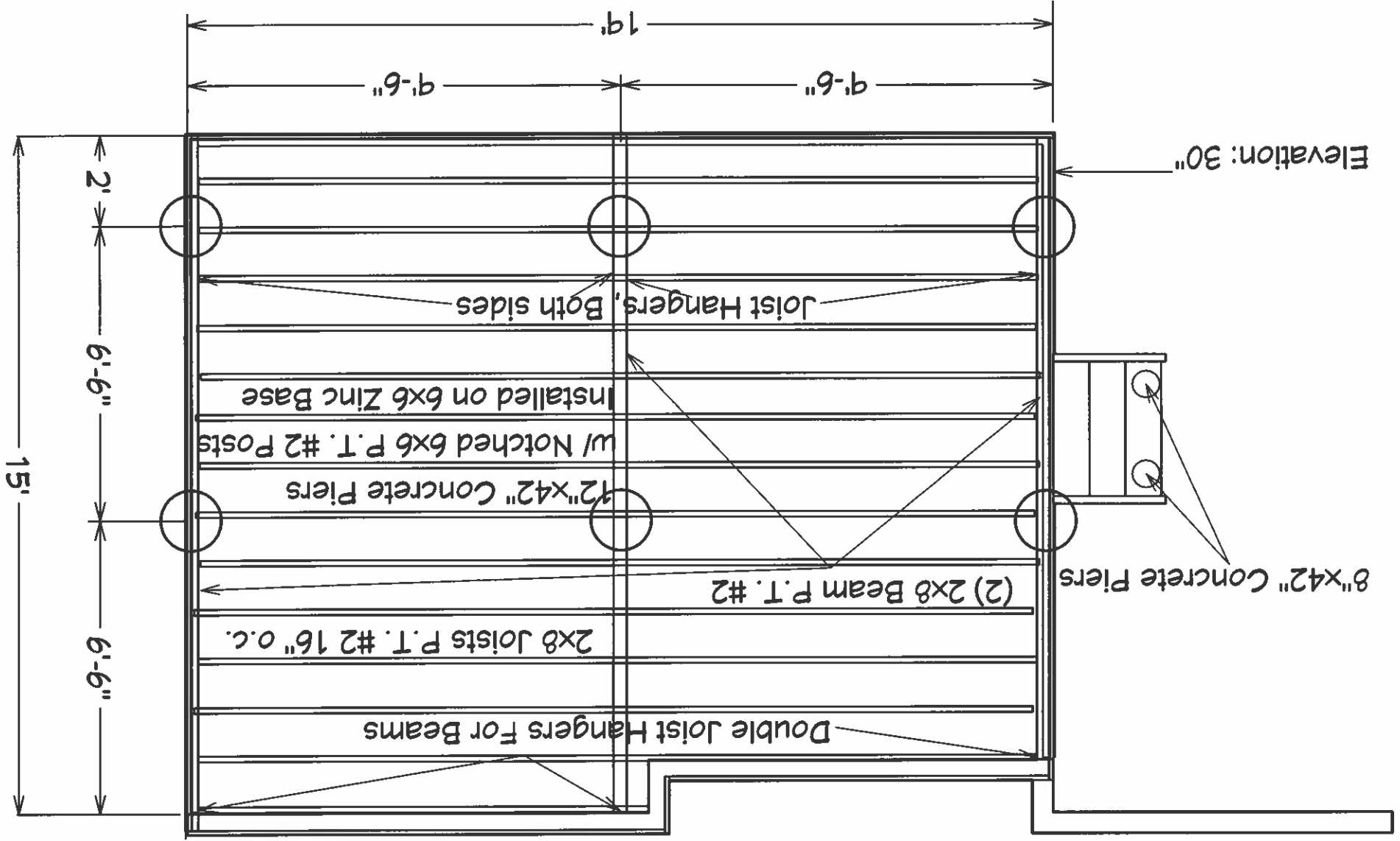

Typical Stair Detail

(See railing, ledger, support and footing detail sheets for additional construction information)

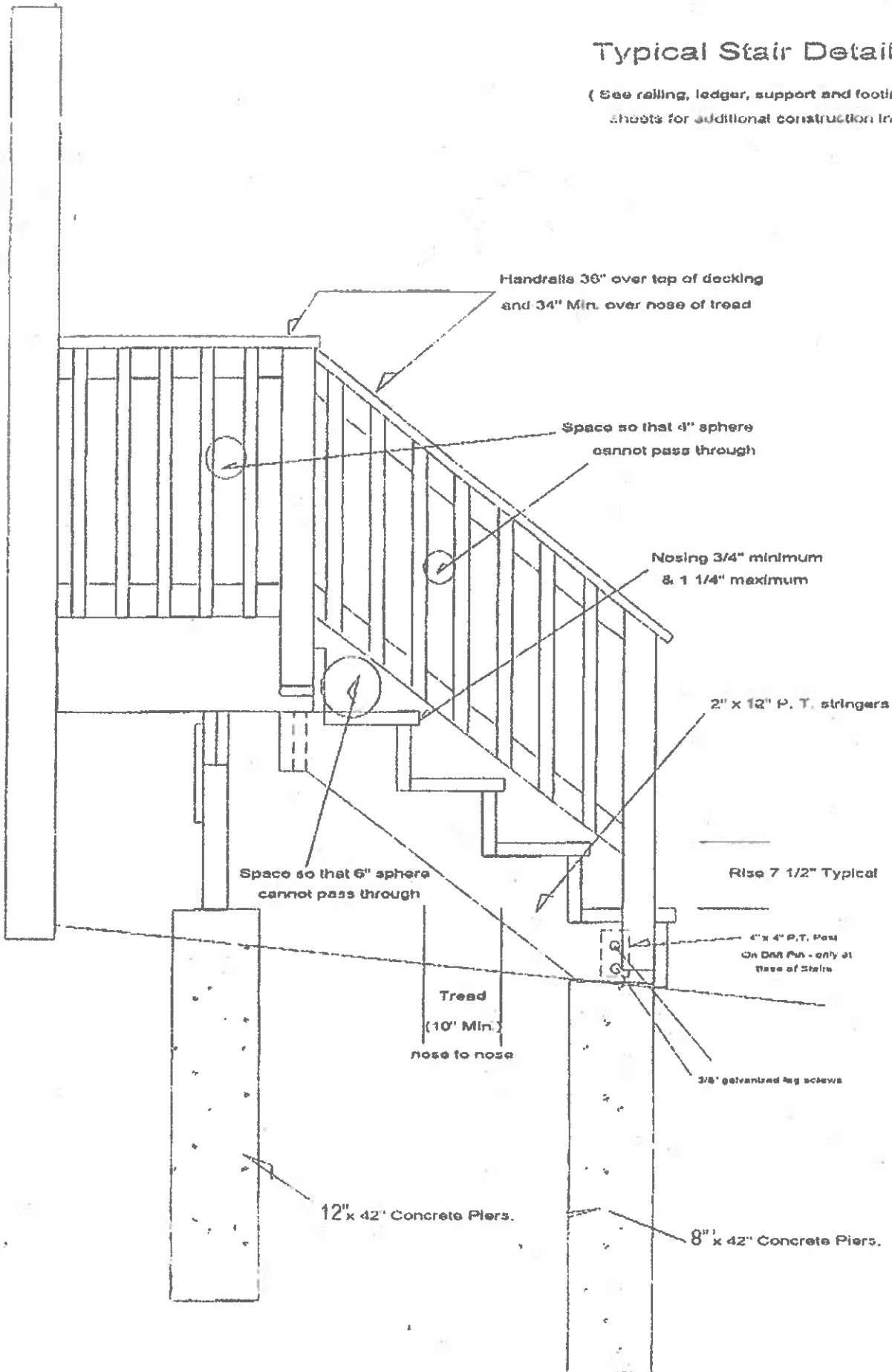

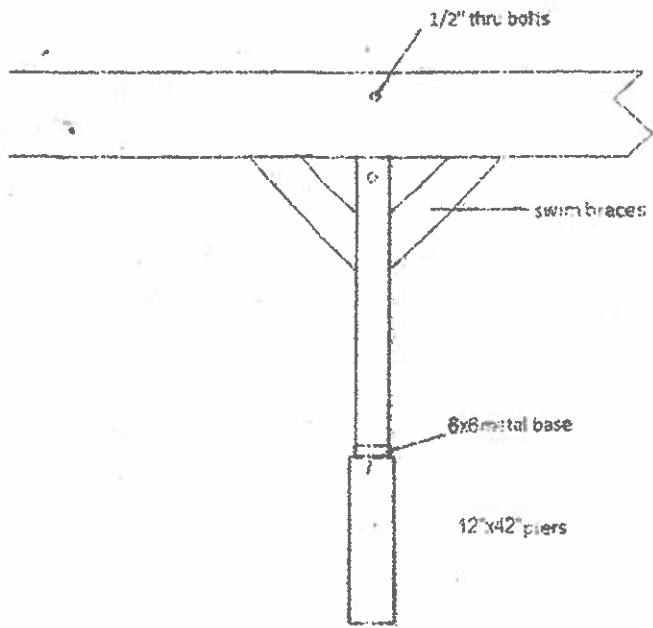

Figure 6: Joist-to-Beam Detail

