

**AGENDA
CITY OF ST. CHARLES
GOVERNMENT OPERATIONS COMMITTEE
ALD. DAN STELLATO, CHAIR**

**MONDAY, NOVEMBER 7, 2016
IMMEDIATELY FOLLOWING THE CITY COUNCIL MEETING
CITY COUNCIL CHAMBERS – 2 EAST MAIN STREET**

- 1. Call to Order**
- 2. Roll Call**
- 3. Omnibus Vote**
 - a. Budget Revisions – October 2016
- 4. Administrative**
 - a. Video Gaming Statistics – Information Only
- 5. Finance Department**
 - a. Recommendation to accept the Comprehensive Annual Financial Report, Independent Auditor’s Report Pursuant to Uniform Guidance, and Management Letter for the fiscal year ended April 30, 2016.
 - b. Recommendation to Authorize the Finance Director to Execute the Risk Insurance Program Renewal for the Year Beginning December 1, 2016.
- 6. Inventory Control Division**
 - a. Recommendation to approve a Resolution Authorizing the Mayor and the City Clerk of the City of St. Charles to Approve the Award of a 2017 Ford F550 XL 4X2 Chassis Cab, and Monroe Truck Equipment Body Modifications, to Zimmerman Ford and Sell Replaced 2003 Ford F-550-4X2 Vehicle #1730.
 - b. Recommendation to approve an Ordinance Authorizing the Sale of Items of Personal Property Owned by the City of St. Charles.
 - c. Recommendation to approve a Resolution Authorizing the Mayor and the City Clerk of the City of St. Charles to Approve the Award of an International Chassis Cab, with Monroe Truck Equipment Body Modifications, to Rush Truck Centers and Sell Replaced 2006 IHC 4300 Vehicle #1701.
 - d. Recommendation to approve a Resolution Authorizing the Mayor and the City Clerk of the City of St. Charles to Approve the Award of a 2017 Ford E350 Cutaway Van Chassis, with Knapheide KUV Body to Zimmerman Ford and Sell Replaced 2003 Ford E-350 SD Van Vehicle #1802.
- 7. Executive Session**
 - Personnel –5 ILCS 120/2(c)(1)
 - Pending Litigation – 5 ILCS 120/2(c)(11)
 - Probable or Imminent Litigation – 5 ILCS 120/2(c)(11)

- Property Acquisition – 5 ILCS 120/2(c)(5)
- Collective Bargaining – 5 ILCS 120/2(c)(2)
- Review of Executive Session Minutes – 5 ILCS 120/2(c)(21)

8. Additional Items from Mayor, Council, Staff, or Citizens.

9. Adjournment

ADA Compliance

Any individual with a disability requesting a reasonable accommodation in order to participate in a public meeting should contact the ADA Coordinator, Jennifer McMahon, at least 48 hours in advance of the scheduled meeting. The ADA Coordinator can be reached in person at 2 East Main Street, St. Charles, IL, via telephone at (630) 377 4446 or 800 526 0844 (TDD), or via e-mail at jmcmahon@stcharlesil.gov. Every effort will be made to allow for meeting participation. Notices of this meeting were posted consistent with the requirements of 5 ILCS 120/1 et seq. (Open Meetings Act).

CITY OF ST. CHARLES
Budget Revision Listing

October 2016

JE TYPE	JE #	BUDGET #	COMPANY	FISCAL YEAR	PERIOD	DATE	ACCT-UNIT	ACCOUNT	AMOUNT	DESCRIPTION
Budget Transfer	83	100	1000	2017	6	10/05/2016	513511	56170	73,000.00	Active River Concept Study
Budget Transfer	83	100	1000	2017	6	10/05/2016	513511	56200	(73,000.00)	Active River Concept Study
83 Total										
-										
Budget Addition	84	100	1000	2017	6	10/05/2016	513511	56170	40,000.00	Active River Concept Study
Budget Addition	84	100	1000	2017	6	10/05/2016	513999	48700	(40,000.00)	Active River Concept Study
84 Total										
-										
Roll Forward of Budget for Enc	86	100	1000	2017	6	10/06/2016	507663	54189	7,046.00	R/F 1st St Draw #8-PO#85388
Roll Forward of Budget for Enc	86	100	1000	2017	6	10/06/2016	507663	54189	15,254.00	R/F 1st St Draw #9-PO#85388
Roll Forward of Budget for Enc	86	100	1000	2017	6	10/06/2016	507663	54189	1,935.00	R/F Pymt Walker PO #86722
Roll Forward of Budget for Enc	86	100	1000	2017	6	10/06/2016	507663	54189	23,394.00	R/F Remainder 1st St PO #85388
Roll Forward of Budget for Enc	86	100	1000	2017	6	10/06/2016	507663	54189	4,305.00	R/F Remainder Walker PO #86722
Roll Forward of Budget for Enc	86	100	1000	2017	6	10/06/2016	507663	56200	139,541.00	R/F 1st St Draw #8-PO#85388
Roll Forward of Budget for Enc	86	100	1000	2017	6	10/06/2016	507663	56200	304,464.00	R/F 1st St Draw #9-PO#85388
Roll Forward of Budget for Enc	86	100	1000	2017	6	10/06/2016	507663	56200	22,349.00	R/F 1st St PO #85388-PermitFee
Roll Forward of Budget for Enc	86	100	1000	2017	6	10/06/2016	507663	56200	76,117.00	R/F Remainder 1st St PO #85388
Roll Forward of Budget for Enc	86	100	1000	2017	6	10/06/2016	507663	56200	431,521.00	R/F Remainder 1st St PO #85388
Roll Forward of Budget for Enc	86	100	1000	2017	6	10/06/2016	507900	31198	(1,025,926.00)	R/F 1st St Related PO's
86 Total										
-										
Budget Transfer	87	100	1000	2017	6	10/07/2016	507663	56101	(10,000.00)	From Sidewalk; To Streetscape
Budget Transfer	87	100	1000	2017	6	10/07/2016	507663	56101	10,000.00	For Streetscape; From Sidewalk
87 Total										
-										
Budget Transfer	85	100	1000	2017	6	10/06/2016	100200	54256	43,000.00	UB Support Contr-CCAppr10.3.16
Budget Transfer	85	100	1000	2017	6	10/06/2016	100200	50101	(43,000.00)	UB Support Contr-CCAppr10.3.16
Budget Transfer	85	100	1000	2017	6	10/06/2016	100200	54256	44,000.00	Temp HD & UB Supp Contract
Budget Transfer	85	100	1000	2017	6	10/06/2016	100200	50100	(44,000.00)	Temp HD & UB Supp Contract
Budget Transfer	85	100	1000	2017	6	10/06/2016	800223	51300	300.00	For UST cert training-IC
Budget Transfer	85	100	1000	2017	6	10/06/2016	800223	52310	(300.00)	For UST cert training-IC
Budget Transfer	85	100	1000	2017	6	10/06/2016	100210	52311	25.00	For inventory stocked item
Budget Transfer	85	100	1000	2017	6	10/06/2016	100210	52305	(25.00)	For inventory stocked item
Budget Transfer	85	100	1000	2017	6	10/06/2016	100221	52001	84.00	For books for Purchasing
Budget Transfer	85	100	1000	2017	6	10/06/2016	100221	52000	(84.00)	For books for Purchasing
Budget Transfer	85	100	1000	2017	6	10/06/2016	100402	55400	12.00	For inventory carrying charge
Budget Transfer	85	100	1000	2017	6	10/06/2016	100402	54000	(12.00)	For inventory carrying charge
Budget Transfer	85	100	1000	2017	6	10/06/2016	100510	52301	30.00	For HVAC Supplies
Budget Transfer	85	100	1000	2017	6	10/06/2016	100510	52304	(30.00)	For HVAC Supplies
Budget Transfer	85	100	1000	2017	6	10/06/2016	100510	52401	900.00	For vehicle fluids
Budget Transfer	85	100	1000	2017	6	10/06/2016	100510	52400	(900.00)	For vehicle fluids
Budget Transfer	85	100	1000	2017	6	10/06/2016	100510	52402	200.00	For motor vehicle parts
Budget Transfer	85	100	1000	2017	6	10/06/2016	100510	52700	(200.00)	For motor vehicle parts
Budget Transfer	85	100	1000	2017	6	10/06/2016	220550	51400	100.00	For transportation expense
Budget Transfer	85	100	1000	2017	6	10/06/2016	220550	54120	(100.00)	For transportation expense
Budget Transfer	85	100	1000	2017	6	10/06/2016	220551	52300	500.00	For janitorial supplies

CITY OF ST. CHARLES
Budget Revision Listing

October 2016

JE TYPE	JE #	BUDGET #	COMPANY	FISCAL YEAR	PERIOD	DATE	ACCT-UNIT	ACCOUNT	AMOUNT	DESCRIPTION
Budget Transfer	85	100	1000	2017	6	10/06/2016	220551	52304	(500.00)	For janitorial supplies
Budget Transfer	85	100	1000	2017	6	10/06/2016	801512	52304	900.00	For chemicals & sprays
Budget Transfer	85	100	1000	2017	6	10/06/2016	801512	52402	(900.00)	For chemicals & sprays
Budget Transfer	85	100	1000	2017	6	10/06/2016	801512	52305	300.00	For safety supplies
Budget Transfer	85	100	1000	2017	6	10/06/2016	801512	52402	(300.00)	For safety supplies
Budget Transfer	85	100	1000	2017	6	10/06/2016	801512	52310	900.00	For small tools & equipment
Budget Transfer	85	100	1000	2017	6	10/06/2016	801512	52402	(900.00)	For small tools & equipment
Budget Transfer	85	100	1000	2017	6	10/06/2016	804530	52311	100.00	For hardware supplies
Budget Transfer	85	100	1000	2017	6	10/06/2016	804530	52319	(100.00)	For hardware supplies
Budget Transfer	85	100	1000	2017	6	10/06/2016	804530	55401	500.00	For inventory overhead
Budget Transfer	85	100	1000	2017	6	10/06/2016	804530	54467	(500.00)	For inventory overhead
85 Total										-
Roll Forward Budget for Non PO	88	100	1000	2017	6	10/11/2016	210541	56209	44,500.00	For Well #8 VFD's; WA2033
Roll Forward Budget for Non PO	88	100	1000	2017	6	10/11/2016	210900	31197	(44,500.00)	For Well #8 VFD's; WA2033
88 Total										-
Roll Forward Budget for Non PO	89	100	1000	2017	6	10/11/2016	210541	56209	32,000.00	Convert 13 to Hypo:WA2021
Roll Forward Budget for Non PO	89	100	1000	2017	6	10/11/2016	210541	59999	(32,000.00)	Convert 13 to Hypo:WA2021
89 Total										-
Budget Transfer	90	100	1000	2017	6	10/13/2016	220550	51400	120.00	Mike B Reimbursement-Conferenc
Budget Transfer	90	100	1000	2017	6	10/13/2016	220550	51304	(120.00)	Mike B Reimbursement-Conferenc
Budget Transfer	90	100	1000	2017	6	10/13/2016	220550	51401	800.00	Mike B Reimbursement-Conferenc
Budget Transfer	90	100	1000	2017	6	10/13/2016	220550	51304	(800.00)	Mike B Reimbursement-Conferenc
90 Total										-
Budget Addition	91	100	1000	2017	5	10/13/2016	513500	55320	29,933.00	2016A Bond Issuance Costs
Budget Addition	91	100	1000	2017	5	10/13/2016	513500	54110	17,996.00	2016A Bond Issuance Costs
Budget Addition	91	100	1000	2017	5	10/13/2016	513500	55321	2,579.00	2016A Bond Issuance Costs
Budget Addition	91	100	1000	2017	5	10/13/2016	513900	31199	(50,508.00)	2016A Bond Issuance Costs
Budget Addition	91	100	1000	2017	5	10/13/2016	200520	55320	21,063.00	2016A Bond Issuance Costs
Budget Addition	91	100	1000	2017	5	10/13/2016	200520	54110	12,664.00	2016A Bond Issuance Costs
Budget Addition	91	100	1000	2017	5	10/13/2016	200520	55321	1,814.00	2016A Bond Issuance Costs
Budget Addition	91	100	1000	2017	5	10/13/2016	200900	31199	(35,541.00)	2016A Bond Issuance Costs
Budget Addition	91	100	1000	2017	5	10/13/2016	210540	55320	4,434.00	2016A Bond Issuance Costs
Budget Addition	91	100	1000	2017	5	10/13/2016	210540	54110	2,666.00	2016A Bond Issuance Costs
Budget Addition	91	100	1000	2017	5	10/13/2016	200520	55321	382.00	2016A Bond Issuance Costs
Budget Addition	91	100	1000	2017	5	10/13/2016	200900	31199	(7,482.00)	2016A Bond Issuance Costs
Budget Addition	91	100	1000	2017	5	10/13/2016	513999	48400	(489,102.00)	2016A Bond Issue Premium
Budget Addition	91	100	1000	2017	5	10/13/2016	513900	31199	489,102.00	2016A Bond Issue Premium
Budget Addition	91	100	1000	2017	5	10/13/2016	200999	48200	(485,753.00)	2016A Bond Proceeds-Actual
Budget Addition	91	100	1000	2017	5	10/13/2016	200900	31199	485,753.00	2016A Bond Proceeds-Actual
Budget Addition	91	100	1000	2017	5	10/13/2016	200999	48400	(344,183.00)	2016A Bond Issue Premium
Budget Addition	91	100	1000	2017	5	10/13/2016	200900	31199	344,183.00	2016A Bond Issue Premium
Budget Addition	91	100	1000	2017	5	10/13/2016	210999	48400	(72,460.00)	2016A Bond Issue Premium

CITY OF ST. CHARLES
Budget Revision Listing

October 2016

JE TYPE	JE #	BUDGET #	COMPANY	FISCAL YEAR	PERIOD	DATE	ACCT-UNIT	ACCOUNT	AMOUNT	DESCRIPTION
Budget Addition	91	100	1000	2017	5	10/13/2016	210900	31199	72,460.00	2016A Bond Issue Premium
Budget Addition	91	100	1000	2017	5	10/13/2016	210999	48200	(584,800.00)	2016A Bond Proceeds-Actual
Budget Addition	91	100	1000	2017	5	10/13/2016	210900	31199	584,800.00	2016A Bond Proceeds-Actual
91 Total										-
Budget Addition	92	100	1000	2017	5	10/13/2016	713800	49300	(38,522.00)	2016B Refund Issue-Trsf-Escrow
Budget Addition	92	100	1000	2017	5	10/13/2016	713900	31199	38,522.00	2016B Refund Issue-Trsf-Escrow
Budget Addition	92	100	1000	2017	5	10/13/2016	305800	57004	38,522.00	2016B Refund Issue-Trsf-Escrow
Budget Addition	92	100	1000	2017	5	10/13/2016	305900	31199	(38,522.00)	2016B Refund Issue-Trsf-Escrow
Budget Addition	92	100	1000	2017	5	10/13/2016	731800	49100	(98,886.00)	2016B Refund Issue-Trsf-Escrow
Budget Addition	92	100	1000	2017	5	10/13/2016	731900	31199	98,886.00	2016B Refund Issue-Trsf-Escrow
Budget Addition	92	100	1000	2017	5	10/13/2016	100800	57111	98,886.00	2016B Refund Issue-Trsf-Escrow
Budget Addition	92	100	1000	2017	5	10/13/2016	100900	31199	(98,886.00)	2016B Refund Issue-Trsf-Escrow
92 Total										-
Budget Addition	93	100	1000	2017	5	10/13/2016	220550	55320	8,276.00	2016B Bond Issuance Costs
Budget Addition	93	100	1000	2017	5	10/13/2016	220550	54110	5,389.00	2016B Bond Issuance Costs
Budget Addition	93	100	1000	2017	5	10/13/2016	220550	55321	2,015.00	2016B Bond Issuance Costs
Budget Addition	93	100	1000	2017	5	10/13/2016	220900	31199	(15,680.00)	2016B Bond Issuance Costs
Budget Addition	93	100	1000	2017	5	10/13/2016	200520	55320	10,719.00	2016B Bond Issuance Costs
Budget Addition	93	100	1000	2017	5	10/13/2016	200520	54110	6,981.00	2016B Bond Issuance Costs
Budget Addition	93	100	1000	2017	5	10/13/2016	200520	55321	2,610.00	2016B Bond Issuance Costs
Budget Addition	93	100	1000	2017	5	10/13/2016	200900	31199	(20,310.00)	2016B Bond Issuance Costs
Budget Addition	93	100	1000	2017	5	10/13/2016	210540	55320	7,921.00	2016B Bond Issuance Costs
Budget Addition	93	100	1000	2017	5	10/13/2016	210540	54110	5,158.00	2016B Bond Issuance Costs
Budget Addition	93	100	1000	2017	5	10/13/2016	210540	55321	1,929.00	2016B Bond Issuance Costs
Budget Addition	93	100	1000	2017	5	10/13/2016	210900	31199	(15,008.00)	2016B Bond Issuance Costs
93 Total										-
Budget Entry Correction	94	100	1000	2017	5	10/13/2016	200520	55321	(382.00)	Correct #91-S/B 210540
Budget Entry Correction	94	100	1000	2017	5	10/13/2016	200900	31199	7,482.00	Correct #91-S/B 210900
Budget Entry Correction	94	100	1000	2017	5	10/13/2016	210540	55321	382.00	2016A Bond Issuance Costs
Budget Entry Correction	94	100	1000	2017	5	10/13/2016	210900	31199	(7,482.00)	2016A Bond Issuance Costs
94 Total										-
Budget Addition	95	100	1000	2017	5	10/13/2016	713700	55322	38,522.00	2016B Refunding Issue
Budget Addition	95	100	1000	2017	5	10/13/2016	713700	57500	2,653,608.00	2016B Refunding Issue
Budget Addition	95	100	1000	2017	5	10/13/2016	713999	48200	(2,275,000.00)	2016B Refunding Issue
Budget Addition	95	100	1000	2017	5	10/13/2016	713999	48400	(412,579.00)	2016B Refunding Issue
Budget Addition	95	100	1000	2017	5	10/13/2016	713700	55320	17,930.00	2016B Refunding Issue Costs
Budget Addition	95	100	1000	2017	5	10/13/2016	713700	54110	11,676.00	2016B Refunding Issue Costs
Budget Addition	95	100	1000	2017	5	10/13/2016	713700	55321	4,366.00	2016B Refunding Issue Costs
Budget Addition	95	100	1000	2017	5	10/13/2016	713900	31199	(38,523.00)	2016B Refunding Issue
Budget Addition	95	100	1000	2017	5	10/13/2016	731700	55322	98,886.00	2016B Refunding Issue
Budget Addition	95	100	1000	2017	5	10/13/2016	731700	57500	6,811,850.00	2016B Refunding Issue
Budget Addition	95	100	1000	2017	5	10/13/2016	731999	48200	(5,839,958.00)	2016B Refunding Issue

CITY OF ST. CHARLES
Budget Revision Listing

October 2016

JE TYPE	JE #	BUDGET #	COMPANY	FISCAL YEAR	PERIOD	DATE	ACCT-UNIT	ACCOUNT	AMOUNT	DESCRIPTION
Budget Addition	95	100	1000	2017	5	10/13/2016	731999	48400	(1,059,096.00)	2016B Refunding Issue
Budget Addition	95	100	1000	2017	5	10/13/2016	731700	55320	46,027.00	2016B Refunding Issue Costs
Budget Addition	95	100	1000	2017	5	10/13/2016	731700	54110	29,973.00	2016B Refunding Issue Costs
Budget Addition	95	100	1000	2017	5	10/13/2016	731700	55321	11,207.00	2016B Refunding Issue Costs
Budget Addition	95	100	1000	2017	5	10/13/2016	731900	31199	(98,889.00)	2016B Refunding Issue
95 Total										-
Budget Transfer	96	100	1000	2017	5	10/13/2016	220999	48200	1,589,000.00	Reclass as IEPA Loan Proceeds
Budget Transfer	96	100	1000	2017	5	10/13/2016	220999	48300	(1,589,000.00)	Reclass from Bond Proceeds
96 Total										-
Budget Transfer	97	100	1000	2017	5	10/13/2016	100400	50101	42,000.00	Trsf FT to PT for 2 new PT adm
Budget Transfer	97	100	1000	2017	5	10/13/2016	100400	50100	(42,000.00)	Trsf FT to PT for 2 new PT adm
97 Total										-
Budget Transfer	98	100	1000	2017	6	10/13/2016	804530	56301	4,865.00	Fiber Mapping Software-CC 10/3
Budget Transfer	98	100	1000	2017	6	10/13/2016	804530	56002	(4,865.00)	Fiber Mapping Software-CC 10/3
98 Total										-
Budget Addition	99	100	1000	2017	6	10/13/2016	804530	56301	68.00	For MS Office-From Comp Reserv
Budget Addition	99	100	1000	2017	6	10/13/2016	804900	31194	(68.00)	For MS Office-From Comp Reserv
99 Total										-
Budget Transfer	100	100	1000	2017	6	10/14/2016	100400	51501	(1,000.00)	Nat'l Fire Academy Per Diem
Budget Transfer	100	100	1000	2017	6	10/14/2016	100400	51402	1,000.00	Nat'l Fire Academy Per Diem
100 Total										-
Budget Transfer	101	100	1000	2017	6	10/17/2016	100400	52100	500.00	For refreshment supplies
Budget Transfer	101	100	1000	2017	6	10/17/2016	100400	51501	(500.00)	For refreshment supplies
101 Total										-
Budget Addition	102	100	1000	2017	6	10/17/2016	100604	54110	1,220.00	Legal expenses/portion reimb
Budget Addition	102	100	1000	2017	6	10/17/2016	100999	45102	(220.00)	Legal expenses/portion reimb
Budget Addition	102	100	1000	2017	6	10/17/2016	100999	45102	(500.00)	Legal expenses/portion reimb
Budget Addition	102	100	1000	2017	6	10/17/2016	100900	31199	(500.00)	Legal expenses/portion reimb
102 Total										-
Budget Transfer	103	100	1000	2017	6	10/19/2016	801512	51401	570.00	Lodging for Stan I. conference
Budget Transfer	103	100	1000	2017	6	10/19/2016	801512	51300	(570.00)	Lodging for Stan I. conference
Budget Transfer	103	100	1000	2017	6	10/19/2016	100500	50101	6,878.00	Trsf bgt for Intern Fr FT Wage
Budget Transfer	103	100	1000	2017	6	10/19/2016	100500	50100	(6,878.00)	Trsf bgt for Intern To PT Wage
Budget Transfer	103	100	1000	2017	6	10/19/2016	100500	52306	100.00	For signage supplies
Budget Transfer	103	100	1000	2017	6	10/19/2016	100500	52319	(100.00)	For signage supplies
Budget Transfer	103	100	1000	2017	6	10/19/2016	100510	54001	900.00	For GPS fees for PS Vehicles
Budget Transfer	103	100	1000	2017	6	10/19/2016	100510	54305	(900.00)	For GPS fees for PS Vehicles
Budget Transfer	103	100	1000	2017	6	10/19/2016	100604	50200	900.00	OT for Dev Eng
Budget Transfer	103	100	1000	2017	6	10/19/2016	100604	50100	(900.00)	OT for Dev Eng
Budget Transfer	103	100	1000	2017	6	10/19/2016	200520	50200	100.00	OT for Elec Admin staff
Budget Transfer	103	100	1000	2017	6	10/19/2016	200520	50100	(100.00)	OT for Elec Admin staff
Budget Transfer	103	100	1000	2017	6	10/19/2016	210540	50200	100.00	OT for Water Admin staff

CITY OF ST. CHARLES
Budget Revision Listing

October 2016

JE TYPE	JE #	BUDGET #	COMPANY	FISCAL YEAR	PERIOD	DATE	ACCT-UNIT	ACCOUNT	AMOUNT	DESCRIPTION
Budget Transfer	103	100	1000	2017	6	10/19/2016	210540	50100	(100.00)	OT for Water Admin staff
Budget Transfer	103	100	1000	2017	6	10/19/2016	210541	54301	900.00	For hauling services
Budget Transfer	103	100	1000	2017	6	10/19/2016	210541	54463	(900.00)	For hauling services
Budget Transfer	103	100	1000	2017	6	10/19/2016	220550	50200	100.00	OT for WW Admin staff
Budget Transfer	103	100	1000	2017	6	10/19/2016	220550	50100	(100.00)	OT for WW Admin staff
Budget Transfer	103	100	1000	2017	6	10/19/2016	220551	52304	300.00	For Safety Supplies
Budget Transfer	103	100	1000	2017	6	10/19/2016	220551	52304	(300.00)	For Safety Supplies
Budget Transfer	103	100	1000	2017	6	10/19/2016	800223	52312	150.00	For paints, supplies & solvent
Budget Transfer	103	100	1000	2017	6	10/19/2016	800223	52310	(150.00)	For paints, supplies & solvent
	103 Total								-	
Roll Forward Budget for Non PO	104	100	1000	2017	6	10/19/2016	200521	56001	3,001.00	Partial pending R/F EL2023
Roll Forward Budget for Non PO	104	100	1000	2017	6	10/19/2016	200521	59999	(3,001.00)	Partial pending R/F EL2023
Roll Forward Budget for Non PO	104	100	1000	2017	6	10/19/2016	200521	59999	(2,204.00)	Release remain R/F EL2023
Roll Forward Budget for Non PO	104	100	1000	2017	6	10/19/2016	200900	31199	2,204.00	Release remain R/F EL2023
	104 Total								-	
Budget Transfer	105	100	1000	2017	6	10/19/2016	513501	56170	8,000.00	Testing for IL31 Culvert proj
Budget Transfer	105	100	1000	2017	6	10/19/2016	513500	56170	(8,000.00)	Testing for IL31 Culvert proj
	105 Total								-	
Budget Transfer	106	100	1000	2017	6	10/20/2016	100210	54110	10,000.00	Legal svcs-RHS plan research
Budget Transfer	106	100	1000	2017	6	10/20/2016	100210	51301	(10,000.00)	Legal svcs-RHS plan research
	106 Total								-	
Budget Transfer	107	100	1000	2017	6	10/20/2016	220551	54464	2,500.00	For lift station maintenance
Budget Transfer	107	100	1000	2017	6	10/20/2016	220551	54461	(2,500.00)	For lift station maintenance
	107 Total								-	
Roll Forward Budget for Non PO	108	100	1000	2017	6	10/21/2016	100600	54641	7,926.00	R/F remaining 15/16 CIC funds
Roll Forward Budget for Non PO	108	100	1000	2017	6	10/21/2016	100600	59999	(7,926.00)	R/F remaining 15/16 CIC funds
	108 Total								-	
Roll Forward Budget for Non PO	109	100	1000	2017	6	10/21/2016	801300	56001	6,550.00	R/F Remaining Budget MV3035
Roll Forward Budget for Non PO	109	100	1000	2017	6	10/21/2016	801900	31199	(6,550.00)	R/F Remaining Budget MV3035
	109 Total								-	
Budget Transfer	110	100	1000	2017	6	10/21/2016	513501	56170	6,620.00	State St Creek Watershed Plan
Budget Transfer	110	100	1000	2017	6	10/21/2016	513501	56150	(6,620.00)	State St Creek Watershed Plan
	110 Total								-	
Budget Transfer	111	100	1000	2017	6	10/25/2016	800223	54450	900.00	For repairs to fuel station
Budget Transfer	111	100	1000	2017	6	10/25/2016	800223	54501	(900.00)	For repairs to fuel station
	111 Total								-	
Budget Transfer	112	100	1000	2017	6	10/26/2016	100200	56004	5,000.00	CC Chmbrs Audio Fix, Fr IS1004
Budget Transfer	112	100	1000	2017	6	10/26/2016	100200	56004	(5,000.00)	CC Chmbrs Audio Fix, Fr IS1004
Budget Transfer	112	100	1000	2017	6	10/26/2016	100200	56004	2,800.00	CC Chmbrs Audio Fix, Fr IS1008
Budget Transfer	112	100	1000	2017	6	10/26/2016	100200	56004	(2,800.00)	CC Chmbrs Audio Fix, Fr IS1008
	112 Total								-	
Budget Addition	113	100	1000	2017	6	10/27/2016	220552	54399	5,987.00	Sewer Assist-1231 S.10th St

CITY OF ST. CHARLES
Budget Revision Listing

October 2016

JE TYPE	JE #	BUDGET #	COMPANY	FISCAL YEAR	PERIOD	DATE	ACCT-UNIT	ACCOUNT	AMOUNT	DESCRIPTION
Budget Addition	113	100	1000	2017	6	10/27/2016	220900	31199	(5,987.00)	Sewer Assist-1231 S.10th St
Budget Addition	113	100	1000	2017	6	10/27/2016	100603	50200	4,572.00	Inspection OT-Reimbursable
Budget Addition	113	100	1000	2017	6	10/27/2016	100999	42302	(4,572.00)	Inspection OT-Reimbursable
	113 Total									-
	Grand Total									-

The revisions shown herewith have been approved by the City Council, except as noted below.

_____ Date

Chairman, Government Operations Committee

_____ Date

Vice Chairman, Government Operations Committee

_____ Date

Finance Director

Exceptions:



AGENDA ITEM EXECUTIVE SUMMARY

Agenda Item number: 4a

Title: Video Gaming Statistics – Information Only

Presenter: Chief Keegan

Meeting: Government Operations Committee

Date: November 7, 2016

Proposed Cost: \$

Budgeted Amount: \$

Not Budgeted:

Executive Summary *(if not budgeted please explain):*

Latest statistics on video gaming of what businesses have been approved by the state and City of St. Charles, pending applications into the state for approval, and September report for St. Charles video gaming revenue.

Attachments *(please list):*

Table – Video Gaming Establishments/Pending Applicants
Illinois Gaming Board Video Gaming Report – September 2016

Recommendation/Suggested Action *(briefly explain):*

None – For Information Only

Video Gaming Statistics as of October 18, 2016

Approved Establishments		
Name	# Machines	Address
A'Salute Lounge & Grill	5	2400 E Main Street, St. Charles
Alibi Bar & Grill Ltd.	5	12 N 3 rd Street, St. Charles
Alley 64	5	212 W Main Street, St. Charles
Dawn's Beach Hut	2	8 N 3 rd Street, St. Charles
Kane County Rookies	5	1545 W Main Street, St. Charles
Riverside Pizza & Pub	3	102 E Main Street, St. Charles
St. Charles Moose	5	2250 W Rt. 38, St. Charles

Pending Applicants		
Name	# Machines	Address
Charleston on the Fox	?	1 W Illinois Street, St. Charles
Corfu Restaurant	?	2520 E Main Street, St. Charles
BeeHive Tavern & Grille	?	204 W Main Street, St. Charles
Gino's East	?	1590 E Main Street, St. Charles
Pub 222	?	222 W Main Street, St. Charles
St. Charles Bowl	?	2520 W Main Street, St. Charles
Trattoria ZaZa	?	5 S 1 st Street, St. Charles
Spotted Fox Ale House	?	3615 E Main Street, St. Charles
The Evergreen Pub & Grill	?	1400 W Main Street, St. Charles

**ILLINOIS GAMING BOARD
VIDEO GAMING REPORT**

10/18/2016

12:34 pm

St. Charles

September 2015 - September 2016

Municipality	Establishment	License Number	VGT Count	VGT Wagering Activity			VGT Income			VGT Tax Distribution				
				Amount Played	Amount Won	Net Wagering Activity	Funds In	Funds Out	NTI	NTI Tax Rate (30%)	State Share	Municipality Share		
St. Charles	A'Salute' Inc.	160702452	5	\$15,253.67	\$13,873.14	\$1,380.53	\$4,877.00	\$3,496.47	\$1,380.53	\$414.18	\$345.15	\$69.03		
St. Charles	BK & MM VENTURES LLC	160702415	5	\$69,217.89	\$63,365.43	\$5,852.46	\$24,474.00	\$18,621.47	\$5,852.53	\$1,755.78	\$1,463.15	\$292.63		
St. Charles	DAWN'S CAFE, LTD.	160702454	2	\$1,030.25	\$882.93	\$147.32	\$388.00	\$240.60	\$147.40	\$44.22	\$36.85	\$7.37		
REPORT TOTAL:				3 Establishments	12	\$85,501.81	\$78,121.50	\$7,380.31	\$29,739.00	\$22,358.54	\$7,380.46	\$2,214.18	\$1,845.15	\$369.03

**AGENDA ITEM EXECUTIVE SUMMARY**

Agenda Item number: 5a

Title:

Recommendation to Accept the Comprehensive Annual Financial Report, Independent Auditor's Report Pursuant To Uniform Guidance, and Management Letter for the Fiscal Year Ended April 30, 2016

Presenter:

Chris Minick, Finance Director
Fred Lantz, Partner, Sikich, LLP

Meeting: Government Operations Committee

Date: November 7, 2016

Proposed Cost: \$ N/A

Budgeted Amount: \$

Not Budgeted: **Executive Summary** (if not budgeted please explain):

Representatives of the City's independent auditing firm, Sikich, LLP, will present the 2015-2016 Comprehensive Annual Financial Report (CAFR), Independent Auditor's Report Pursuant To Uniform Guidance, Management Letter, and results of operations for the fiscal year. The CAFR was previously distributed to City Council.

State statutes require the City to have an audit performed by an independent CPA on an annual basis. The CAFR presents the financial statements and results of operations of the City. The auditor certifies that the financial statements are presented in accordance with generally accepted accounting principles (GAAP).

For 2015-2016, the City received an unmodified opinion on its financial statement presentation in the CAFR. This is the best audit opinion an entity can receive and it signifies that the City's financial statements are presented in accordance with GAAP. Sikich will briefly review the relevant highlights of the CAFR for the Committee.

For the 2014-2015 fiscal year, the City again received the Certificate of Achievement for Excellence in Financial Reporting from the Government Finance Officers Association (GFOA). We have submitted the 2015-2016 Comprehensive Annual Financial Report to GFOA for consideration of the same award.

Attachments (please list):

Independent Auditor's Report Pursuant To Uniform Guidance

Management Letter

Comprehensive Annual Financial Report (NOTE: this report was previously distributed)

Recommendation/Suggested Action (briefly explain):

Recommendation to accept the Comprehensive Annual Financial Report, Independent Auditor's Report Pursuant to Uniform Guidance, and Management Letter for the fiscal year ended April 30, 2016.

CITY OF ST. CHARLES, ILLINOIS

**INDEPENDENT AUDITOR'S REPORT
PURSUANT TO UNIFORM GUIDANCE**

For the Year Ended
April 30, 2016



CITY OF ST. CHARLES, ILLINOIS
TABLE OF CONTENTS

	<u>Page(s)</u>
Independent Auditor’s Report on Internal Control Over Financial Reporting and on Compliance and Other Matters Based on an Audit of Financial Statements Performed in Accordance with <i>Government Auditing Standards</i>	1-2
Independent Auditor’s Report on Compliance for each Major Federal Program; Report on Internal Control Over Compliance; and Report on the Schedule of Expenditures of Federal Awards Required by the Uniform Guidance	3-5
Schedule of Expenditures of Federal Awards.....	6-7
Schedule of Findings and Questioned Costs.....	8-9

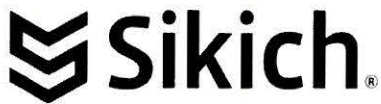

**INDEPENDENT AUDITOR'S REPORT ON INTERNAL CONTROL OVER
FINANCIAL REPORTING AND ON COMPLIANCE AND OTHER MATTERS
BASED ON AN AUDIT OF FINANCIAL STATEMENTS PERFORMED
IN ACCORDANCE WITH *GOVERNMENT AUDITING STANDARDS***

The Honorable Mayor
Members of the City Council
City of St. Charles, Illinois

We have audited, in accordance with the auditing standards generally accepted in the United States of America and the standards applicable to financial audits contained in *Government Auditing Standards* issued by the Comptroller General of the United States, the financial statements of the governmental activities, the business-type activities, each major fund, and the aggregate remaining fund information of the City of St. Charles, Illinois (the City) as of and for the year ended April 30, 2016, and the related notes to financial statements, which collectively comprise the City's basic financial statements, and have issued our report thereon dated October 4, 2016.

Internal Control Over Financial Reporting

In planning and performing our audit, we considered the City's internal control over financial reporting (internal control) to determine the audit procedures that are appropriate in the circumstances for the purpose of expressing our opinion on the basic financial statements, but not for the purpose of expressing an opinion on the effectiveness of the City's internal control over financial reporting. Accordingly, we do not express an opinion on the effectiveness of the City's internal control over financial reporting.

A deficiency in internal control exists when the design or operation of a control does not allow management or employees, in the normal course of performing their assigned functions, to prevent, or detect and correct, misstatements on a timely basis. *A material weakness* is a deficiency, or a combination of deficiencies, in internal control, such that there is a reasonable possibility that a material misstatement of the City's financial statements will not be prevented, or detected and corrected on a timely basis. *A significant deficiency* is a deficiency, or a combination of deficiencies, in internal control that is less severe than a material weakness, yet important enough to merit attention by those charged with governance.

Our consideration of internal control was for the limited purpose described in the first paragraph of this section and was not designed to identify all deficiencies in internal control that might be material weaknesses or, significant deficiencies. Given these limitations, during our audit we did not identify any deficiencies in internal control that we consider to be material weaknesses. However, material weaknesses may exist that have not been identified.

Compliance and Other Matters

As part of obtaining reasonable assurance about whether the City's financial statements are free of material misstatement, we performed tests of its compliance with certain provisions of laws, regulations, contracts and grant agreements, noncompliance with which could have a direct and material effect on the determination of the financial statement amounts. However, providing an opinion on compliance with those provisions was not an objective of our audit and, accordingly, we do not express such an opinion. The results of our tests disclosed no instances of noncompliance or other matters that are required to be reported under *Government Auditing Standards*.

Purpose of this Report

The purpose of this report is solely to describe the scope of our testing of internal control and compliance and the results of that testing, and not to provide an opinion on the effectiveness of the City's internal control or on compliance. This report is an integral part of an audit performed in accordance with *Government Auditing Standards* in considering the City's internal control and compliance. Accordingly, this communication is not suitable for any other purpose.

Sikich LLP

Naperville, Illinois
October 4, 2016



1415 W. Diehl Road, Suite 400
Naperville, Illinois 60563

Certified Public Accountants & Advisors
Members of American Institute of Certified Public Accountants

**INDEPENDENT AUDITOR'S REPORT ON COMPLIANCE FOR EACH
MAJOR FEDERAL PROGRAM; REPORT ON INTERNAL CONTROL OVER
COMPLIANCE; AND REPORT ON THE SCHEDULE OF EXPENDITURES OF
FEDERAL AWARDS REQUIRED BY THE UNIFORM GUIDANCE**

The Honorable Mayor
Members of the City Council
City of St. Charles, Illinois

Report on Compliance for Each Major Federal Program

We have audited the City of St. Charles, Illinois' (the City) compliance with the types of compliance requirements described in the *OMB Compliance Supplement* that could have a direct and material effect on each of the City's major federal programs for the year ended April 30, 2016. The City's major federal programs are identified in the summary of auditor's results section of the accompanying schedule of findings and questioned costs.

Management's Responsibility

Management is responsible for compliance with federal statutes, regulations, and the terms and conditions of its federal awards applicable to its federal programs.

Auditor's Responsibility

Our responsibility is to express an opinion on compliance for each of the City's major federal programs based on our audit of the types of compliance requirements referred to above. We conducted our audit of compliance in accordance with auditing standards generally accepted in the United States of America; the standards applicable to financial audits contained in *Government Auditing Standards*, issued by the Comptroller General of the United States; and the audit requirements of Title 2 U.S. *Code of Federal regulations* Part 200, *Uniform Administrative Requirements, Cost Principles, and Audit Requirements for Federal Awards* (Uniform Guidance). Those standards and the Uniform Guidance require that we plan and perform the audit to obtain reasonable assurance about whether noncompliance with the types of compliance requirements referred to above that could have a direct and material effect on a major federal program occurred. An audit includes examining, on a test basis, evidence about the City's compliance with those requirements and performing such other procedures as we considered necessary in the circumstances.

We believe that our audit provides a reasonable basis for our opinion on compliance for each major federal program. However, our audit does not provide a legal determination of the City's compliance.

Opinion on Each Major Federal Program

In our opinion, the City of St. Charles, Illinois complied, in all material respects, with the types of compliance requirements referred to above that could have a direct and material effect on each of its major federal programs for the year ended April 30, 2016.

Report on Internal Control Over Compliance

Management of the City is responsible for establishing and maintaining effective internal control over compliance with the types of compliance requirements referred to above. In planning and performing our audit of compliance, we considered the City's internal control over compliance with the types of requirements that could have a direct and material effect on each major federal program to determine the auditing procedures that are appropriate in the circumstances for the purpose of expressing an opinion on compliance for each major federal program and to test and report on internal control over compliance in accordance with Uniform Guidance, but not for the purpose of expressing an opinion on the effectiveness of internal control over compliance. Accordingly, we do not express an opinion on the effectiveness of the City's internal control over compliance.

A deficiency in internal control over compliance exists when the design or operation of a control over compliance does not allow management or employees, in the normal course of performing their assigned functions, to prevent, or detect and correct, noncompliance with a type of compliance requirement of a federal program on a timely basis. *A material weakness in internal control over compliance* is a deficiency, or combination of deficiencies, in internal control over compliance, such that there is a reasonable possibility that material noncompliance with a type of compliance requirement of a federal program will not be prevented, or detected and corrected, on a timely basis. *A significant deficiency in internal control over compliance* is a deficiency, or a combination of deficiencies, in internal control over compliance with a type of compliance requirement of a federal program that is less severe than a material weakness in internal control over compliance, yet important enough to merit attention by those charged with governance.

Our consideration of internal control over compliance was for the limited purpose described in the first paragraph of this section and was not designed to identify all deficiencies in internal control over compliance that might be material weaknesses or significant deficiencies. We did not identify any deficiencies in internal control over compliance that we consider to be material weaknesses. However, material weaknesses may exist that have not been identified.

The purpose of this report on internal control over compliance is solely to describe the scope of our testing of internal control over compliance and the results of that testing based on the requirements of the Uniform Guidance. Accordingly, this report is not suitable for any other purpose.

Report on Schedule of Expenditures of Federal Awards Required by the Uniform Guidance

We have audited the financial statements of the governmental activities, the business-type activities, each major fund and the aggregate remaining fund information of the City, as of and for the year ended April 30, 2016, and the related notes to the financial statements, which collectively comprise the City's basic financial statements. We issued our report thereon dated October 4, 2016, which contained unmodified opinions on those financial statements. Our audit was conducted for the purpose of forming opinions on the financial statements that collectively comprise the basic financial statements. The accompanying schedule of expenditures of federal awards is presented for purposes of additional analysis as required by the Uniform Guidance and is not a required part of the basic financial statements. Such information is the responsibility of management and was derived from and relates directly to the underlying accounting and other records used to prepare the basic financial statements. The information has been subjected to the auditing procedures applied in the audit of the financial statements and certain additional procedures, including comparing and reconciling such information directly to the underlying accounting and other records used to prepare the basic financial statements or to the basic financial statements themselves, and other additional procedures in accordance with auditing standards generally accepted in the United States of America. In our opinion, the schedule of expenditures of federal awards is fairly stated in all material respects in relation to the basic financial statements as a whole.

Sikich LLP

Naperville, Illinois
October 4, 2016

CITY OF ST. CHARLES, ILLINOIS

SCHEDULE OF EXPENDITURES OF FEDERAL AWARDS

For the Year Ended April 30, 2016

Federal Grantor	Pass-Through Grantor	Program Title	Federal CFDA Number	Program/Grant Number	Revenues	Expenditures
U.S. Environmental Protection Agency	Illinois Environmental Protection Agency	Capitalization Grants for Drinking Water State Revolving Funds	66.468 *	L17-5203	\$ 267,186	\$ 267,186
U.S. Environmental Protection Agency	Illinois Environmental Protection Agency	Capitalization Grants for Drinking Water State Revolving Funds	66.468 *	L17-5285	2,508,804	2,508,804
Total CFDA 66.468					<u>2,775,990</u>	<u>2,775,990</u>
U.S. Department of Justice	North Central Narcotics	Edward Byrne Memorial Justice Assistance Grant Program	16.738	412009	1,596	1,596
U.S. Department of Justice	N/A	Bulletproof Vest Partnership Program	16.607	N/A	6,740	6,740
U.S. Department of Transportation	Illinois Department of Transportation	State and Community Highway Safety	20.601	N/A	15,581	15,581
U.S. Department of Homeland Security	Federal Emergency Management Agency	Assistance to Firefighters Grant	97.044	N/A	4,554	4,554
U.S. Department of Homeland Security	Illinois Law Enforcement Alarm System	Homeland Security Grant Program	97.067	N/A	<u>6,873</u>	<u>6,873</u>
TOTAL FEDERAL AWARDS					<u>\$ 2,811,334</u>	<u>\$ 2,811,334</u>

* Denotes major program

CITY OF ST. CHARLES, ILLINOIS

SCHEDULE OF EXPENDITURES OF FEDERAL AWARDS (Continued)

For the Year Ended April 30, 2016

Notes to the Schedule of Expenditures of Federal Awards

Note A - Basis of Presentation

The accompanying schedule of federal awards is a summary of the activity of the City's federal award programs presented on the modified accrual basis of accounting in accordance with accounting principles generally accepted in the United States of America. Accordingly, revenues are recognized when the qualifying expenditure has been incurred and expenditures have been recognized when the fund liability has been incurred.

Note B - Subrecipients

There were no subrecipients for the fiscal year ending April 30, 2016.

Note C - Noncash Transactions

There were no noncash transactions for the fiscal year ending April 30, 2016.

Note D - Loans

The City had Illinois Environmental Protection Agency loans outstanding in the amount of \$28,491,938 at April 30, 2016. The loans have no continuing compliance requirements aside from loan repayment.

Note E - Federal Insurance

There was no federal insurance in effect for the fiscal year ending April 30, 2016.

Note F - Indirect Cost Rate

The City did not elect to use the federal 10% de minimis indirect cost rate for the year ending April 30, 2016.

CITY OF ST. CHARLES, ILLINOIS

SCHEDULE OF FINDINGS AND QUESTIONED COSTS

For the Year Ended April 30, 2016

Section I - Summary of Auditor's Results

Financial Statements

Type of auditor's report issued: *unmodified*

Internal control over financial reporting:
Material weakness(es) identified? yes no
Significant deficiency(ies) identified? yes none reported

Noncompliance material to financial statements noted? yes no

Federal Awards

Internal control over major programs:
Material weakness(es) identified? yes no
Significant deficiency(ies) identified? yes none reported

Type of auditor's report issued on compliance
for major federal programs: *unmodified*

Any audit findings disclosed that are required
to be reported in accordance with
2 CFR 200.516(a)? yes no

Identification of major federal programs:

<u>CFDA Number(s)</u>	<u>Name of Federal Program or Cluster</u>
66.468	Capitalization Grants for Drinking Water State Revolving Funds

Dollar threshold used to distinguish
between Type A and Type B programs: \$ 750,000

Auditee qualified as low-risk auditee? yes no

CITY OF ST. CHARLES, ILLINOIS

SCHEDULE OF FINDINGS AND QUESTIONED COSTS (Continued)

For the Year Ended April 30, 2016

Section II - Financial Statement Findings

None

Section III - Federal Award Findings and Questioned Costs

None

Section IV - Prior Year audit Findings

None

CITY OF ST. CHARLES, ILLINOIS

MANAGEMENT LETTER

April 30, 2016





630.566.8400 // www.sikich.com

1415 W. Diehl Road, Suite 400
Naperville, Illinois 60563

Certified Public Accountants & Advisors
Members of American Institute of Certified Public Accountants

The Honorable Mayor
Members of the City Council
City of St. Charles, Illinois

In planning and performing our audit of the financial statements of the governmental activities, the business-type activities, each major fund, and the aggregate remaining fund information of the City of St. Charles, Illinois (the City) as of and for the year ended April 30, 2016, in accordance with auditing standards generally accepted in the United States of America, we considered the City's internal control over financial reporting (internal control) as a basis for designing audit procedures that are appropriate in the circumstances for the purpose of expressing our opinions on the financial statements, but not for the purpose of expressing an opinion on the effectiveness of the City's internal control. Accordingly, we do not express an opinion on the effectiveness of the City's internal control.

Our consideration of internal control was for the limited purpose described in the preceding paragraph and was not designed to identify all deficiencies in internal control that might be material weaknesses. Given these limitations during our audit, we did not identify and deficiencies in internal control that we consider to be material weaknesses. However, material weaknesses may exist that have not been identified.

A deficiency in internal control exists when the design or operation of a control does not allow management or employees, in the normal course of performing their assigned functions, to prevent, or detect and correct, misstatements on a timely basis. A material weakness is a deficiency, or a combination of deficiencies in internal control, such that there is a reasonable possibility that a material misstatement of the City's financial statements will not be prevented, or detected and corrected, on a timely basis.

This communication is intended solely for the information and use of management, the Mayor, the City Council, and others within the City of St. Charles and is not intended to be, and should not be used by anyone other than these specified parties.

Sikich LLP

Naperville, Illinois
October 4, 2016

OTHER COMMENTS

Future Accounting Pronouncements

The Governmental Accounting Standards Board (GASB) has issued a number of pronouncements that may affect the City in the future:

GASB Statement No. 72, *Fair Value Measurement and Application*, addresses accounting and financial reporting issues related to fair value measurements. The definition of fair value is the price that would be received to sell an asset or paid to transfer a liability in an orderly transaction between market participants at the measurement date. This Statement provides guidance for determining a fair value measurement for financial reporting purposes. This Statement also provides guidance for applying fair value to certain investments and disclosures related to all fair value measurements. Statement No. 72 is applicable for the fiscal year ending April 30, 2017.

GASB Statement No. 73, *Accounting and Financial Reporting for Pensions and Related Assets That Are Not within the Scope of GASB Statement 68, and Amendments to Certain Provisions of GASB Statements 67 and 68*, establishes requirements for those pensions and pension plans that are not administered through a trust meeting specified criteria. The provisions in Statement No. 73 are effective for fiscal years beginning after June 15, 2015—except those provisions that address employers and governmental nonemployer contributing entities for pensions that are not within the scope of Statement No. 68, which are effective for financial statements for fiscal year ending April 30, 2017.

GASB Statement No. 74, *Financial Reporting for Postemployment Benefit Plans Other Than Pension Plans*, addresses reporting by OPEB plans that administer benefits on behalf of governments and replaces GASB Statement No. 43, *Financial Reporting for Postemployment Benefit Plans Other Than Pension Plans*. Statement No. 74 addresses the financial reports of defined benefit OPEB plans that are administered through trusts that meet specified criteria. The statement builds upon the existing framework for financial reports of defined benefit OPEB plans, which includes a statement of fiduciary net position (the amount held in a trust for paying retirement benefits) and a statement of changes in fiduciary net position. Statement No. 74 enhances note disclosures and RSI for both defined benefit and defined contribution OPEB plans. Statement No. 74 also requires the presentation of new information about annual money-weighted rates of return in the notes to the financial statements and in 10-year RSI schedules. The provisions in Statement No. 74 are effective for OPEB plan or sponsoring employer financial statements for the fiscal year ending April 30, 2018.

GASB Statement No. 75, *Accounting and Financial Reporting for Postemployment Benefits Other Than Pensions*, addresses reporting by governments that provide OPEB to their employees and for governments that finance OPEB for employees of other governments and replaces the requirements of GASB Statement No. 45, *Accounting and Financial Reporting by Employers for Postemployment Benefits Other Than Pensions*, as they relate to governments that provide benefits through OPEB plans administered as trusts or similar arrangements that meet certain criteria. Statement No. 75 requires governments providing defined benefit OPEB to recognize their long-term obligation for OPEB as a liability for the first time, and to more comprehensively and comparably measure the annual costs of OPEB benefits. The Statement also enhances accountability and transparency through revised and new note disclosures and required supplementary information (RSI). The provisions in Statement No.75 are effective for the fiscal year ending April 30, 2019.

OTHER COMMENTS (Continued)

Future Accounting Pronouncements (Continued)

GASB Statement No. 76, *The Hierarchy of Generally Accepted Accounting Principles for State and Local Governments*, reduces the generally accepted accounting principles (GAAP) hierarchy to two categories of authoritative GAAP: officially established accounting principles - GASB Statements (Category A) and GASB Technical Bulletins; GASB Implementation Guides; and literature of the American Institute of Certified Public Accountants cleared by the GASB (Category B). Statement No. 76 also addresses the use of authoritative and nonauthoritative literature in the event that the accounting treatment for a transaction or other event is not specified within a source of authoritative GAAP. Statement No. 76 is applicable for fiscal years ending April 30, 2017. Earlier application is permitted.

GASB Statement No. 77, *Tax Abatement Disclosures*, requires disclosure of tax abatement information about (1) a reporting government's own tax abatement agreements and (2) those that are entered into by other governments and reduce the reporting government's tax revenues. The requirements of this statement are effective for financial statements for the fiscal year ending April 30, 2017.

GASB Statement No. 78, *Pensions Provided Through Certain Multiple-Employer Defined Benefit Pension Plans*, establishes requirements for pensions provided to employees of state or local government employers through a cost-sharing multiple-employer defined benefit pension plan that (1) is not a state or local government pension plan, (2) is used to provide defined benefit pensions to both employees of state or local governmental employers and to employees of employers that are not state or local governmental employers, and (3) has no predominant state or local governmental employer (either individually or collectively with other state or local governmental employers that provide pensions through the pension plan). The requirements of this statement are effective for the fiscal year ending April 30, 2017.

GASB Statement No. 79, *Certain External Investment Pools and Pool Participants*, establishes criteria for an external investment pool to qualify for making the election to measure all of its investments at amortized cost for financial reporting purposes. The requirements of this statement are effective for the fiscal year ending April 30, 2017.

GASB Statement No. 80, *Blending Requirements for Certain Component Units—an amendment of GASB Statement No. 14*. The requirements of this statement are effective for the fiscal year ending April 30, 2018.

GASB Statement No. 81, *Irrevocable Split-Interest Agreements*, provides recognition and measurement guidance for situations in which a government is a beneficiary of a split-interest agreement. The requirements of this statement are effective for the fiscal year ending April 30, 2018.

GASB Statement No. 82, *Pension Issues - an amendment of GASB Statements No. 67, No. 68, and No. 73*, addresses issues regarding (1) the presentation of payroll-related measures in the required supplementary information, (2) the selection of assumptions and the treatment of deviations from the guidance in an Actuarial Standard of Practice for financial reporting purposes, and (3) the classification of payments made by employers to satisfy employee (plan member) contribution requirements. The requirements of this standard are effective for the fiscal year ending April 30, 2018. Earlier application is encouraged.

**AGENDA ITEM EXECUTIVE SUMMARY**

Agenda Item number: 5b

Title:

Recommendation to Authorize the Finance Director to Execute the Risk Insurance Program Renewal for the Year Beginning December 1, 2016

Presenter:

Chris Minick, Finance Director

Meeting: Government Operations Committee

Date: November 7, 2016

Proposed Cost: \$620,019

Budgeted Amount: \$ 622,000

Not Budgeted: **Executive Summary** *(if not budgeted please explain):*

The City retained Assurance Agency as its consultant for the risk insurance program for the 2014-2015 renewal year. Assurance became familiar with City operations and processes and took the liability package insurance program to the market soliciting proposals for the renewal year beginning December 1, 2015. The 2015 package featured various minor coverage enhancements at a significant cost savings as compared with the City's prior risk insurance package. Typically, insurance programs are taken to market on a comprehensive basis every 3-4 years.

The cost of the renewal package for the year beginning December 1, 2016 is \$620,019. This compares to a cost of \$594,842 for the 2015 renewal. We have increased flood coverage for our Police Station at an additional premium of \$9,500. If you factor out the coverage enhancement, the renewal increases by approximately \$15,677 or 2.6%.

For 2016, the rates paid for the renewal policies remain essentially in line with the rates quoted for the 2015 package. The City's exposures have increased somewhat, resulting in higher total costs for the package when the rates are applied. Payroll exposures related to the Workers Compensation policy have increased by 2.8% and City property values have increased by 5.2%. Other than the flood coverage noted above, there have been no substantive changes to any of the City's coverage limits, deductibles, or self-insured retention (SIR) amounts.

Travelers has the City's liability package, Chubb has the City's property package and Safety National has the Excess Workers Compensation policy coverage on the City's behalf. All of the carriers have extensive experience in public entity insurance coverage and they remain unchanged from the 2015 renewal.

Staff is pleased with the renewal as indicated and recommends its approval as presented.

Attachments *(please list):*

Premium Summary

Recommendation/Suggested Action *(briefly explain):*

Recommendation to authorize the Finance Director to execute the Risk Insurance Program Renewal for the year beginning December 1, 2016.

Premium *summary*

The following is a summary of the insurance carrier premiums quoted and payment plan options:

Carrier/AM Best Rating Coverage Payment Plan	Annualized Expiring Premium	Renewal Premium
Safety National / A+, XIV Workers' Compensation* Annual Pay Plan/ Direct Bill	\$119,906	\$123,235
Chubb / A++, XV Property Annual / Agency Bill	\$165,231	\$175,625
Chubb / A++, XV Inland Marine Annual / Agency Bill	\$6,585	\$7,038
Travelers / A++, XV Crime Annual / Agency Bill	\$1,517	\$1,517
Travelers / A++, XV General Liability* Annual / Agency Bill	\$70,916	\$71,513
Travelers / A++, XV Law Enforcement Liability Annual / Agency Bill	\$24,931	\$28,410
Travelers / A++, XV Public Officials & Employment Practices Liability Annual / Agency Bill	\$42,675	\$44,657
Travelers / A++, XV Automobile Annual / Agency Bill	\$46,811	\$49,551
Travelers / A++, XV Umbrella Annual / Agency Bill	\$64,937	\$65,878
Travelers / A++, XV Cyber Annual / Agency Bill	\$18,833	\$20,095
Agency Service Fee Annual / Agency Bill	\$32,500	\$32,500
Total	\$594,842	\$620,019

* Subject to annual audit

Note: Deposit premiums due upon binding.



AGENDA ITEM EXECUTIVE SUMMARY

Agenda Item number: 6a

Title:	Recommendation to Approve a Resolution Authorizing the Mayor and the City Clerk of the City of St. Charles to Approve the Award of a 2017 Ford F550 XL 4X2 Chassis Cab, and Monroe Truck Equipment Body Modifications, to Zimmerman Ford and Sell Replaced 2003 Ford F-550-4X2 Vehicle #1730
Presenter:	Julie Herr, Assistant Finance Director

Meeting: Government Operations Committee

Date: November 7, 2016

Proposed Cost: \$48,975

Budgeted Amount: \$56,000

Not Budgeted:

Executive Summary (if not budgeted please explain):

We are seeking approval to purchase a new 2017 Ford F550 XL 4X2 Chassis Cab, with body equipment modifications, for use by the Electric Division. The body equipment includes modifying a dump body, dump coal chute, and double acting hoist the City has used in the past for other units.

Prices for the chassis were obtained from Currie Motors, winning bidder through the Suburban Purchasing Cooperative, and from a local vendor, Zimmerman Ford. The following is a summary of the quotes received:

<i>Chassis Quotes:</i>	
Currie Motors (Suburban Purchasing Cooperative)	\$37,937
Zimmerman Ford (Local vendor)	37,604
<i>Body Equipment Quotes:</i>	
Monroe Truck Equipment Body	\$11,371
Sauber Body	20,652

As the local vendor supplied a quote that was lower than the competitively bid Suburban Purchasing Cooperative quote, we would like to award the purchase of the chassis to Zimmerman Ford in the amount of \$37,604 and the body equipment to Monroe Truck Equipment in the amount of \$11,371. This vehicle was originally in the FY17/18 budget and due to mechanical issues, was moved to the current FY budget. This vehicle was approved by the City Fleet Committee. Finally, we are seeking approval to sell the replaced 2003 Ford F-550-4X2, Vehicle #1730, via the online auction site.

Attachments (please list):

Quote and Resolution

Recommendation/Suggested Action (briefly explain):

Recommendation to approve a Resolution Authorizing the Mayor and the City Clerk of the City of St. Charles to Approve the Award of a 2017 Ford F550 XL 4X2 Chassis Cab, and Monroe Truck Equipment Body Modifications, to Zimmerman Ford and Sell Replaced 2003 Ford F-550-4X2 Vehicle #1730.



1730

EL2002

2525 East Main Street • St. Charles, IL 60174 • Phone: 630-584-1800 • Fax: 630-584-9886

Mike Shortall
Purchasing Director
City of St Charles

Specifications for 2017 Ford F550 XL 4x2 Chassis Cab

- | | |
|---|----------------------------------|
| 6.8L V10 sohc engine | 6-speed automatic w/select shift |
| 4 wheel disc brakes with ABS | Black painted front bumper |
| Black molded grill | 40 gallon aft axle fuel tank |
| Tinted glass | Front mud flaps |
| Black front fender wheel opening moldings | Front tow hooks (2) |
| 19.5" Argent painted steel wheels | intermittent wipers |
| 2.3" IP cluster productivity screen | (2) 12V power point |
| Air conditioning | Black vinyl floor covering |
| 40/20/40 vinyl front bench seat | Power steering |
| Tilt/telescoping steering column | Upfitter switches (6) |
| Advance trac with RSC | LED roof clearance lights |
| Front, side & curtain airbags | telescoping trailer tow mirrors |
| Automatic headlamps | HD 240 amp alternator |
| AM/FM radio | Stabilizer bars Front & rear |
| Map lights | HD gas shocks |
| 750 CCA battery | 225/70Rx19.5 all season tires |

SALE PRICE \$30,980

OPTIONAL EQUIPMENT

- | | |
|-----------------------------------|------|
| ___ 4X4 with manual transfer case | 2750 |
| ___ Cloth 40/20/40 bench seat | 92 |
| ___ Limited slip rear axle | 332 |
| ___ Power equipment group | 841 |

<input type="checkbox"/> Snow plow prep package	79
<input type="checkbox"/> Electric brake controller	250
<input type="checkbox"/> Back up alarm	128
<input type="checkbox"/> Molded black cab steps	295
<input type="checkbox"/> Sync 3 system (Bluetooth)	336
<input type="checkbox"/> Daytime running lights	41
<input type="checkbox"/> XL value package	663
<input type="checkbox"/> Upfitter interface module	272
<input type="checkbox"/> Transmission PTO provision	257
<input type="checkbox"/> Rubber all weather molded tray style mats	75
<input type="checkbox"/> Municipal license & title	128
<input type="checkbox"/> Extra PATS key without remote entry	85

TOTAL

\$37604

WARRANTY

Bumper to bumper	3 years/36000 miles
Powertrain	5 years/60000 miles
Diesel engine	5 years/100000 miles
Corrosion perforation	5 years/unlimited miles

Please call me with any questions

Bill Wackerlin

Commercial sales



Fol 1730

EL 2002

ALL NEW
2017 FORD F-550
XL 4X2 CHASSIS CAB
Contract# 146



Currie Motors Fleet

“Nice People To Do Business With”

Your Full-Line Municipal Dealer
www.CurrieFleet.com

Production Starts 8/15/2016
GOOD THRU: March 17, 2017
(2016 Chassis In Stock)





Currie Motors Frankfort

SPC Contract Winner

ALL NEW

2017 FORD F-550

XL 4x2 CHASSIS CAB

Call Tom Sullivan (815) 464-9200

Standard Package: \$29,878.00

Warranty 3 Years 36, 000 miles Bumper to Bumper/ 5 Years 60,000 Power train

6.8L 3 Valve Gasoline SOHC V-10
6-Speed Automatic w/ Select Shift
4-Wheel Disc Brakes
Front Black Painted Bumpers
Solar Tint Glass
Front Splash Guards
3-Blink Lane Change Signal
Front Tow Hooks
19.5" Argent Steel Wheels
4 - LT225/70Rx19.5GBSW Tires
240 Amp Heavy Duty Alternator
Oil minder System
Mono-Beam Front Axle w. coil
spring suspension

H.D. Gas Shock Absorbers
Front/Rear Stabilizers
Air Conditioner – Manual
Dome Lamp
AM/FM/Clock
Manual Door Locks & Windows
Intermittent Windshield Wiper
Advance Trac with Roll Stability
Control
Driver and Passenger Front & Side
Airbag/Curtain
Passenger Side Deactivation Switch
Free delivery within 50 miles of
dealership

Production Starts 8/15/2016
GOOD THRU: **03/17/2017**
(2016 Chassis In Stock)



Options – Body Style

<input type="checkbox"/>	Super Cab 60" Cab to Axle	2370.00
<input type="checkbox"/>	Crew Cab 60" Cab to Axle	3440.00
<input type="checkbox"/>	84" Cab to Axle Super/Crew Cab	262.00

Options – Engine, Transmission, Powertrain

<input checked="" type="checkbox"/>	6.8L V-10 with 6-speed Automatic (Includes Gaseous Prep)	N/C
<input type="checkbox"/>	6.7L OHV Power Stroke Diesel with 6 Speed Automatic	7908.00
<input checked="" type="checkbox"/>	4x4 with Manual Transfer Case	2875.00
<input checked="" type="checkbox"/>	Limited Slip Axle	332.00
<input checked="" type="checkbox"/>	62R PTO Provision	239.00
<input type="checkbox"/>	213 Electronic Shift On the Fly 4x4 (N/A with 6.8L Engine, Requires 4x4 with manual transfer case)	158.00
<input type="checkbox"/>	41H Engine Block Heater	64.00
<input type="checkbox"/>	Engine Idle Shut Down	231.00
<input type="checkbox"/>	67B Dual Extra Duty Alternators (requires Diesel Motor)	105.00
<input type="checkbox"/>	98R Operator Command Regeneration (requires Diesel Motor)	231.00
<input type="checkbox"/>	65M 28.5 Gallon Mid Ship Tank	115.00
<input type="checkbox"/>	65C Dual Tanks (Requires Diesel Motor)	575.00
<input type="checkbox"/>	Powertrain Care 3 Year 100,000 Warranty 4x2 Gasoline Motor	1,595.00
<input type="checkbox"/>	Powertrain Care 3 Year 100,000 Warranty 4x4 Gasoline Motor with Snow Plow Prep	2,750.00

Options – Wheels/Tires

<input type="checkbox"/>	TFB LT225/70Rx19.5G BSW A/S	STD
<input type="checkbox"/>	THB LT225/70Rx19.5G BSW Traction	175.00
<input type="checkbox"/>	TBM LT225/70Rx19.5G BSW Max Traction	197.00
<input type="checkbox"/>	512 Spare Tire and Wheel	272.00
<input type="checkbox"/>	945 Stainless Steel Wheel Covers	377.00

Options - Functional

<input type="checkbox"/>	63C AFT-Axle Frame Extension (Regular Cab Only)	105.00
<input type="checkbox"/>	41P Skid Plates	92.00
<input type="checkbox"/>	61J Jack – 6 Ton	51.00
<input type="checkbox"/>	43B Rear Defroster (requires privacy glass)	56.00
<input type="checkbox"/>	924 Privacy Glass	27.00

Options - Groups/Packages

<input checked="" type="checkbox"/>	96V XL Value Package ▪ Cruise Control ▪ AM/FM/CD/Clock	663.00
<input type="checkbox"/>	68M Payload Upgrade Package (Requires Diesel Motor and Limited Slip Axle)	1063.00



<input type="checkbox"/> 535	High Capacity Trailer Tow Package (Requires Payload Upgrade Pkg)	993.00
<input checked="" type="checkbox"/> 90L	Power Equipment Group <ul style="list-style-type: none"> ▪ Heated power mirrors with integrated clearance lamps/turn signals ▪ Perimeter Alarm ▪ Accessory Delay ▪ Power Windows/Locks/Tailgate Lock ▪ Remote Keyless ▪ Upgraded door trim 	<input checked="" type="checkbox"/> Regular Cab: 841.00 <input type="checkbox"/> Crew/Super: 1035.00
<input checked="" type="checkbox"/> 473	Snow Plow Prep Package <ul style="list-style-type: none"> ▪ Upgraded Front Springs ▪ Extra Heavy-Duty Alternator 	79.00
<input type="checkbox"/> 67H	Heavy Service Front Suspension – Heavy Service Front Springs	115.00

Options – Interior

<input type="checkbox"/> 43L	110V/400W Outlet	69.00
<input type="checkbox"/> 41A	Rapid Heat Supplemental Cab Heater (requires Diesel Motor)	231.00
<input checked="" type="checkbox"/> 18A	Upfitter Interface Module	272.00
<input type="checkbox"/> 76Z	Advanced Security Pack <ul style="list-style-type: none"> ▪ Securilock ▪ Passive Anti-Theft ▪ Inclination/Intrusion Sensors 	56.00
<input type="checkbox"/> 63A	Utility Lighting System (Requires Power Equipment Group)	148.00
<input checked="" type="checkbox"/> 18B	Platform Running Boards	<input checked="" type="checkbox"/> Regular Cab 295.00 <input type="checkbox"/> Super / Crew Cab 341.00

Options – Exterior

<input type="checkbox"/> 872	Rearview Camera Prep Kit – Displays in Rearview Mirror (Requires XL Value Package)	381.00
<input type="checkbox"/> 76J	Remote Start (Requires Power Equipment Group)	180.00
<input type="checkbox"/> 76R	Reverse Sensing System	225.00
<input checked="" type="checkbox"/> 91M	SYNC System	336.00
<input checked="" type="checkbox"/> 913	SYNC3 (Requires Ultimate Tow Camera)	105.00

Options – Fleet

<input type="checkbox"/> 17F	XL Décor Group	203.00
<input type="checkbox"/>	A/C Delete (N/A with Power Equipment Group)	-726.00
<input type="checkbox"/> 525	Cruise Control	216.00
<input checked="" type="checkbox"/> 942	Daytime Running Lights	41.00
<input type="checkbox"/> 556	Driver Passenger Side Airbags/Curtain Delete	-180.00
<input type="checkbox"/> 557	Front Passenger & Side Airbags/Curtains Delete	-180.00



<input type="checkbox"/>	585	AM/FM/CD	253.00
<input type="checkbox"/>	87T	Ford Telematics	736.00

Options – Accessories

<input type="checkbox"/>	52R	Stow / Load Ramps	736.00
<input checked="" type="checkbox"/>	91S	LED Warning Strobes (Requires CHMSL)	603.00
<input checked="" type="checkbox"/>	76C	Back Up Alarm	128.00
<input checked="" type="checkbox"/>		Rustproofing & Undercoating	395.00
<input checked="" type="checkbox"/>		4 Corner Strobes (Requires Upfitter Switches)	795.00
<input type="checkbox"/>		9' Electric Hydraulic Dump Body – Black Finish (Requires hitch plate)	6,895.00
<input type="checkbox"/>		9' Steel Service Body – White Finish	7,185.00
<input type="checkbox"/>		8'6" Western Snow Plow	5,095.00
<input type="checkbox"/>		8'6" Boss Snow Plow	5,095.00
<input type="checkbox"/>		Hand Held Controller (Requires Plow)	90.00
<input type="checkbox"/>		Snow Deflector	295.00
<input type="checkbox"/>		Detailed CD Rom Shop Manual	325.00
<input checked="" type="checkbox"/>		Delivery More than 50 Miles	185.00
<input checked="" type="checkbox"/>		License & Title – M Plates	103.00

Exterior

<input type="checkbox"/>	Race Red	
<input type="checkbox"/>	Blue Jeans Metallic	
<input type="checkbox"/>	Caribou	
<input type="checkbox"/>	Shadow Black	
<input type="checkbox"/>	Magnetic	
<input type="checkbox"/>	Ingot Silver Metallic	
<input checked="" type="checkbox"/>	Oxford White	
<input type="checkbox"/>	Special Paint (minimum 5 units. No minimum for School Bus Yellow)	612.00

Interior

<input type="checkbox"/>	Steel 40/20/40 Vinyl	STD
<input checked="" type="checkbox"/>	Steel 40/20/40 Cloth	92.00
<input type="checkbox"/>	Steel 40/Console/40 Vinyl-No Armrest Included (Regular Cab Only)	327.00
<input type="checkbox"/>	Steel 40/Console/40 Cloth- No Armrest Included	473.00

RUBBER ALL WEATHER MATS \$75

\$ 37,937



Please enter the following:

Agency Name & Address

Contact Name

Phone Number

Purchase Order Number

Fleet Identification Number

Tax Exempt Number

Total Dollar Amount

Total Number of Units

Delivery Address

Please submit P.O. & tax exempt letter with Vehicle Order:

*Currie Motors
9423 W. Lincoln Hwy
Frankfort, IL 60423
PHONE: (815)464-9200 FAX: (815) 464-7500
CurrieFleet@gmail.com
Contact Person: Tom Sullivan or Liz Quinn*

IF WE HAVE MISSED AN OPTON, PLEASE CONTACT OUR OFFICE.
COMPLETE UNITS IN STOCK FOR IMMEDIATE DELIVERY, CAN BE VIEWED
ON OUR WEBSITE WWW.CURRIEFLEET.COM



QUOTATION
 Monroe Truck Equipment
 1051 W 7th Street
 Monroe, WI 53566
 Phone: 608-329-8383
 Fax: 608-329-8521
 Email: treynolds@monroetruck.com
 www.monroetruck.com

Quote Number: 9TRR001169
 Job Order Number:
 Quote Date: 10/6/2016
 Quote valid until: 11/5/2016
 Terms: NET 30
 Salesperson: PETRIZZO, PETE
 Quoted By: Tim Reynolds

Customer: ST CHARLES,CITY OF, (6948710)
 ATTN: ACCOUNTS PAYABLE
 ST CHARLES, IL 60174

Contact: accounts payable@stcharlesil.go
 Phone: 630-377-4421 Fax: 630-377-4487
 Email:

Dealer Code: _____

P.O. Number: _____

REASSIGN (Required for pool units): Fleet Retail

MSO/MCO (ONLY check if legally required): MSO MCO

Accepted by: _____
Customer must fill out the information above before the order can be processed.

Date: _____

Chassis Information

Year: 2017	Make: FORD	Model: F-550	Chassis Color:	Cab Type: REGULAR
Single/Dual: DRW	CA: 60.0	CT: -1.0	F.O. Number #:	Vin:
		Wheelbase: 145.0		

Comments:

Monroe Truck Equipment, Inc. is pleased to offer the following quote for your review:

DESCRIPTION	AMOUNT	
MTE-ZEE 9', MILD STEEL, 3-4 YD CAPACITY, RIGID SIDE, DUMP BODY		
- 10 GA. FLOOR, 10 GA. SIDES & ENDS, 16" H SIDES, 22" H TAILGATE		
- 50,000 PSI YIELD HIGH-STRENGTH STEEL CONSTRUCTION & FLOOR		
- HEAVY DUTY FRONT BULKHEAD WITH INTEGRAL 12" TAPERED CAB SHIELD & TAPERED LASER CUT WINDOW		
- INTERNAL DIRT SHEDDING TOP RAILS & TAILGATE		
- WESTERN-STYLE UNDERSTRUCTURE WITH 10 GAUGE LONG-MEMBERS		
- SINGLE-LEVER RELEASE, QUICK DROP TAILGATE		
- L.E.D. FMVSS108 LIGHTS & REFLECTORS		
- RUBBER REAR FLAPS		
- UNDERCOATED & 100% DURABLE POWDER COATED		
DOUBLE ACTING ELECTRIC HOIST		
- SUBFRAME WITH HINGE		
- PUSH BUTTON CONTROL IN CAB		
TOWING:		
- 2-1/2" RECEIVER IN 1/2" PLATE		
* 1800 TONGUE CAPACITY / 18,000 TOWING CAPACITY		
- 7 WAY RV STYLE TRAILER PLUG		
Quote Total:	\$7,792.00	
Additional Options:		
DESCRIPTION	AMOUNT	ADD TO QUOTE
STAINLESS BODY IN LIEU OF MILD STEEL	\$2,711.00	Yes / No
- 10 GA. AR-235 (ABRASIVE RESISTANCE), 65,000 PSI YIELD HIGH-STRENGTH FLOOR		
- 10 GA. SIDES & ENDS, 16" H SIDES, 22" H TAILGATE		
COAL CHUTE ROTARY STYLE	\$868.00	Yes / No

Notes:

- ◆ Terms are Due Upon Receipt unless prior credit arrangements are made at the time of order.
- ◆ Please note if chassis is furnished, it is as a convenience and terms are Net Due on Receipt of Chassis.
- ◆ State and Federal taxes will be added where applicable. **Out-of-state municipal entities may be subject to Wisconsin sales tax.**
- ◆ Restocking fees may be applicable for cancelled orders.

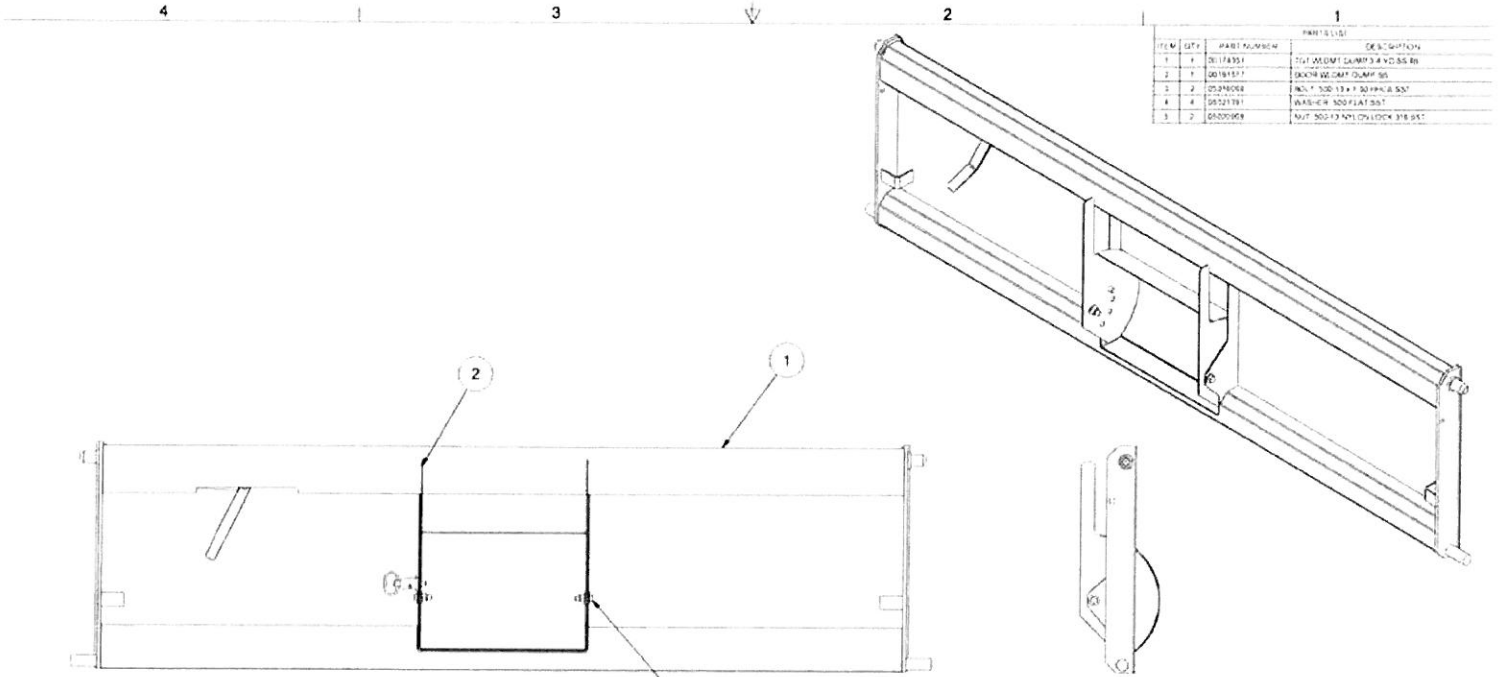

ITEM	QTY	PART NUMBER	DESCRIPTION
1	1	0114351	TGT DUMP CLAMP 3-4 YD SS 4B
2	1	02181571	SLKTR W/ CLAMP CLAMP SS
3	2	02396008	NUT 1/2" X 1-1/2" X 30 PHEN A SS*
4	4	05221191	WASHER 300 FLAT SS*
5	2	05220909	NUT 3/8" X 1/2" X 1/2" LOCK 316 SS*

• REMOVE ALL BURRS AND SHARP EDGES
 • DIMENSIONS SHOWN IN () ARE REFERENCE ONLY

RELEASED PR # 10953		MCF	SSD	8/31/2016	0	<table border="1"> <tr> <td>TITLE</td> <td>DESIGN</td> <td>DATE</td> </tr> <tr> <td>DRAWN BY</td> <td>MCF</td> <td>8/31/2016</td> </tr> <tr> <td>CHECKED BY</td> <td>SSD</td> <td>8/31/2016</td> </tr> </table>		TITLE	DESIGN	DATE	DRAWN BY	MCF	8/31/2016	CHECKED BY	SSD	8/31/2016			1051 West 7th Street Monroe, WI 53906-9100 608-328-6127	
TITLE	DESIGN	DATE																		
DRAWN BY	MCF	8/31/2016																		
CHECKED BY	SSD	8/31/2016																		
REVISION		INITIALS	DATE	0	<table border="1"> <tr> <td>SOFT</td> <td>LBS 182</td> </tr> <tr> <td>FINISH</td> <td>A</td> </tr> </table>		SOFT	LBS 182	FINISH	A	TGT ASSY, DUMP 3-4 YD, SS, 4B MTE-ZEE, COAL CHUTE		00174356							
SOFT	LBS 182																			
FINISH	A																			
					2	B	1	1" = 1"	1 of 1											



10 North Sauber Road
Virgil, IL 60151-1000
SAUBERMFG.COM
Phone 630.365.6600 Fax 630.365.6610

Sales Quote

Sales Quote Number: SQ107658
Date: 03/17/16
Page: 1

Sell

To: City of St. Charles
Mike Shortall
Accounts Payable
2 East Main Street
St. Charles, IL 60174-1984

Shipping

To: City of St. Charles
Mike Shortall
Accounts Payable
2 East Main Street
St. Charles, IL 60174-1984

Ship Via Customer Pickup
Terms Net 30 Days
FOB Origin

Customer ID C00011
SalesPerson Chuck Herrmann

Item No.	Description	Unit	Quantity	Unit Price	Total Price
17766	Custom 2-Yd Dump Bed Installation Model Dxxxxx - S/N D SXXXXSAL.SLDDRW 3/16" Smooth Steel Bolt-On Floor 4"x5.4 #/Ft Perimeter 4"x5.4 #/Ft Cross Sills on 12" Centers 8"x11.5 #/Ft Long Sills 16"H 10 Gauge Dump Sides w/ Provision for c/p Board Pockets for 2"x6" w/ 3/8" Bolt Hole Each End 16"H Double Acting Tailgate w/ Hinges Top & Bottom w/ Air Actuated Control Cab Height Bulkhead w/ 1/2 Cab Shield w/ 10"x22" Expanded Metal Window Sealed Beam LED Lighting Installation, Flaps & Modesty Panel XXX"L x XX"W Overall Galvanized Torque Mounting Bolts & Check Fuel Fill New Vehicle Certification Sticker 12347 Completed Equipment Placard Warranty Parts & Labor Sauber Manufactured Items - 5 Year Hydraulic Systems & Hoist - 1 Year Galvanized Finish - 5 Year	Each	1	20,652.00	20,652.00
#OPM	Plexiglass Window Cover	Each	1		
Z1403	96"W Dump - Per Foot	Foot	8		
18876	Stainless Steel Shovel Holder	Each	1		
	Spring Loaded Mechanism Holds Round Handled Tools				
R1010	Install RS	Hour	0.5		
Z1411	Dump Coal Chute Door w/ Overcenter Handle and Vertically Actuated Door w/ Ratchet, Gravity Actuated Position Latch 9"H x 15"W Nominal w/ 1/4" Door - Centered	Each	1		
Z1195	ICC Bumper w/ 10" Treadgrip Step Overlay Each Side - 5/16" Formed - Bolt on Galv Refer to 6921ST	Each	1		



10 North Sauber Road
Virgil, IL 60151-1000

SAUBERMFG.COM

Phone 630.365.6600

Fax 630.365.6610

Sales Quote

Sales Quote Number: SQ107658

Date: 03/17/16

Page: 2

Item No.	Description	Unit	Quantity	Unit Price	Total Price
Z1217	2" Hitch Receiver Installation 15,000# Max Trailer GVWR; 2500# MVL D-Rings & 3/16" Breakaway Retainer Loop XX" Aproximate Hitch Height Refer to S2604.SLDDRW - Bumper Mount - 8.5"W Refer to 6921ST - ICC Mount 3/16" Welded Loop to Retain Breakaway	Each	1		
#OTV R1010	HL39B Single Wheel Fender w/KIT3 Install Fenders	Each Hour	1 2		
17820	Class 20 Dump Hoist - Electric 5" Bore x 16" Stroke w/ Subframe Double Acting Cylinder - 5.75" Mounting Height 3000/1000 PSI w/ Safety Prop Electric Hydraulic Pump & 4-Quart Reservoir	Each	1		
Z1272	Dump Hoist Installation Includes Controls & Std Dump Hydraulics 41-45 Degree Dump Hoist Angle Permitted Plant to Return As Built Information Here & Provide In Cab Placard Below ____ # Capacity @ ____-Degree Angle	Each	1		
10020	AW32 Hydraulic Fluid	Quart	5		
Z1215	Truck/Trailer Socket Installation 11119 7-Way SAE Socket Installed & Wired LS	Each	1		
Z1290	97 Db Backup Alarm Installation w/ 13777 Backup Alarm - 97 Decibel	Each	1		
#OTV 16624	2x6 Bang Boards Installed Aluminum Tool Box w/ Single Door 36"Lx21"Dx24"H - .100" AL Treadplate - Tig Welded 2787ST - Bottom Hinge 10800 Wide Flange Latch Door Chains For Bottom Hinge Hat Reinforcement - AL Drop (2) Drain Holes in Opposite Corners Stainless Steel Bolts w/ Lock Nuts 10682/13330 Chrome Plated Hinges Automotive Type Bubble Sealer Stainless Steel Low Profile SMC Striker 16443 Diamond Plate Vinyl Mat Lining	Each Units	2 2,124		
Z1271	Underbody Tool Box Installation Includes Brackets, Fasteners, (2) 10402 Rubber Compartment Drains - 1446ST & Installation Isolated Rubber Mount	Each	1		
8500	All Weather Wheel Chock	Each	2		
8505-A	Underbody Almag Chock Holder-4958ST	Each	2		
Z1336	Installation of Wheel Chocks/Holders	Each	2		



10 North Sauber Road
Virgil, IL 60151-1000
SAUBERMFG.COM

Phone 630.365.6600

Fax 630.365.6610

Sales Quote

Sales Quote Number: SQ107658

Date: 03/17/16

Page: 3

Item No.	Description	Unit	Quantity	Unit Price	Total Price
17263	Hi Intensity Directional LED-Amber 12VDC .3A; 9 Flash Patterns; SAE Class1 5-Yr Warranty	Each	8		
Z1428	Wire Above to Upfitter's Switch w/ Wiring, Placard & Contactor as Required Wire Hot	Each	1		
R1010	Label: "Strobes" Installation Of Strobes (2) Rear Recessed Under Tailgate (2) Rear Cab Protector Facing Rear (2) Front Cab Protector Facing Forward (2) Front Grill	Hour	3		
18826	Model 3410 LED Safety Director 3A; 9 Flash Patterns	Each	1		
18823	Model 3410 Cord 35'	Each	1		
18825	Model 3410 Control Box 5.9"W x 3.6"D (w/ Stand) x 4.6"H	Each	1		
#OPM	Safety Director Cover	Each	1		
R1010	Mount on Rear Edge Of Cab Protector	Hour	2		
18427	Inverted Cone Holder - Galv Formed Rod Style; Carries Cone Side Down S1339.SLDDRW	Each	1		
Z1299	Installation	Each	1		
12216	3-Rung Stowaway Step - S2076 14.5"W x 28.75"L - Galv w/Horizontal Retaining Strap	Each	1		
Z1389	Bulkhead Grab Handle - 12"L x 3/4"Dia LS Bulkhead - 3680ST	Each	1		
R1010	Install LS	Hour	1		
17727	GoLight Wireless Remote Spotlight White - 370° Rotation x 135° Tilt; 5.5A Waterproof w/ Dash Mounted Remote	Each	1		
R1010	Install RF Corner Cab Protector	Hour	2		
#OPM	GoLight Mounting Plate	Each	1		
12643	5# Ansul Fire Extinguisher w/ Included Vehicle Bracket	Each	1		
R1010	Install	Hour	0.5		
12260	Three Triangle Reflector Kit Loose In Cab	Each	1		
Z1295	Customer Approval Drawing @ Order	Each	1		

Total Before Tax:

20,652.00



**City of St. Charles, Illinois
Resolution No. _____**

A Resolution Authorizing the Mayor and the City Clerk of the City of St. Charles to Approve the Award of a 2017 Ford F550 XL 4X2 Chassis Cab, and Monroe Truck Equipment Body Modifications, to Zimmerman Ford and Sell Replaced 2003 Ford F-550-4X2 Vehicle #1730

**Presented & Passed by the
City Council on _____, 2016**

BE IT RESOLVED by the Mayor and City Council of the City of St. Charles, Kane and DuPage Counties, Illinois, that the Mayor and City Clerk be and the same are hereby authorized to approve the award of a 2017 Ford F550 XL 4X2 Chassis Cab, and Monroe Truck Equipment Body Modifications, to Zimmerman Ford and Sell Replaced 2003 Ford F-550-4X2 Vehicle #1730.

PRESENTED to the City Council of the City of St. Charles, Illinois,
this _____ day of November, 2016

PASSED by the City Council of the City of St. Charles, Illinois this _____ day of
November, 2016

APPROVED by the Mayor of the City of St. Charles, Illinois, this _____ day of
November, 2016

Raymond P. Rogina, Mayor

ATTEST:

City Clerk

COUNCIL VOTE:

Ayes:

Nays:

Absent:

Abstain:

**AGENDA ITEM EXECUTIVE SUMMARY**

Agenda Item number: 6b

Title:

Recommendation to Approve an Ordinance Authorizing the Sale of Items of Personal Property Owned by the City of St. Charles

Presenter:

Julie Herr, Assistant Finance Director

Meeting: Government Operations Committee

Date: November 7, 2016

Proposed Cost: \$

Budgeted Amount: \$

Not Budgeted: **Executive Summary** (if not budgeted please explain):

We are asking for approval to sell the following items to the highest respective bidders:

- DiamondBack truck bed cover
- Two arrow boards
- One lot of pvc. pipe fittings
- One lot of Motorola radios
- Paint sprayer
- Two reels of wire
- 1995 Towmaster T10P trailer (Vehicle 2177)
- 1994 Keysp 14loadr trailer (Vehicle 2125)
- 1992 Homemade trailer TD115873 (Vehicle 2145)
- 1987 Gormn pump (Vehicle 2142)
- 1988 Gormn pump (Vehicle 1872)
- 2007 John Deere 1445 & attachments (Vehicle 1822)
- 1996 Toro pro grind tub grinder serial #-34741773 (Vehicle 1706)
- 2011 Kubot Green-Machine serial#-636-812488 (Vehicle 1817)
- 1999 Saturn SL2 (Police Seized Vehicle)
- 1995 Jeep Cherokee (Police Seized Vehicle)
- 2001 Volkswagen Jetta (Police Seized Vehicle)
- 2006 Subaru WRX (Police Seized Vehicle)
- 1996 Chevrolet Blazer (Police Seized Vehicle)

Items may be sold via on-line bids, PublicSurplus.com.

Attachments (please list):

Ordinance

Recommendation/Suggested Action (briefly explain):

Recommendation to approve an Ordinance Authorizing the Sale of Items of Personal Property Owned by the City of St. Charles.

City of St. Charles, Illinois
Ordinance No. _____

**An Ordinance Authorizing the Sale of Items of Personal
Property Owned by the City of St. Charles**

WHEREAS, in the opinion of at least three-fourths of the Corporate authorities of the City of St. Charles, it is no longer necessary or useful to or for the best interest of the City of St. Charles to retain the personal property now owned by the City of St. Charles and hereinafter;

NOW, THEREFORE, BE IT RESOLVED by the City Council of the City of St. Charles, Kane and DuPage Counties, Illinois as follows:

1. Pursuant to Illinois Compiled Statutes, 65ILCS 5/11-76-4, the City Council finds that the following personal property now owned by the City of St. Charles is no longer necessary or useful to the City of St. Charles and the best interests of the City of St. Charles will be served by its sale:

- DiamondBack truck bed cover
- Two arrow boards
- One lot of pvc. pipe fittings
- One lot of Motorola radios
- Paint sprayer
- Two reels of wire
- 1995 Towmaster T10P trailer (Vehicle 2177)
- 1994 Keysp 14loadr trailer (Vehicle 2125)
- 1992 Homemade trailer TD115873 (Vehicle 2145)
- 1987 Gormn pump (Vehicle 2142)
- 1988 Gormn pump (Vehicle 1872)
- 2007 John Deere 1445 & attachments (Vehicle 1822)
- 1996 Toro pro grind tub grinder serial #-34741773 (Vehicle 1706)
- 2011 Kubot Green-Machine serial#-636-812488 (Vehicle 1817)
- 1999 Saturn SL2
- 1995 Jeep Cherokee
- 2001 Volkswagen Jetta
- 2006 Subaru WRX
- 1996 Chevrolet Blazer

2. Pursuant to said Section 65ILCS 5/11-76-4, the Purchasing and Inventory Control Division Manager be, and he is hereby authorized and directed to sell the foregoing described personal property now owned by the City of St. Charles to: the highest respective bidder.

Presented to the City Council of the City of St. Charles, Illinois, this _____ day of November, 2016.

Ordinance _____

Page _____

Passed by the City Council of the City of St. Charles, Illinois, this _____ day of November, 2016.

Approved by the Mayor of the City of St. Charles, Illinois, this _____ day of November, 2016.

Raymond P. Rogina, Mayor

Attest:

Nancy Garrison, City Clerk

Council Vote:

Ayes: _____

Nays: _____

Absent: _____

Abstain: _____



AGENDA ITEM EXECUTIVE SUMMARY

Agenda Item number: 6c

Title:	Recommendation to Approve a Resolution Authorizing the Mayor and the City Clerk of the City of St. Charles to Approve the Award of an International Chassis Cab, with Monroe Truck Equipment Body Modifications, to Rush Truck Centers and Sell Replaced 2006 IHC 4300 Vehicle #1701
Presenter:	Julie Herr, Assistant Finance Director

Meeting: Government Operations Committee

Date: November 7, 2016

Proposed Cost: \$192,312

Budgeted Amount: \$180,000

Not Budgeted:

Executive Summary (if not budgeted please explain):

We are seeking approval to purchase a new International Chassis Cab, with Monroe Truck Equipment Body modifications, for use by Public Services' Street staff, from Rush Truck Centers (State of Illinois Joint purchase Fleet Sales Program). The bid and quote include modifying a body, rear axle, PTO, transmission, and plow the City has used in the past for other units.

Rush Truck Centers, official State of Illinois Joint purchase Fleet Sales Program (bid) With Monroe Truck Equipment Body	\$192,312

We would like to award Rush Truck Centers the bid of \$192,312. This vehicle was budgeted and approved in the FY16/17 budget year and approved by the City Fleet Committee. We are also seeking approval to sell the replaced 2006 IHC 4300 Vehicle #1701 via the online auction site.

Attachments (please list):

Quote and Resolution

Recommendation/Suggested Action (briefly explain):

Recommendation to approve a Resolution Authorizing the Mayor and the City Clerk of the City of St. Charles to Approve the Award of an International Chassis Cab, with Monroe Truck Equipment Body Modifications, to Rush Truck Centers and Sell Replaced 2006 IHC 4300 Vehicle #1701.



**New Truck Proposal
Tandem Axle Dump Truck Specifications
State of Illinois Solicitation # 227888 - Contract # PSD4018132**

Mike Shortall
 CONTACT NAME
 City of St Charles
 BUYER INFORMATION
 2 East Main Street
 ADDRESS
 St Charles, IL 60174
 CITY/ STATE/ ZIP
 630-377-4471 phone mshortall@stcharlesil.gov
 PHONE/ FAX/ EMAIL
 FEIN # / TAX EXEMPT # / COUNTY

DATE: 10/20/16

Contact: Kevin Burdell
 Municipal Fleet Sales
 3441 Gatlin Drive Springfield, IL 62707
 Ofc: 217-718-2217
 Email: BurdellK@rushenterprises.com

Please Circle Cab Color:
 Red-2303 / IDOT Orange / Omaha Orange
 School Bus Yellow / Blue 6800 / Blue Met-6E12
 Green-5047 / White / Black

2017 INTERNATIONAL 7400 SFA 6x4 / 179" WHEELBASE/ 104" CAB TO TRUNNION
 120,000 PSI/ 2,654,000 RBM single frame rail w/ 20" front frame extension
N10 310HP/ 1050# TORQUE w/ GRID HEATER
 3000RDS Allison Six (6) speed trans. w/ T-Handle & External Trans. Cooler
 Extended Life Oil Pan/ Transmission TCM mounted inside cab
 Transmission temp. gauge/ Hour meter/ Plow light Switch
 Warning Lights & Alarm for Low Coolant, Low Oil PSI, Engine Temp.
 "Winter/Summer" Air Cleaner w/ In-Dash Filter Minder
 Horton Two-Speed Fan Drive/ Front Engine PTO/ Block Heater
16,000# Front axle & suspension with 2000# Aux / HD shocks / Fender extensions
40,000# Rear axle w/ Hendrickson HMX 400-52 susp. & HD shocks/ SPL drivelines
 Air Brakes w/ 13.2 compressor/ Bendix air dryer/ DV2 Heated drain valve
 Automatic slack adjusters/ Oil bath wheel seals/ Stationary front grille
 Trailer brake package w/ 7-way ABS trailer plug/ Bodybuilder wires @ BOC
 Tilt & Telescoping steering / Leece-Neville 190 amp alternator/ Delco starter
 100 gallon 26" diameter alum fuel tank (driver side) w/ fuel water seperator
 9.5 gallon DEF Tank mounted driver side
 Three (3) Batteries @ 1950 CCA w/ battery box mounted right side BOC
 Horizontal muffler mounted under cab w/ vert. exhaust pipe & 36" turn out
 Air horn/ Jump start stud/ L.E.D. cab marker lights/ Air ride cab
 AM/FM/Weatherband radio/ Air conditioning/ Cigar lighter
 Black heated mirrors w/ Black heated fender mounted convex mirrors
 Air ride driver seat with arm rest/ Fixed passenger seat/ Daytime lights
 315/80R22.5 Continental (20PLY) steer tires w/ Gray powder coat wheels
 11R22.5 Continental (14PLY) drive tires w/ Gray powder coat wheels

Sales price \$84,573.00
 Options \$2,256.00
 Body price \$105,380.00
 Freight \$0.00
 Sub-total \$192,209.00
 Trade
 License/ Title \$103.00
 Total \$192,312.00

Cummins ISL9 330hp / 1000 torque	\$	-
185" WB / 110" CT	\$	-
Omit Front PTO Adaptor Plate	\$	(141)
Trans Dipstick	\$	49
18K Front Axle/Springs	\$	298
Heated Windshield	\$	523
Cowl Tray Cover	\$	168
Power Windows/Locks	\$	294
70 Gallon Fuel Tank	\$	(98)
6 pack upfitter switches	\$	711
Bright Finish Heated/Power Mirrors	\$	452
Left Side Batt Box / Air Tanks	\$	-

PLEASE CIRCLE DESIRED GEAR RATIO:
 6.14 (67 mph) / 6.43 (64 mph) / 6.83 (60 mph)

Please include copy of tax exempt form w/ your order.
 All prices are F.O.B. Springfield, Illinois
 Payment in full is due at time of delivery.

MV5007 / Unit # 1701

Kevin Burdell- Municipal Fleet Sales Representative

Signature of Buyer Purchase Order Number (if applicable)

Pricing good through 8-2-17



QUOTATION
 Monroe Truck Equipment
 1051 W 7th Street
 Monroe, WI 53566
 Phone: 608-329-8383
 Fax: 608-329-8521
 Email: treynolds@monroetruck.com
 www.monroetruck.com

Quote Number: 9TRR001171
 Job Order Number:
 Quote Date: 10/7/2016
 Quote valid until: 11/6/2016
 Terms: NET 30
 Salesperson: PETRIZZO, PETE
 Quoted By: Tim Reynolds

Customer: ST CHARLES,CITY OF, (6948710)
 ATTN: ACCOUNTS PAYABLE
 ST CHARLES, IL 60174

Contact:
 Phone: 630-377-4421 Fax: 630-377-4487
 Email:

Dealer Code: _____
 P.O. Number: _____

REASSIGN (Required for pool units): Fleet Retail

MSO/MCO (ONLY check if legally required): MSO MCO

Accepted by: _____ Date: _____
Customer must fill out the information above before the order can be processed.

Chassis Information

Year: 2016	Make: INTERNATIONAL	Model: WORK STAR	Chassis Color:	Cab Type: REGULAR
Single/Dual: DRW	CA:	CT: 110.0	F.O. Number #:	Vin: 1HTWHSUT2HH487298

Comments: MV5007 #1701

Monroe Truck Equipment, Inc. is pleased to offer the following quote for your review:

DESCRIPTION	AMOUNT
MONROE 13' RDS BODY, 201SS, DUAL AUGER, REAR DSCHRG - 3/16" STAINLESS STEEL BODY - 1/4" REPLACEABLE FLOOR WITH 3/16" REMOVABLE CHAIN SHIELDS - FORMED AND BOXED TOPRAIL - 1/4" A569 12" DEEP LONGSILLS WITH FORMED CROSSMEMBERS - DUAL AUGER DISCHARGE TO REAR OF BODY - DOUBLE ACTING RECTANGULAR TAILGATE WITH BOXED PERIMETER - 108 LIGHT GROUP ASSEMBLY AND STOP/TURN AND TAIL LIGHTS - BODY PROP - FRONT TELESCOPIC HOIST LESS HYDRAULICS - CAB SHIELD, TANDEM, 100% WELDED - TOP GRATE KIT - STD PINTLE TUBE RECEIVER STYLE SPINNER ASSEMBLY W/POLY DISK - AR400 FLOOR COVER - FRONT & REAR GREASE EXTENSIONS - FULL STAINLESS STEEL FENDERS - BACK-UP ALARM - BODY-UP LIGHT - INSTALLED	
MONROE 540 GALLON PRE-WET SYSTEM - FENDER MOUNTED - (2) 270 GAL POLY TANK WITH STAINLESS STEEL MOUNTING HARDWARE; RDS - ENCLOSURE MTG KIT; STAINLESS STEEL; RDS - CLOSED LOOP HYD PLUMBING KIT; 4 GPM PUMP; FORCE FLOW METER - BULK FILL, CROSS-OVER & FLUSHER KITS - NOZZLE KIT; (2) 2 GPM NOZZLES	
WHELEN ILL DOT 2008 STATE SPEC 72" - 72" JUSTICE LED LIGHT BAR MOUNTED ON ROOF - REAR BODY LED STROBES MOUNTED IN CORNER POST - LED S/T/T MOUNTED IN REAR POST, PINTLE PLATE AND ON TOP OF CAB SHIELD - LED BACK UP LIGHT MOUNTED IN REAR CORNER POST - 2 AMBER AND 1 CLEAR STROBES INSTALLED OUTSIDE THE CORNER POST ON EACH SIDE - SCENE LIGHTS ADDED TO ILLINOIS ILDOT08J LIGHTBAR - 2-YEAR WARRANTY	

DESCRIPTION

AMOUNT

- 13' PULL TARPS ELECTRIC TARP SYSTEM
- ELECTRIC MOTOR AND ARMS(REWINDS TARP)
- HOUSING PROTECTOR
- ASPHALT TARP
- INSTALLED

- PINTLE HOOK W/MOUNTING, 50 TON, TANDEM AXLE
- PREMIER 2200 PINTLE HOOK
- ELECTRIC BRAKE CONTROL (C4500/5500)
- 7-WAY CONNECTOR, ROUND SOCKET, ROUND PIN
- BRIGADE (2) CAMERA SYSTEM WITH WASH SYSTEM

- PTO, HOTSHIFT, ROTATABLE FLANGE; NEW WORLD TRANSMISSION; INSTL
- FORCE AMERICA TXV92-RH W/FITTING KIT
- 5.6 CUBIC INCH 92CC LOAD SENSE
- 24 GPM FLOW @ 1000 RPM
- 5,000 PSI OPERATING PRESSURE
- DIN 5462 - 4 BOLT FLANGE MOUNT
- TANK, 30 GAL. SLIM-LINE, FRAME MOUNT, W/FILTR., STAINLESS, (WING APP.); INSTL
- FORCE ADD-A-FOLD VALVE ASSEMBLY & STAINLESS STEEL ENCLOSURE
- FORCE 6100/IGRIP W/ROAD WATCH DISPLAYED ON CONTROL
- HOIST LIMIT FOR FORCE 6100 CONTROL; LIMITS MAXIMUM RAISED HEIGHT OF BODY
- GPS PRECISE WITH PLOW POSITION SENSOR

- MONROE MPJW-7; 7' MONROE MID-MOUNT PATROL WING
- 7' MOLDBOARD
- QTY 2 - HYDRAULIC LOCK KITS; PREVENTS WING FROM DRIFTING DOWN
- WHELEN WING STROBE

- MONROE MC7090; QUICK HITCH WITH FOLD-FLAT LIFT ARM; TRUCK PORTION
- POSITIVE TWO POINT LATCH SYSTEM
- ADJUSTABLE FOLD-FLAT LIFT ARM
- CYLINDER; 4X10 DA; NITRIDED ROD
- UNIVERSAL 1/2: CHEEK PLATES; MOUNTING SYSTEM FOR TRUCKS WITH FRAME EXTENTIONS
- HOOD MOUNTED BRACKET KIT; PLOW LIGHT; NAVISTAR-WORKSTAR
- PLOW LIGHTS; HELLA; COMPOSITE HOUSING; BLACK
- POWDER COAT BLACK

- MONROE MP41R11-ISCT; FULL MOLDBOARD TRIP REVERSIBLE PLOW; 1650#
- 10 GAUGE ROLL FORMED STRAIGHT MOLDBOARD
- (6) 1/2" X 4" TAPERED, ONE-PIECE FLAME CUT RIBS
- 2" X 3" X 3/8" TOP MOLDBOARD ANGLE
- 4" X 4" X 3/4" BOTTOM MOLDBOARD ANGLE
- HORIZONTAL MOLDBOARD BRACE ANGLES
- 5/8" X 8" ONE-PIECE TOP PUNCH CUTTING EDGE
- DUAL COMPRESSION TRIP SPRING ASSEMBLIES
- 4" X 4" X 3/8" CROSS-TUBE SUPPORT
- 3-1/2" X 3-1/2" X 1/2" SEMI-CIRCLE
- (2) 3" X 10" DOUBLE ACTING POWER REVERSE CYLINDERS WITH CUSHION VALVE
- BUILT-IN MONROE LEVEL LIFT ASSEMBLY
- MOLDBOARD AND PUSHFRAME 100% CONTINUOUSLY WELDED
- MOLDBOARD POWDER COATED ORANGE
- PUSH FRAME POWDER COATED BLACK
- 36" FLUORESCENT ORANGE FLEXIBLE PLASTIC MARKERS, INSTALLED
- SCREW ADJUSTABLE PARK JACK; S&I INSTALLED; 30#
- MONROE MC6000 QUICK HITCH; PLOW PORTION; 175#
- WRAP-AROUND CURB GUARD (EACH), S&I INSTALLED; 20#
- WRAP-AROUND CURB GUARD (EACH), S&I INSTALLED; 20#
- 11' RUBBER SNOW DEFLECTOR, 12", S/I INSTALLED
- MAILBOX CUTOUT ON CURBSIDE ONLY

Quote Total: \$105,380.00

Additional Options:

DESCRIPTION	AMOUNT	ADD TO QUOTE Yes / No
-------------	--------	--------------------------

Notes:

- ◆ Terms are Due Upon Receipt unless prior credit arrangements are made at the time of order.
- ◆ Please note if chassis is furnished, it is as a convenience and terms are Net Due on Receipt of Chassis.
- ◆ State and Federal taxes will be added where applicable. Out-of-state municipal entities may be subject to Wisconsin sales tax.
- ◆ Restocking fees may be applicable for cancelled orders.

**City of St. Charles, Illinois
Resolution No. _____**

A Resolution Authorizing the Mayor and the City Clerk of the City of St. Charles to Approve the Award of an International Chassis Cab, with Monroe Truck Equipment Body Modifications, to Rush Truck Centers and Sell Replaced 2006 IHC 4300 Vehicle #1701

**Presented & Passed by the
City Council on _____, 2016**

BE IT RESOLVED by the Mayor and City Council of the City of St. Charles, Kane and DuPage Counties, Illinois, that the Mayor and City Clerk be and the same are hereby authorized to approve the award of an International Chassis Cab, with Monroe Truck Equipment Body Modifications, to Rush Truck Centers and Sell Replaced 2006 IHC 4300 Vehicle #1701.

PRESENTED to the City Council of the City of St. Charles, Illinois,
this _____ day of November, 2016

PASSED by the City Council of the City of St. Charles, Illinois this _____ day of
November, 2016

APPROVED by the Mayor of the City of St. Charles, Illinois, this _____ day of
November, 2016

Raymond P. Rogina, Mayor

ATTEST:

City Clerk

COUNCIL VOTE:

Ayes:

Nays:

Absent:

Abstain:



AGENDA ITEM EXECUTIVE SUMMARY

Agenda Item number: 6d

Title:	Recommendation to Approve a Resolution Authorizing the Mayor and the City Clerk of the City of St. Charles to Approve the Award of a 2017 Ford E350 Cutaway Van Chassis, with Knapheide KUV Body to Zimmerman Ford and Sell Replaced 2003 Ford E-350 SD Van Vehicle #1802
Presenter:	Julie Herr, Assistant Finance Director

Meeting: Government Operations Committee

Date: November 7, 2016

Proposed Cost: \$36,010

Budgeted Amount: \$35,000

Not Budgeted:

Executive Summary (if not budgeted please explain):

We are seeking approval to purchase a new 2017 Ford E350 Cutaway Van Chassis, with Knapheide KUV Body, for use by Public Works' Water Meter staff, from Zimmerman Ford (Local vendor). When purchasing vehicles, at a minimum we obtain pricing from the Suburban Purchasing Cooperative (SPC), a competitively bid joint purchasing program, as well as a local vendor. In this situation, the type of van needed to accommodate the Knapheide KUV Body was not on the SPC's bid list. However we did request a quote from Currie Motors, the winning bidder for most of the vehicles in SPC's program. We compared that quote to a quote from Zimmerman Ford, a local vendor. The quotes are noted below:

Currie Motors Frankfort, Inc.	\$35,643
Zimmerman Ford Local vendor	36,010

The Zimmerman quote includes a limited slip rear axle (\$249) and rubber floor mats (\$90) that are not included in the Currie Quote.

Based on the above, we would like to request a waiving of the bid procedure as well the awarding of the vehicle purchase to Zimmerman Ford in the amount of \$36,010. This vehicle was budgeted and approved in the F.Y. '16/17 budget year and approved by the City Fleet Committee. We are also seeking approval to sell the replaced 2003 Ford E-350 SD Van Vehicle #1802 via the online auction site.

Attachments (please list):

Request for Waiving Bid Procedure, Quote, and Resolution

Recommendation/Suggested Action (briefly explain):

Recommendation to approve a Resolution Waiving the Bid Procedure and Authorizing the Mayor and the City Clerk of the City of St. Charles to Approve the Award of a 2017 Ford E350 Cutaway Van Chassis, with Knapheide KUV Body to Zimmerman Ford and Sell Replaced 2003 Ford E-350 SD Van Vehicle #1802.

REQUEST FOR WAIVING BID PROCEDURE

We request the City Council to waive the bid procedure and accept the quotation (requiring two-thirds City Council vote) submitted by:

Zimmerman Ford _____

For the purchase of: 2017 Ford E350 Cutaway Van Chassis, with Knapheide KUV Body _____.

At a cost not to exceed: \$ 36,010 _____.

Reason for the request to waive the bid procedure: We will be purchasing this vehicle through the Local vendor; we have solicited a quote from Zimmerman Ford. The Zimmerman quote includes a limited slip rear axle (\$249) and rubber floor mats (\$90) that are not included in the Currie Quote.

Other Quotations Received: Currie Motors Frankfort, Inc.

Date: 10/24/16 _____

Requested by: _____

Department Director: _____

Purchasing Manager: Mike Shortall _____

THIS REQUEST FORM MUST BE SIGNED BY ALL PARTIES PRIOR TO REQUESTING COMMITTEE APPROVAL FOR WAIVING OF THE BID PROCEDURE. REQUESTS FORWARDED DIRECTLY TO THE CITY COUNCIL (AND BYPASSING COMMITTEE) MUST BE SIGNED BY ALL PARTIES PRIOR TO REQUESTING CITY COUNCIL APPROVAL. SUCH REQUESTS ARE TO BE OF AN EMERGENCY NATURE WHERE TIME IS OF THE ESSENCE.



1802

WA 7002

\$ 36,010

2525 East Main Street • St. Charles, IL 60174 • Phone: 630-584-1800 • Fax: 630-584-9886

Mike Shortall
Purchasing Director
City of St Charles

Standard equipment included on 2017 Ford E350 Cutaway chassis

6.8L V10	Vinyl floor covering
6 speed automatic trans	vinyl bucket seats
120 Amp alternator	Tilt steering column
4 Wheel disc brakes with ABS	Interval wipers
40 Gallon fuel tank	Dual front air bags
Black painted front bumper & grill	16" wheels painted gray
Air conditioning	LT245/75Rx16E all season tires
Color: Oxford white	
3 year or 36,000 mile bumper to bumper warranty	
5 year or 60,000 mile powertrain warranty	

Optional equipment included

Frame pucks (isolators)

KNAPHEIDE KUV 129SUK Ultra low 11ft service body Standard equipment

Lockable sliding door in bulkhead	Master locking system
Standard shelving package	Grab handle at right rear
Stainless steel rotary door handles	Rear window guards
2 dome lights	LED flush mounted rear taillights
2 rear access doors	Galva grip rear step bumper
Service body & bumper painted white	Cargo area & inside of compartments painted white

TOTAL PRICE FOR UNIT

\$32,668

OPTIONS

<input type="checkbox"/> Delivery	INC
<input checked="" type="checkbox"/> Municipal license & title	\$128
<input checked="" type="checkbox"/> Chrome front bumper & grill	\$96
<input checked="" type="checkbox"/> Power windows & locks	\$428
<input checked="" type="checkbox"/> Power trailer tow mirrors	\$215
<input checked="" type="checkbox"/> Daytime running lights	\$45
<input checked="" type="checkbox"/> Sync (Bluetooth) system includes AM/FM CD	\$710
<input checked="" type="checkbox"/> 4.10 limited slip rear axle	\$249
<input checked="" type="checkbox"/> HD alternator	\$73
<input checked="" type="checkbox"/> 4 auxiliary upfitter switches	\$79
<input checked="" type="checkbox"/> Cruise control	\$215
<input checked="" type="checkbox"/> Backup alarm	\$105
<input checked="" type="checkbox"/> Class V receiver hitch & 7 way trailer plug	\$590
<input checked="" type="checkbox"/> 16" sport wheel covers	\$109
<input checked="" type="checkbox"/> Remote keyless entry	\$210
<input checked="" type="checkbox"/> Rubber floor mats	\$90
<input type="checkbox"/> 6 year or 100,000 mile Powertrain warranty	\$1695

NOTE: Extended warranties include \$100 deductible after 3yr/36,000 mile warranty

NOTE : Order to delivery time is 12-16 weeks

Please call me with any questions

Bill Wackerlin
Commercial sales

VEU 1802

WA 7002



Currie Motors Frankfort Inc
9423 W Lincoln Hwy, Frankfort, Illinois, 604231388
Office: 708-479-1100

\$ 35,643

Customer Proposal

Prepared for:

Mr. Mike Shortall
Purchasing Director, City of St. Charles
2 E. Main St.
St. Charles, IL 60174
Office: 630-377-4471
Fax: 630-377-4431
Email: mshortall@stcharlesil.gov

Prepared by:

Jim Koziel
Office: 815-464-9200ext175
Email: jkoz1954@gmail.com

Ship to:

Mike Shortall
City of St. Charles
2 E. Main St.,
St. Charles, IL, 60174

Date: 08/24/2016

Vehicle: 2017 E-350 Cutaway Base
SD Chassis 138" WB SRW





Standard Equipment & Specs

Dimensions

- * Exterior length: 241.1"
- * Exterior height: 80.4"
- * Front track: 69.4"
- * Turning radius: 24.3'
- * Front headroom: 42.0"
- * Front shoulder room: 68.1"
- * Exterior width: 79.4"
- * Wheelbase: 138.0"
- * Rear track: 72.1"
- * Front legroom: 42.1"
- * Front hiproom: 65.6"

Powertrain

- * Triton 305hp 6.8L SOHC 20 valve V-10 engine with SMPI
- * federal
- * Rear-wheel drive
- * Fuel Economy Highway: N/A
- * Recommended fuel : regular unleaded
- * TorqShift 6 speed automatic transmission with overdrive
- * Fuel Economy Cty: N/A

Suspension/Handling

- * Front Twin I-Beam independent suspension with anti-roll bar, HD shocks
- * Hydraulic power-assist re-circulating ball Steering
- * LT245/75SR16 EBSW AS front and rear tires
- * Rear rigid axle leaf spring suspension with HD shocks
- * Front and rear 16 x 7 grey steel wheels

Body Exterior

- * 2 doors
- * Black bumpers
- * Front and rear 16 x 7 wheels
- * Driver and passenger door mirrors
- * Clearcoat paint

Convenience

- * Manual air conditioning
- * Manual door locks
- * Front cupholders
- * Manual front windows
- * Manual tilt steering wheel
- * Driver and passenger door bins

Seats and Trim

- * Seating capacity of 2
- * 4-way driver seat adjustment
- * Driver and passenger armrests
- * Front bucket seats
- * 4-way passenger seat adjustment

Entertainment Features

- * AM/FM stereo radio
- * 2 speakers
- * Auxiliary audio input
- * Fixed antenna

Lighting, Visibility and Instrumentation

- * Halogen sealed beam headlights
- * Light tinted windows
- * Voltmeter
- * Low tire pressure warning
- * Variable intermittent front windshield wipers
- * Tachometer
- * Oil pressure gauge
- * Trip odometer

Safety and Security

- * 4-wheel ABS brakes
- * Dual front impact airbag supplemental restraint system
- * Fixed front head restraints
- * 4-wheel disc brakes
- * Manual door locks



Standard Equipment & Specs (cont'd)

Dimensions

General Weights

Curb	4782 lbs.	GVWR	10050 lbs.
Front GAWR	4200 lbs.	Rear GAWR	6084 lbs.
Payload	5268 lbs.	Front curb weight	2814 lbs.
Rear curb weight	1968 lbs.	Front axle capacity	5000 lbs.
Rear axle capacity	6340 lbs.	Front spring rating	4200 lbs.
Rear spring rating	6084 lbs.	Front tire/wheel capacity	4600 lbs.
Rear tire/wheel capacity	6084 lbs.		

General Trailing

Towing capacity	2950 lbs.	GCWR	13000 lbs.
-----------------	-----------	------	------------

Fuel Tank type

Capacity	40 gal.
----------	---------

Rear Frame

Height loaded	26 "
---------------	------

Powertrain

Engine Type

Brand	Triton	Block material	Iron
Cylinders	V-10	Head material	Aluminum
Ignition	Electronic	Injection	Sequential MPI
Liters	6.8L	Orientation	Longitudinal
Recommended fuel	Regular unleaded	Valves per cylinder	2
Valvetrain	SOHC		

Engine Spec

Bore	3.55"	Compression ratio	9.0:1
Displacement	415 cu.in.	Stroke	4.16"

Engine Power

Output	305 HP @ 4,250 RPM	Torque	420 ft.-lb @ 3,250 RPM
Torque at clutch engagement	350 lb.-ft.		

Alternator

Amps	120
------	-----

Battery

Amp hours	72	Cold cranking amps	650
Type	HD		

Transmission

Electronic control	Yes	Lock-up	Yes
Overdrive	Yes	Speed	6
Type	Automatic		

Transmission Gear Ratios

1st	3.974	2nd	2.318
3rd	1.516	4th	1.149
5th	0.858	6th	0.674
Reverse Gear ratios	3.128		

Transmission Torque Converter



Standard Equipment & Specs (cont'd)

Stall ratio	1.90		
Transmission Extras			
Driver selectable mode	Yes	Oil cooler	Regular duty
Drive Type			
Type	Rear-wheel		
Drive Axle			
Ratio	4.56		
Exhaust			
Material	Stainless steel	System type	Single
Emissions			
CARB	Federal	EPA	Tier 2 Bin 8
Fuel Economy			
Fuel type	Gasoline		
Driveability			
Brakes			
ABS Type	4-wheel 4-wheel disc	ABS channels Vented discs	3 Front
Suspension Control			
Ride	Regular		
Front Suspension			
Independence	Twin I-Beam independent	Anti-roll bar	Regular
Front Spring			
Type	Coil	Grade	Regular
Front Shocks			
Type	HD		
Rear Suspension			
Independence	Rigid axle	Type	Leaf
Rear Spring			
Type	Leaf	Grade	Regular
Rear Shocks			
Type	HD		
Steering			
Activation	Hydraulic power-assist	Type	Re-circulating ball
Steering Specs			
# of wheels	2		
Exterior			
Front Wheels			
Diameter	16"	Width	7.00"
Rear Wheels			
Diameter	16"	Width	7.00"



Standard Equipment & Specs (cont'd)

<i>Front and Rear Wheels</i>			
Appearance	Grey	Material	Steel
<i>Front Tires</i>			
Aspect	75	Diameter	16"
Sidewalls	BSW	Speed	S
Tread	AS	Type	LT
Width	245mm	LT load rating	E
RPM	677		
<i>Rear Tires</i>			
Aspect	75	Diameter	16"
Sidewalls	BSW	Speed	S
Tread	AS	Type	LT
Width	245mm	LT load rating	E
RPM	677		
<i>Wheels</i>			
Front track	69.4"	Rear track	72.1"
Turning radius	24.3'	Wheelbase	138.0"
<i>Body Features</i>			
Body material	Fully galvanized steel	Side impact beams	Yes
<i>Body Doors</i>			
Door count	2		
<i>Exterior Dimensions</i>			
Length	241.1"	Body width	79.4"
Body height	80.4"	Cab to axle	80.0"
Axle to end of frame	68.5"	Frame section modulus	5.7cu.in.
Frame yield strength (psi)	36000.0	Cab to end of frame	148.5"
Front bumper to back of cab	92.5"		
Safety			
<i>Airbags</i>			
Driver front-impact	Yes	Passenger front-impact	Yes
<i>Seatbelt</i>			
Height adjustable	Front	Pre-tensioners	Front
Pre-tensioners (#)	2		
Seating			
<i>Passenger Capacity</i>			
Capacity	2		
<i>Front Seats</i>			
Split	Buckets	Type	Bucket
<i>Driver Seat</i>			
Fore/aft	Manual	Reclining	Manual
Way direction control	4		
<i>Passenger seat</i>			
Fore/aft	Manual	Reclining	Manual



Standard Equipment & Specs (cont'd)

Way direction control	4		
<i>Front Head Restraint</i>			
Type	Fixed		
<i>Front Armrest</i>			
Driver	Yes	Passenger	Yes
<i>Front Seat Trim</i>			
Material	Vinyl	Back material	Vinyl
Convenience			
<i>AC And Heat Type</i>			
Air conditioning	Manual		
<i>Audio System</i>			
Auxiliary audio input	Yes	Radio	AM/FM stereo
Radio grade	Regular	Seek-scan	Yes
<i>Audio Speakers</i>			
Speaker type	Regular	Speakers	2
<i>Audio Antenna</i>			
Type	Fixed		
<i>Convenience Features</i>			
12V DC power outlet	3		
<i>Door Lock Activation</i>			
Type	Manual		
<i>Instrumentation Type</i>			
Display	Analog		
<i>Instrumentation Gauges</i>			
Tachometer	Yes	Oil pressure	Yes
Engine temperature	Yes	Voltmeter	Yes
<i>Instrumentation Warnings</i>			
Oil pressure	Yes	Engine temperature	Yes
Battery	Yes	Lights on	Yes
Key	Yes	Low fuel	Yes
Service interval	Yes	Low tire pressure	Yes
<i>Instrumentation Displays</i>			
Clock	In-radio display		
<i>Instrumentation Feature</i>			
PRND in IP	Yes	Trip odometer	Yes
<i>Steering Wheel Type</i>			
Material	Urethane	Tilting	Manual
<i>Front Side Windows</i>			
Window 1st row activation	Manual		
<i>Window Features</i>			
Tinted	Light		



Standard Equipment & Specs (cont'd)

<i>Front Windshield</i>			
Wiper	Variable intermittent	Sun visor strip	Yes
Interior			
<i>Headliner</i>			
Coverage	Front	Material	Vinyl
<i>Floor Trim</i>			
Coverage	Front	Covering	Vinyl/rubber
<i>Trim Feature</i>			
Gear shift knob	Urethane		
<i>Lighting</i>			
Dome light type	Regular	Variable IP lighting	Yes
<i>Other Console Storage</i>			
Storage	Yes	Type	Engine cover
<i>Storage</i>			
Driver door bin	Yes	Front Beverage holder(s)	Yes
Glove box	Yes	Passenger door bin	Yes
<i>Legroom</i>			
Front	42.1"		
<i>Headroom</i>			
Front	42.0"		
<i>Hip Room</i>			
Front	65.6"		
<i>Shoulder Room</i>			
Front	68.1"		



Selected Options

Code	Description	MSRP
Base Vehicle		
E3F	Base Vehicle Price (E3F)	\$30,445.00
Packages		
780A	Order Code 780A	N/C
Powertrain		
99S	Engine: 6.8L EFI Triton V10	Included
44P	Transmission: Electronic 6-Speed Automatic w/OD <i>Includes tow haul.</i>	Included
X58	4.56 Axle Ratio	STD
LATE AVAILABILITY		
20X	GVWR: 10,050 lb Payload Package	Included
Wheels & Tires		
T38	Tires: LT245/75Rx16E BSW AS	Included
642	Wheels: 16" x 7" Steel Painted Gray	Included
614	16" Sport Wheel Covers	\$120.00
Seats & Seat Trim		
211	Dual High Back Buckets	Included
A	Vinyl Seat Trim	Included
Other Options		
PAINT	Monotone Paint Application	STD
138WB	138" Wheelbase	STD
63M	Heavy-Duty 155-Amp Alternator	\$80.00
54E	Telescopic Trailer Tow Mirrors w/Flat Lens <i>Manual with power adjust flat lens.</i>	\$230.00
559	Frame Pucks (Isolators) <i>Includes 12 body mounts.</i>	\$50.00
903	Power Windows & Locks Group <i>Includes 1-touch down power driver window.</i>	\$465.00



Selected Options (cont'd)

Code	Description	MSRP
948	Remote Keyless Entry	\$225.00
525	Cruise Control	\$240.00
585	Radio: Premium ETR AM/FM Stereo/Digital Clock/CD <i>Single disc. Includes audio input jack and 2-speakers</i>	\$295.00
98S	SYNC Communications & Entertainment System <i>Includes 911 assist, vehicle health reports, traffic reports, GPS based turn-by-turn driving directions and AppLink. Includes: - Auto-Dimming Inside Rear-View Mirror w/Microphone</i>	\$475.00
47Z	Ambulance Prep Package Not Required REQUIRED on orders not destined for ambulance use.	N/C
18A	High Series Exterior Upgrade Package	\$105.00
52S	User-Defined Switches <i>Includes 4 upfitter switches on the instrument panel.</i>	\$85.00
942	Daytime Running Lamps (LPO)	\$45.00
Interior Colors		
AE_02	Medium Flint	N/C
Primary Colors		
YZ_01	Oxford White	N/C
Upfit Options		
KNAP 8 16	KUV 129SUK <i>11 ft Service Body KUV 129SUK with Class 5 Hitch and Back up Alarm Built TO Customer Specs'</i>	\$9,650.00
SUBTOTAL		\$42,510.00
Destination Charge		\$995.00
TOTAL		\$43,505.00

	<i>Selected Options</i>	MSRP
Exterior:Oxford White	STANDARD VEHICLE PRICE	\$30,445.00
Interior:Medium Flint	Order Code 780A	N/C
* LT 245/75R16 E BSW AS S-rated tires	Monotone Paint Application	STD
* Tinted glass	138" Wheelbase	STD
* Bluetooth wireless streaming	Ambulance Prep Package Not Required	N/C
* Dual power remote mirrors	Paint Table : Primary	\$0.00
* 16 x 7 steel wheels	Oxford White	N/C
* Tachometer	Medium Flint	N/C
* Vinyl seats	Daytime Running Lamps (LPO)	\$45.00
* Front axle capacity: 5000 lbs.	Frame Pucks (Isolators)	\$50.00
* Front spring rating: 4200 lbs.	Engine: 6.8L EFI Triton V10	Included
* Frame section modulus: 5.7 cu.in.	Transmission: Electronic 6-Speed Automatic w/OD	Included
* Cab to axle: 80"	GVWR: 10,050 lb Payload Package	Included
	Tires: LT245/75Rx16E BSW AS	Included
	Wheels: 16" x 7" Steel Painted Gray	Included
	Dual High Back Buckets	Included
	Vinyl Seat Trim	Included
	Power Windows & Locks Group	\$465.00
	4.56 Axle Ratio	STD
	High Series Exterior Upgrade Package	\$105.00
	Front Chrome Bumper w/Black Lower Fascia	Included



Hwy
N/A

and should be treated as estimates only. Actual base vehicle, package and option pricing may vary from this estimate because of special local pricing, availability system. See salesperson for the most current information.

Note ID: VOSC1



Currie Motors Frankfort Inc
 9423 W Lincoln Hwy, Frankfort, Illinois, 604231388
 Office: 708-479-1100

2017 E-350 Cutaway, SD Chassis
 SD Chassis 138" WB SRW Base(E3F)

Pricing - Single Vehicle

		MSRP
<i>Vehicle Pricing</i>		\$43,505.00
 <i>Pre-Tax Adjustments</i>		
Code	Description	
M-009	Municipal Plates	\$128.00
M-Disc	Municipal Discount	-\$7,990.00
<i>Municipal Discount St. Charles</i>		
 Total		 \$35,643.00

Customer Signature

Acceptance Date

**City of St. Charles, Illinois
Resolution No. _____**

A Resolution Authorizing the Mayor and the City Clerk of the City of St. Charles to Approve the Award of a 2017 Ford E350 Cutaway Van Chassis, with Knapheide KUV Body to Zimmerman Ford and Sell Replaced 2003 Ford E-350 SD Van Vehicle #1802

**Presented & Passed by the
City Council on _____, 2016**

BE IT RESOLVED by the Mayor and City Council of the City of St. Charles, Kane and DuPage Counties, Illinois, that the Mayor and City Clerk be and the same are hereby authorized to approve the award of a 2017 Ford E350 Cutaway Van Chassis, with Knapheide KUV Body to Zimmerman Ford and Sell Replaced 2003 Ford E-350 SD Van Vehicle #1802.

PRESENTED to the City Council of the City of St. Charles, Illinois,
this _____ day of November, 2016

PASSED by the City Council of the City of St. Charles, Illinois this _____ day of
November, 2016

APPROVED by the Mayor of the City of St. Charles, Illinois, this _____ day of
November, 2016

Raymond P. Rogina, Mayor

ATTEST:

City Clerk

COUNCIL VOTE:

Ayes:

Nays:

Absent:

Abstain: