

**AGENDA
CITY OF ST. CHARLES
TREE COMMISSION MEETING
RALPH GRATHOFF, CHAIR**

**THURSDAY, SEPTEMBER 8, 2016 – 7:00 PM
CITY HALL, COUNCIL COMMITTEE ROOM
2 EAST MAIN STREET**

- 1. Call to Order and Pledge of Allegiance**
- 2. Roll Call: Blaine, Brens, Duerr, Grathoff, Hauser, Myers, Otto, Wilfong, Ziegler**
- 3. Introduction of Visitors, Comments and Concerns**
- 4. Minutes: Review and Approval**
 - A. Motion to accept and place on file the minutes of the July 14 , 2016 Tree Commission Meeting
- 5. Old Business**
 - A. Update on Urban Forestry Management Plan
 - B. Update on three Maple trees at Kehoe Dr and Horne St
 - C. Update on Langum Park restoration
 - D. Update on Natural Resources Commission
 - E. Woods of Fox Glen / Outlot B – unauthorized tree removal
- 6. New Business**
 - A. News or Concerns from Public Works
 - i. Fall Planting 2016
 - ii. Tree Trimming Update
 - iii. Other
 - B. News or Concerns from Tree Commission
 - i. Preliminary discussion of future maintenance of Norway Maples
 - ii. Recommendation to ban honeybee-keeping within City limits
- 7. Committee Reports**
 - A. Education Committee
 - B. Langum Park Clean-Up Committee
- 8. Communications**
 - A. Approval of Public Services Division Tree Activity Reports for July and August 2016
- 9. Additional Items from Commissioners, Staff or Citizens**
 - A. Commissioners
 - B. Staff
 - C. Visitors
- 10. Adjournment**

Next meeting will be the annual joint meeting with Batavia, Geneva and St. Charles on October 20, 2016 at Creek Bend Nature Center, 37W700 Dean Street, St Charles, IL.

**MINUTES
CITY OF ST. CHARLES
TREE COMMISSION MEETING
RALPH GRATHOFF, CHAIRMAN
JULY 14, 2016**

Members Present: Chair. Ralph Grathoff, Valerie Blaine, Jon Duerr, Raymond Hauser, Suzi Myers, Caroline Wilfong, Ron Ziegler

Members Absent: Kathy Brens, Ray Hauser, Pam Otto

Others Present: Chris Adesso, Jeremy Craft, Marcelline D'Argento, Isabel Soderlind, Lisa Vielbig

Visitors Present:

1. Call to Order & Pledge of Allegiance

The meeting was convened by Chair. Grathoff at 7:10 p.m.

- 2. Introductions of Visitors:** Chris Adesso introduced Marcelline D'Argento and Lisa Vielbig to the Tree Commissioners. Both Public Works Administrative Assistants will be sharing the duties to support the Tree Commission moving forward.

3. Minutes Review and Approval

Motion to accept and place on file the minutes of the May 12, 2016 Tree Commission meeting. Motion made by Comm. Duerr second by Comm.Blaine to accept and place the minutes on file.

Voice vote: unanimous; Nays – None; Absent: Kathy Brens, Ray Hauser, Pam Otto

- Motion carried at 7:11 p.m.

4. Old Business

A. Update on the Urban Forestry Management Plan

Comm. Blaine stated she had made some progress proof-reading the Urban Forestry Management Plan but she still had more editing to do. Her intention is to: (1) reduce the wordiness of the document, and (2) clarify the information for the intended reader. As mentioned before, the document is a combination of urban forestry policies and a procedural manual for the Public Works Urban Forestry team. Once the document is approved by Council, it will be published and posted on the City's website making it available for the general public.

Comm. Duerr recommended reviewing the edited document at the September 8 Tree Commission meeting. After the document is finalized, AJ Reineking will present it to the Government Services Committee, followed by formal approval from Council.

B. Reorganization of the Tree Commission into a Natural Resources Commission

Chair. Grathoff recapped that the Commission had voted and approved the motion to become a Natural Resources Commission last month. In an effort to move this initiative forward, he had written two mission statements for the Commissioners to consider and approve. Once this was voted on and approved, Chris Adesso would present this initiative to the Public Works Director, City Administrator and Council for formal approval.

The mission statements were distributed and reviewed by the Commissioners. (See attached.)

Upon review, the consensus agreed on the following mission statement for the Natural Resources Commission:

“Our mission is to work through a committed partnership with the community to conserve, preserve, protect and enhance the City’s natural resources and to raise awareness and make recommendations concerning environmental issues within the City of St. Charles.”

The recommendation was made to approve the above mission statement and present the concept of reorganizing the Tree Commission to a Natural Resources Commission, given the similar advisory committee model as the current Tree Commission, at the August 22 Government Services Committee meeting,

Chris Adesso recommended a Roll Call:

Comm. Blaine: Yes
Comm. Duerr: Yes
Chair. Grathoff: Yes
Comm. Myers: Yes
Comm. Wilfong: Yes
Comm. Ziegler: Yes

Motion made by Comm. Blaine second by Comm. Myers. Approved by voice vote. Motion carried.

Chris Adesso mentioned the next step of the process was to request the approval of reorganizing the Tree Commission to a Natural Resources Commission and present the proposed mission statement to the August 22, Government Services Committee. Once final approval is received from Council, the next step would be to amend the Tree Commission portion of the codebook.

Chris Adesso will be presenting the Natural Resources Commission mission statement at the Government Services Committee meeting, Monday, August 22 in the Council Chambers at 7:00 p.m.

5. New Business

A. News and Concerns from Public Works:

- i. **Tree Trimming:** Jeremy Craft reported tree trimming has been limited to service requests in the last month or so. The primary focus of the division has been other Public Services construction/maintenance duties and to prepare for the City’s America in Bloom judging.

Comm. Duerr asked about the Sycamore trees removed behind Smitty’s and the Harris Bank. Mr. Craft indicated that these trees were private trees and the City did not have any jurisdiction over them.

- ii. **Fall Planting:** Mr. Craft mentioned there are only 65 trees currently on the fall tree planting list. Mr. Craft also added that the division will be sending out a bid for tree planting again this year. This will be a one year contract with an additional two year extension. Jeremy also reminded the commissioners that the Public Services tree replacement budget is now back to “normal”. It is no longer near the amount the division had during the years the ash trees were being removed and replaced.
- iii. **Replacement of Arbor Day Tree at Fox Ridge School:** The Arborist Team was also notified that the tree planted on Arbor Day at Fox Ridge School did not survive but it will be replaced with another Zelkova during the fall planting season.

- iv. **Request from Resident to Remove Parkway Tree:** Public Works received a call from Tim Hovious residing at 1036 Kehoe Drive. He is requesting Public Services remove one of the 3 maple parkway trees running along the Horne Street side of his home, preferably S2 or S3.

Per Chris Adesso, the Norway Maples are apparently 13 years of age. The resident is requesting the removal of one of the trees so the parkway can receive more sun and the parkway grass could grow.

The Commission viewed the three trees online in the 2016 version of Google Maps. Looking at the trees from the "street view", the trees seemed in poor condition. It is a very shaded street with these growing maples being planted too closely together. The parkway appeared to be mostly dirt/soil, with the salt, roots and water draining towards the tree and not to the grass. The resident has tried to reseed grass twice and has not been able to grow any considerable grass in this area.

Jeremy Craft mentioned the arborist staff has thinned out the trees several times and that has not helped. He added that the S1 tree was in worst shape and it may need to be removed in the future.

While the trees did not appear to be in very good condition, the recommendation was made to table the removal of the tree until all the Commissioners conducted their own site review of the S2 tree (2nd tree from the corner of Horne & Kehoe) before the next scheduled meeting, September 8. A motion and vote to remove the tree will be taken at the September meeting.

6. Committee Reports

A. Education Committee:

Comm. Wilfong indicated she still had several copies of the book entitled *Why Would Anyone Cut a Tree Down?* to deliver in honor of 2016 Arbor Day. She mentioned that she would distribute the books to the remaining schools once they were back in session.

B. Publicity Committee: None

C. Langum Park Clean Up:

The meeting tonight began at Langum Park. The Commissioners walked around Langum Woods determining next steps for the Langum Woods Clean Up Project.

The commissioners agreed more clean up was needed and the pathways needed additional chips. Jeremy Craft and the arborist team will inspect the area late this coming fall/winter and determine if the area needs more woody evasive removal. If monies are available in this year's budget, the crews will work on removing the woody evasives. If not, provisions will be made in next year's budget.

D. October Joint Meeting

Isabel Soderlind reminded the Commissioners of the upcoming Tri-Cities Joint Tree Commission meeting in October. It is the City's turn to host the meeting this year. Isabel requested some available dates she could offer to the Batavia Environmental Commission and Geneva's Natural Resources Committee. The Commissioners agreed on two options, October: Tuesday, October 18 or Thursday, October 20.

Comm. Blaine recommended meeting at Creek Bend Nature Center at LeRoy Oakes Forest Preserve for this year's meeting. Isabel Soderlind will contact Batavia Environmental Commission and

Geneva's Natural Resources Committee to see if either one of these dates was preferable for their group.

7. Communications

Electric Division Tree Activity Reports

Motion to accept and place on file the Public Works Tree Activity Reports for May & June of 2016. Motion made by Comm. Duerr second by Chair. Grathoff to accept and place on file the reports as presented.

Voice vote: unanimous; Nays – None; Absent: Kathy Brens, Ray Hauser, Pam Otto
- Motion carried at 8:20 p.m.

8. Additional Items – Comments

A. Commissioners: None

B. City Staff:

Isabel Soderlind: Thanked the commission for all their support. It has been her pleasure to assist the committee the past couple of years.

Chris Adesso: will update AJ Reineking of today's decision to delay the tree removal at 1036 Kehoe Drive. AJ in turn will contact and update the resident.

9. Adjournment

Motion by Comm. Blaine to adjourn the meeting, second by Comm. Ziegler.

Voice vote: unanimous; Nays – None; Absent: Kathy Brens, Ray Hauser, Pam Otto

- Motion carried at 8:24 p.m.

/ims

Mission statement for City of St. Charles Natural Resources Committee

Version one

Our mission is to raise awareness of natural resources and environmental issues within the City of St. Charles. Our intent and purpose is to inform the preservation, protection, enhancement and conservation of our natural resources through a committed partnership with all the community.

Version two

Our mission is to work through a committed partnership with the community to conserve, preserve, protect and enhance the city's natural resources and to raise awareness and make recommendations concerning environmental issues within the City of St. Charles.

Douglas C. Hancock
Attorney at Law
2215 Pepper Valley Drive, #8
Geneva, IL 60134
630-262-8940
doug@drm.comcastbiz.net

July 26, 2016

City of St. Charles
Tree Commission Members
2 E Main Street
St. Charles, IL 60174

RE: Out Lot B

Dear Mr. Grathoff, Chairman and Members of the Tree Commission,

My relationship with Out Lot B started in the early 1970's, after I purchased the adjoining five acres located to the south. At that time, what is presently Out Lot B was part of the gravel pit property consisting of 140 acres more or less.

Members of the Wayne equestrian community and myself maintained and expanded existing trails through the entire property and the adjoining properties.

Once the gravel pit became the Woods of Fox Glen, our trail activity continued on Out Lot B and adjoining properties to the south and east.

Starting in the late 1990's, my efforts, along with others, commenced to become a "restoration" of the property. The work started at the east end and proceeded to the west. Approximately 10 acres have been worked on for restoration, but not completed. Restoration is always a "work in progress". When work commenced, the condition of the property can be reasonably described as "unprotected and degraded". The property was thick with multiflora rose, buckthorn, bush honeysuckle, box elder trees, maples, ash, elms and other "shade tolerant" trees. Hardwoods such as oaks, walnuts and hickory were old, rare and very stressed. Much of the soil was bare and unprotected as a result of the thick "canopy" that shaded the area and prevented a healthy "understory". The property, other than the maintained trails, was impenetrable. Presently, the condition of approximately 10 acres of the western portion of Out Lot B is in that "degraded" condition.

For purposes of brevity, I have exhibits that support my message. Exhibits 1 and 2, aerials from 1939 show that the property historically was a prairie, being farmed, with a few large hardwoods along the Norton Creek. Presently, there is little, if anything special about the trees in Out Lot B. It is all regrowth since the 1950's and 1960's, when farming stopped. The north south road on Exhibit 1 is Nelson Drive. The junction of the north branch and south branch of Norton Creek is approximately 125 yards from the east border of Out Lot B. Exhibit 3 confirms that the area was originally "open".

Exhibit 4 "Too Many Trees in the Forest", Chicago Tribune, April 15, 2015, provides an "eye opener" as to what is being done to recreate prairies and savannas. If one values the trees removed in the Lake County project, it would be in the "millions" using the analysis as provided in Graf Tree Care report of February 22, 2016. The value of the removal in DuPage and Kane County would be considerably less. These Forest Preserve Districts are just getting started on the Restoration trend. This article makes it very clear that a new "mind set" about trees, prairies and forest restoration is evolving with Forest Preserves, Park Districts and private landowners.

Exhibit 5 is one of my invoices for prairie grasses and for forbs, much of which has been planted in the portion of Out Lot B which I have worked. The results of the plantings are becoming more evident.

I suggest that you consider a visit to the Kane County Forest Preserve Enhancement Project, which is located at the southwest corner of Route 31 and Fabyan Parkway. The restored woods in that project mimic to a large extent the work that I have done in Out Lot B.

Consider reviewing or reading "Miracle Under the Oaks" by William K. Stevens, 1977. This book is a factual account of what Steve Packard, started in 1997, with lots of volunteers, restoring Cook County Forest Preserve property along the North Branch of the Chicago River. Steve Packard is credited with starting the restoration movement that culminated in the work being done as expressed in the Chicago Tribune article of April 15, 2015, which is enclosed as Exhibit 4.

In summary, I invite all of you to tour the property with me. I can accommodate you on more than one date.

I have just attended the North American Prairie Conference, at Illinois State University in Normal, Illinois on July 17, 2016 – July 20, 2016. These conferences began in 1970 and are held every two years in various locations in the Midwest and Canada. Briefly, my take-away from the conference:

- There is no "one way" for prairie, savannah restoration. It is an art, not a science. Everyone in this field is constantly learning.

- Restoration is "inspired guesswork".

Where should St. Charles go from here? I have delivered the "wake-up call", although it may have been delivered abruptly or even rudely.

Out Lot B is a potential restoration "jewel", and it should be restored. Approximately, 1/3 of the work has been completed.

If not St. Charles, with volunteers, then, who? St. Charles can little afford to pay hundreds of thousands of dollars to hire a restoration contractor, and then continually pay to maintain the restoration.

If not now, when should the work be done? The degradation continues, slowly.

Looking forward to meeting all of you on site, and I can also appear at your meetings.

Respectfully,

Douglas C. Hancock

Douglas C. Hancock

DCH:dmc

Enclosures

cc: Mr. Peter Suhr, Director of Public Works

Mr. John M. McGuirk, Attorney at Law

Mr. Jerry M. Johnson

2. CIRCA 1939



EXHIBIT 1

Circa 1939



8-10-39

Exhibit 2

PAGE OF PLAT BOOK
CIRCA 1920

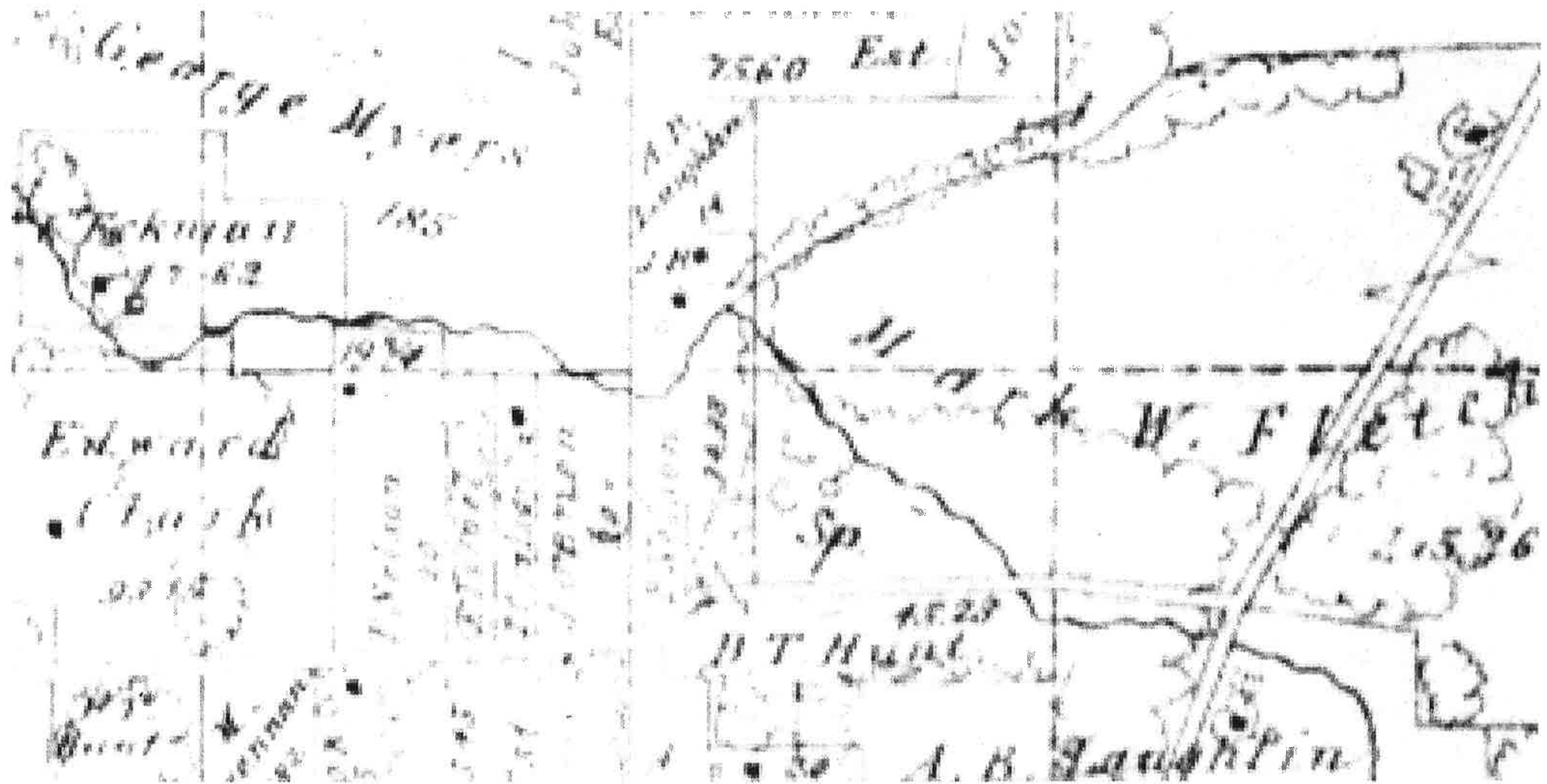

Exhibit 3



STACEY WESCOTT/CHICAGO TRIBUNE

Janet Zupko, of Chicago, walks Sunday at Ryerson Woods Forest Preserve in Riverwoods. "My opinion is that you don't cut down perfectly healthy trees unless it is really necessary," she said. Some counties are felling trees in preserves as part of restoration projects.

Too many trees in the forest?

Some preserve districts cut from crowded woods, aiming to restore prairies, draw back native species

BY ROBERT MCCOPPIN
AND SHERYL DEVORE

Chicago Tribune

The buzz of chain saws filled Potawatomi Woods this winter. Century-old trees cracked and fell to the ground. Contractors cleared 259 acres of mature ash, maples and sycamores.

With the spring thaw, parts of the forest preserve near northwest suburban Wheel-

ing look like a muddy wasteland. Hundreds of tree trunks lie stacked like firewood. Stumps dot the landscape.

If the areas look devastated or ugly, Cook County Forest Preserve District officials say their work will eventually lead to a beautiful, and ecologically important, rebirth. The goal is to bring back the native habitat of grasses and sedges, red-headed woodpeckers and wildflowers.

The project is part of a growing effort by

conservationists in the Chicago area to cut down overcrowded woods into more open woodlands, savannas and meadows. In some cases, forest preserves are being transformed into prairie preserves. It's also an indication that, despite their names, forest preserve districts in the Chicago area are spending a good deal of their resources tearing down trees.

"Now, ironically, forest preserves have too many trees," said Benjamin Cox, executive director of the Chicago-based Friends of the Forest Preserves. "(Having)

Turn to *Preserves*, Page 6

Lake County district focuses on oak trees

BY SHERYL DEVORE
Chicago Tribune

The Lake County Forest Preserve District has torn down thousands of maples, elms and other mostly healthy trees in the past three years, and those who support the project say they're taking a long view toward the forests' health.

The nearly 4,000 trees were felled because they were crowding out oaks and the wildlife that rely on oaks for food and shelter.

"The big issue here is regeneration," said Robert Fahey, a forest ecologist at The Morton Arboretum who consults with Lake

County. "The (older) oaks are all going to die within the next 100 years. ... There are no young oaks to replace them."

Lake County believes its work can serve as a model for other conservation agencies in the Chicago area, which has experienced a major loss of once-dominant native oaks. But Lake County officials acknowledge it's tough watching mature trees fall.

"Nobody likes to cut down trees," said Deb Maurer, natural resources manager. "It wasn't easy for our staff" to watch the trees be taken down, she said. Maurer heads a team

removing trees, planting oak seedlings and gathering wildlife and soil composition data. The \$3 million project was funded from a voter-approved 2008 bond referendum for restoration work.

This winter, a contractor removed invasive woody species and shade-tolerant understory trees from sections of northern flatwoods communities in the preserves.

To grow successfully, oak saplings need light, and over the past century, the canopies of many of the area's natural woodlands have become closed, taken over by trees such as maples that are more tolerant of shade. The idea behind the clearing projects is that they will increase the amount of sunlight that reaches the ground, encouraging the re-

generation of native, shade-intolerant trees and shrubs like white oak, red oak, walnuts, viburnum and hazelnut.

In some wooded areas, for example within Ryerson Conservation Area near Deerfield, sugar maples have outgrown the oaks and are stifling sunlight from getting to oak saplings.

Over the past several decades, the forest preserve has introduced prescribed burns to the woodlands, removed nonnative species and developed a deer-reduction program to keep the oak saplings from being over-browsed.

"But that just hasn't been enough," Maurer said.

Working with Fahey, the forest preserve created plots of land within the woods of the four preserves with varying amounts of

tree removal and planting. At some sites, like Ryerson, visitors can see large stumps where sugar maples once stood.

Maurer said not all maples are being removed.

The team is gathering data to see which regimen will most help oak seedlings grow successfully. In addition, they are monitoring soil properties and changes in other plant and animal life in the oak woodlands.

The hope is that the work will bring back native animals, including certain species of birds and amphibians that have been declining, said Gary Glowacki, Lake County Forest Preserve District wildlife biologist.

In the past 20 or 30 years, the preserves "completely lost wood frogs and spotted salamanders," species that

require open oak woodlands with transient ponds in which to breed, he said.

Bird species such as red-headed woodpeckers also require open woodlands and have been documented less and less over the past 20 years in the preserves the district is managing for oak regeneration, Glowacki said.

After two years of tree removal, the woodpeckers are returning to all the preserves where the work is being done, he said.

"We're trying to make the ecosystem healthier and trying to create a new generation of oak trees that will be there for the future," Fahey said. "We have to think about the future of our forests."

DeVore is a freelance reporter.

Trees felled for restoration

Preserves, from Page 1

too many trees creates tons of shade, and prevents growth of the understory."

In Lake County, about 4,000 trees, many mature and healthy, have been felled from four preserves in the past three years in an effort to let in sunlight to grow more oak trees. Though pests have also been a major reason for tree removal, the large-scale removal of trees to restore and preserve habitat marks a continuing evolution in conservation.

When Illinois lawmakers authorized the creation of forest preserve districts in 1913, the mission was exclusively to save forests. Land management meant planting more trees, preventing fires and otherwise largely leaving the preserves alone.

But fire suppression and preservation led to fast-growing trees like sugar maples and elms shading out other plants, primarily oak trees that had dominated the area's woodlands for thousands of years, said Robert Fahey, forest ecologist at The Morton Arboretum in Lisle.

Before Europeans settled the area, fires set by Native Americans and by lightning strikes "created a mosaic of prairies, savannas and woodlands," Fahey said, keeping the growth of other plants in check while allowing the fire-resistant oaks to thrive. But when the fires stopped, the ecosystem eventually got knocked off balance, with thickets of nonnative species like buckthorn and honeysuckle spreading unchecked, naturalists say.

In recent decades, the removal of such invasive trees, often with the help of volunteers and controlled brush burns, have been common in forest preserves, though not without controversy. Protests led Cook and DuPage counties to ban such tactics in 1996. The bans were lifted in stages over 10 years, and some of those who raised red flags then have since been won over.

After his initial concerns were answered, Cook County Commissioner Peter Silvestri, for instance, now says he supports restoration.

Chip O'Leary, chief ecologist for the Cook County preserves, said restoration projects have prompted the renewal of plants and wildlife and have attracted greater diversity that's the hallmark of a healthy ecosystem. With the return of certain types of frogs and snakes, migratory and wetland birds and small mammals in Potawatomi Woods, he said, "it'll be a lot prettier place to be."

Still, not everyone agrees with the approach.

Mark Spreyer is executive director of the Stillman Nature Center, a private, nonprofit center on a former farm in South Barrington that features woods and prairie. Spreyer led Chicago's peregrine falcon release program in the 1980s and has taught environmental biology at the College of Lake County.

He says it's unrealistic to try to re-create an idealized setting from 200 years ago when the environment has changed. He notes, for instance, that the federal map of what plants can live in



STACEY WESCOTT/CHICAGO TRIBUNE

Andy Wade uses a log grabber to stack tree trunks onto a flatbed truck in January after the clear-cutting of land in a Cook County forest preserve in Wheeling. Some trees in the county are being removed as part of a restoration effort.



STACEY WESCOTT/CHICAGO TRIBUNE

Lumberjack Doug Brehm cuts up trees in January in a Cook County forest preserve in Wheeling.

different zones has been redrawn in recent years.

Some plants and animals thrive in the current condi-

tions and will be harmed by attempts to destroy habitat and convert cool, tranquil forests to "hot, buggy"

meadows, he said. His approach reflects the recent but controversial notion that "novel ecosystems" with nonnative species have adapted to human intervention.

"The public prefers forests," he said, "but we're getting prairie shoved down our throats."

Yet restoration, including the clearing of existing trees, is solidly in the mainstream of land management. The U.S. Forest Service has its own program that includes thinning and burning woods in places like Mark Twain National Forest in Missouri and Arkansas. In Cook County, restoration projects are often carried out in consultation with state and federal authorities.

Naturalists argue that precisely because humans have carved up and altered natural areas so drastically, they require aggressive management to restore balance and diversity.

"People had understandable concerns when they saw so many trees coming down," Cook County Forest

District spokesman Don Parker said, "but once we've talked to them about what we're doing, people have been supportive of the work."

The Potawatomi Woods project is funded through \$1.7 million provided by the Illinois Tollway as compensation for the trees that had to be removed several years ago to widen the nearby Tri-State Tollway. By agreement, the money had to be spent in the area, near the Des Plaines River, though officials said restoration would have been done eventually, anyway.

For the first time, the forest agency plans to sell some of the wood as timber and firewood, hoping to earn \$235,000. More typically, such wood would be burned or chipped on-site.

Similar tactics have been used with great success in other preserves, officials said. Prime examples are Deer Grove East near Palatine and Orland Grassland preserves, where the U.S. Army Corps of Engineers recently completed a \$12 million restoration of

almost 1,000 acres. Both sites have attracted native grassland wildflowers, butterflies and breeding birds, including bobolinks, Henslow's sparrows and eastern meadowlarks.

The work in Cook County fits in with the Next Century Conservation Plan, which aims to restore 30,000 acres over 25 years. The work will cost an estimated \$40 million a year, though where most of the money will come from has not been identified.

Officials from other counties in the area are approaching restoration in their own ways.

In Lake County, the forest preserve district is thinning forests as part of a regional plan to grow new oak woodlands. The loss of oak woodlands that once dominated the area, and lack of young oak trees, is of particular concern to conservationists.

Other forest preserve districts in the area are pursuing ambitious restoration projects that do not involve wide-scale tree removal.

In DuPage County, work began this winter to remove a stand of invasive trees from Klein Fen, but the district is not generally removing large trees, said Scott Meister, assistant manager of natural resources. The district is doing other innovative restoration, Meister said, widening waterways like Spring Brook Creek No. 1 near Winfield, to better handle floods.

In Will County, the forest preserve district's largest restoration project at Hadley Valley in Joliet comes around a cost of \$10 million. That project involves planting more than 300,000 wetland plants and almost 34,000 trees and shrubs to convert farmland back to wetland and prairie.

Kane County has limited itself to clearing smaller invasive species. It is growing oak seedlings and planting them in former farm fields to re-create savannas.

Drew Ullberg, director of natural resources for the Forest Preserve District of Kane County, said he's awaiting the results of Lake County's woodland thinning.

"We're watching to see the ecological results and the public reaction," Ullberg said. "Not everybody's an ecologist. When you have the name 'forest preserve district,' people are really sensitive. Why are you cutting trees? We hear that."

The McHenry County Conservation District got that reaction this spring after it cleared brush as part of a restoration program on Nippersink Creek. Ed Collins, director of land preservation and natural resources, wrote online that visitors tend to judge such a project prematurely by its cut stumps and empty space.

Over time, he wrote, sunlight and plantings will bring new generations of butterflies, oaks and wildflowers, and transform the landscape "to a soft water color portrait of a sublime and very Midwestern landscape."

McCoppin is a Tribune reporter; De Vore is a freelance reporter.

emcoppin@tribpub.com
Twitter @RobertMcCoppin

Month	Trimmed: Public Services Division	Trimmed: Contractor	Removal: Public Services Division	Removal: Contractor	Emergency Removal: Public Services Division	Emergency Removal: Contractor	Plantings: Public Services Division	Plantings: Contractor	Moved: Public Services Division	Moved: Contractor	Comments:
May-16	11		8	5							
Jun-16	44		14	3							
Jul-16	243		2	11		2					
Aug-16	96	5	40	18		2					
Sep-16											
Oct-16											
Nov-16											
Dec-16											
Jan-17											
Feb-17											
Mar-17											
Apr-17											
Running Total	394	5	64	37	0	4	0	0	0	0	

Quadrant	Address	Suffix	Street	Side	Site	Species	WorkType	Completed Date			Completed By
								MM	DD	YY	
SE	708		Cedar Ave	Front	2	No Tree Per Resident	Removal Emergency	7	21	2016	Skyline Tree Service-Removals
SW	930		Elm St	Front	1	Don't Replant	Removal Emergency	8	22	2016	Skyline Tree Service-Removals
SW	511		Mckinley St	Front	1	Planting Site SW	SD-Removal	7	7	2016	Skyline Tree Service-Removals
NE	912		3rd Ave /N	Front	4	DNR	Removal Emergency	8	19	2016	Skyline Tree Service-Removals
						Emergency Removals In-House:	0				
						Emergency Removals Contracted:	4				
						Total Emergency Removals:	4				

Quadrant	Address	Suffix	Street	Side	Site	Species	WorkType	Completed Date			Completed By
								MM	DD	YY	
FW	180	X	Peck Rd	Front	2	Planting Site FW	Cut & Pull Tree In-House	7	26	2016	In-House Removal
SE	1240		Ronzheimer Ave	Side	1	Stump	Removal	7	8	2016	In-House Removal
SW	49		Horne St	Front	3	DNR	Cut & Pull Tree In-House	8	8	2016	In-House Removal
NE	516		2nd Ave /N	Front	2	Stump	Removal	8	19	2016	In-House Removal
SE	316		4th Ave /S	Front	1	Stump	Removal	8	19	2016	In-House Removal
SW	1232		4th St /S	Front	1	Stump	Removal	8	23	2016	In-House Removal
SE	104		6th Ave /S	Front	1	Planting Site SE	Cut & Pull Tree In-House	8	8	2016	In-House Removal
SE	515		6th Ave /S	Front	1	Stump	Removal	8	19	2016	In-House Removal
SE	1456		Banbury Ave	Front	1	No Tree Per Resident	Cut & Pull Tree In-House	8	8	2016	In-House Removal
NW	305		Bradley Cir	Front	3	Planting Site NW	Removal	8	8	2016	In-House Removal
NW	305		Bradley Cir	Front	2	Planting Site NW	Removal	8	8	2016	In-House Removal
SE	1807		Cambridge Dr	Front	1	Planting Site SE	Removal	8	19	2016	In-House Removal
SW	1004		Charleston Dr	Front	1	Planting Site SW	Cut & Pull Tree In-House	8	8	2016	In-House Removal
SE	215		E. Main St.	Side	2	Stump	Removal	8	19	2016	In-House Removal
NW	101		Edgewild Ct.	Front	3	Planting Site NW	Removal	8	8	2016	In-House Removal
SW	730		Fellows St	Front	4	Planting Site SW	Cut & Pull Tree In-House	8	8	2016	In-House Removal
NW	2804		Greenwood Ln	Front	1	Planting Site NW	Cut & Pull Tree In-House	8	8	2016	In-House Removal
SE	1539		Independence Ave	Front	1	Planting Site SE	Cut & Pull Tree In-House	8	8	2016	In-House Removal
SE	1559		Independence Ct	Front	1	Stump	Removal	8	19	2016	In-House Removal
SE	1625		Jay Ln	Front	1	Stump	Removal	8	19	2016	In-House Removal
NE	901		Jeffrey Ct	Side	2	Stump	Cut & Pull Tree In-House	8	19	2016	In-House Removal
NE	901		Jeffrey Ct	Front	3	Stump	Removal	8	19	2016	In-House Removal
NE	1006		Keim Tr	Front	3	Stump	Removal	8	19	2016	In-House Removal
NE	1701		Keim Tr	Front	3	Stump	Removal	8	19	2016	In-House Removal
NE	1102		King James Ave	Front	2	Planting Site NE	Cut & Pull Tree In-House	8	8	2016	In-House Removal
NE	514		Longmeadow Cir	Front	1	Stump	Cut & Pull Tree In-House	8	8	2016	In-House Removal
SE	1944		Moore Ave	Front	1	Planting Site SE	Cut & Pull Tree In-House	8	8	2016	In-House Removal
NW	4055		Prairie Crossing Dr.	Front	2	Planting Site NW	Cut & Pull Tree In-House	8	8	2016	In-House Removal
FW	3220		Raphael Ct	Front	1	Stump	Removal	8	18	2016	In-House Removal
FW	502		Red Sky Dr.	Side	2	Planting Site FW	Cut & Pull Tree In-House	8	8	2016	In-House Removal
NW	4210		River View Dr.	Front	3	Stump	Removal	8	18	2016	In-House Removal
NE	3601		Royal Fox Dr	Front	2	Planting Site FW	Cut & Pull Tree In-House	8	8	2016	In-House Removal
NE	4125		Royal Troon Ct	Front	3	Planting Site NE	Cut & Pull Tree In-House	8	8	2016	In-House Removal
NE	4127		Royal Troon Ct	Front	1	Planting Site NE	Cut & Pull Tree In-House	8	8	2016	In-House Removal
NW	262		Sedgewick Cir	Front	1	Stump	Removal	8	18	2016	In-House Removal
NW	263		Sedgewick Cir	Front	2	Planting Site NW	Cut & Pull Tree In-House	8	8	2016	In-House Removal
NW	274		Sedgewick Cir	Rear	1	Planting Site NW	Cut & Pull Tree In-House	8	8	2016	In-House Removal

FW	14	St. Germain Pl	Front	2	Stump	Removal	8	18	2016	In-House Removal
NE	837	Stuarts Dr	Front	1	Planting Site NE	Removal	8	19	2016	In-House Removal
FW	211	Sunbury Dr	Front	1	DNR	Cut & Pull Tree In-House	8	8	2016	In-House Removal
NE	2813	Turnberry Rd	Front	1	Planting Site NE	Cut & Pull Tree In-House	8	8	2016	In-House Removal
NE	3110	Turnberry Rd	Front	3	Planting Site NE	Cut & Pull Tree In-House	8	8	2016	In-House Removal
NE	1035	X 2nd Ave /N	Front	1	Don't Replant	Removal	7	29	2016	Skyline Tree Service-Removals
NE	1035	X 2nd Ave /N	Front	3	Don't Replant	Removal	7	29	2016	Skyline Tree Service-Removals
NE	1035	2nd Ave /N	Front	2	Don't Replant	Removal	7	29	2016	Skyline Tree Service-Removals
NE	1035	X 2nd Ave /N	Front	2	Don't Replant	Removal	7	29	2016	Skyline Tree Service-Removals
NE	1035	2nd Ave /N	Front	1	Don't Replant	Removal	7	29	2016	Skyline Tree Service-Removals
NE	1840	Allen Ln	Side	1	DNR	Removal	7	29	2016	Skyline Tree Service-Removals
NE	3001	E. Francis Cir	Rear	1	Don't Replant	Call - Storm Damage	7	1	2016	Skyline Tree Service-Removals
SE	1005	Fern Ave	Side	3	Planting Site SE	Removal	7	22	2016	Skyline Tree Service-Removals
SW	810	Kehoe Dr.	Front	1	Planting Site SW	Removal	7	21	2016	Skyline Tree Service-Removals
SE	515	Monroe Ave	Front	1	No Tree Per Resident	Removal	7	6	2016	Skyline Tree Service-Removals
NE	307	Park Ave	Front	1	DNR	Removal	7	13	2016	Skyline Tree Service-Removals
SW	336	14th St /S	Front	1	Planting Site SW	Removal	8	10	2016	Skyline Tree Service-Removals
SW	533	14th St /S	Front	2	Planting Site SW	Removal	8	12	2016	Skyline Tree Service-Removals
SE	707	6th Ave /S	Front	2	Planting Site SE	Removal	8	15	2016	Skyline Tree Service-Removals
SE	112	9th Ave /S	Front	1	Don't Replant	Removal	8	10	2016	Skyline Tree Service-Removals
SE	1553	Andover Ave	Front	1	No Tree Per Resident	Removal	8	15	2016	Skyline Tree Service-Removals
NE	814	Arrowhead Ln	Front	2	Planting Site NE	Removal	8	15	2016	Skyline Tree Service-Removals
SW	1017	Howard St	Front	2	Planting Site SW	Removal	8	12	2016	Skyline Tree Service-Removals
SE	1103	Independence Ave	Front	1	Planting Site SE	Removal	8	15	2016	Skyline Tree Service-Removals
SE	1224	Nicholas Ave	Front	3	Planting Site SE	Removal	8	15	2016	Skyline Tree Service-Removals
SE	1609	Ronzheimer Ave	Front	2	Planting Site SE	Removal	8	15	2016	Skyline Tree Service-Removals
NE	2714	Royal Kings Ct	Front	1	Planting Site NE	Removal	8	15	2016	Skyline Tree Service-Removals
NE	1805	Sterling Ct	Front	2	Maple: Crimson King	Removal	8	15	2016	Skyline Tree Service-Removals
NE	1818	X Sterling Ct	Median	2	Planting Site NE	Removal	8	15	2016	Skyline Tree Service-Removals
NE	1818	X Sterling Ct	Median	1	Planting Site NE	Removal	8	15	2016	Skyline Tree Service-Removals
NE	1818	X Sterling Ct	Median	3	Planting Site NE	Removal	8	15	2016	Skyline Tree Service-Removals
NE	585	Stonehedge Rd	Front	2	Planting Site NE	Removal	8	12	2016	Skyline Tree Service-Removals
NW	921	Wildwood Ct	Side	5	Planting Site NW	Removal	8	15	2016	Skyline Tree Service-Removals
NE	1205	Winners Cup Cir	Front	2	Planting Site NE	Removal	8	15	2016	Skyline Tree Service-Removals
						Removals In-House:	42			
						Removals Contracted:	29			
						Total Removals:	71			

Quadrant	Address	Suffix	Street	Side	Site	Species	WorkType	Completed Date			Completed By
								MM	DD	YY	
NE	1035		2nd Ave /N	Front	2	Don't Replant	Call - Trimming Request	7	29	2016	In-House Trimming
SE	1121		Independence Ave	Front	2	Maple: State Street	Call - CitySourcedReport	7	14	2016	In-House Trimming
SW	501		15th Ct.	Front	2	Locust: Thornless Shademaster	Call - Storm Damage	7	28	2016	In-House Trimming
SW	202		Fairview Dr	Front	1	Locust: Thornless Shademaster	Call - Storm Damage	7	28	2016	In-House Trimming
SW	336		14th St /S	Front	1	Planting Site SW	Call - Storm Damage	7	28	2016	In-House Trimming
SW	1222		Horne St	Front	3	Maple: State Street	Call - Storm Damage	7	28	2016	In-House Trimming
SE	1008		Monroe Ave	Front	1	Walnut: Black	Call - Storm Damage	7	25	2016	In-House Trimming
SW	1120		4th St /S	Front	2	Maple: Crimson King	Call - Trimming Request	7	25	2016	In-House Trimming
NE	902		Secretariat Ct	Front	2	Maple: Crimson King	Call - Trimming Request	7	26	2016	In-House Trimming
NE	902		Secretariat Ct	Front	3	Pear: Aristocrat	Call - Trimming Request	7	26	2016	In-House Trimming
NE	902		Secretariat Ct	Side	4	Elm American	Call - Trimming Request	7	26	2016	In-House Trimming
NE	303		Park Ave	Front	1	Unknown	Call - Trimming Request	7	20	2016	In-House Trimming
NE	402		Park Ave	Front	1	Linden: Glenleven	Call - Trimming Request	7	20	2016	In-House Trimming
NE	902		Secretariat Ct	Side	1	Planetree: London	Call - Trimming Request	7	26	2016	In-House Trimming
SE	1000		Jackson Ave	Front	2	Maple: Silver	Call - Trimming Request	7	27	2016	In-House Trimming
SE	1000		Jackson Ave	Side	1	Maple: Crimson King	Call - Trimming Request	7	27	2016	In-House Trimming
SE	1000		Jackson Ave	Side	4	Oak: Chinkapin	Call - Trimming Request	7	27	2016	In-House Trimming
SE	1000		Jackson Ave	Side	5	Horsechestnut Red: Briotti	Call - Trimming Request	7	27	2016	In-House Trimming
SE	1107		Edward Ave	Front	1	Locust: Thornless Shademaster	Call - Trimming Request	7	12	2016	In-House Trimming
SE	1107		Edward Ave	Front	3	Linden: Littleleaf	Call - Trimming Request	7	12	2016	In-House Trimming
SE	1504		Weber Rd	Front	1	Maple: Crimson King	Call - Trimming Request	7	14	2016	In-House Trimming
SE	1504		Weber Rd	Front	2	Locust: Thornless Shademaster	Call - Trimming Request	7	14	2016	In-House Trimming
NE	902		Secretariat Ct	Side	3	Maple: Crimson King	Call - Trimming Request	7	26	2016	In-House Trimming
NE	1015		2nd Ave /N	Front	4	Hornbeam: American	Call - Trimming Request	7	20	2016	In-House Trimming
NE	1825		Huntington Rd	Front	1	Locust: Thornless Shademaster	Call - Trimming Request	7	28	2016	In-House Trimming
SW	743		Westfield Dr	Front	1	Locust: Thornless Shademaster	Call - Trimming Request	7	18	2016	In-House Trimming
SW	1112		4th St /S	Front	1	Maple: Green Mountain Sugar	Call - Trimming Request	7	25	2016	In-House Trimming
SW	1112		4th St /S	Front	2	Locust: Thornless Shademaster	Call - Trimming Request	7	25	2016	In-House Trimming
NE	402		Park Ave	Front	2	Maple: Celebration Red	Call - Trimming Request	7	20	2016	In-House Trimming
SE	1224		Nicholas Ave	Front	3	Planting Site SE	Call - Trimming Request	7	25	2016	In-House Trimming
SE	1632		13th Ave /S	Front	1	Planting Site SE	Call - Trimming Request	7	26	2016	In-House Trimming
SE	1705		7th Ave /S	Front	2	Maple: Hedge	Call - Trimming Request	7	25	2016	In-House Trimming
SE	1711		Forrest Blvd	Side	1	Locust: Thornless Shademaster	Call - Trimming Request	7	12	2016	In-House Trimming
SE	1713		Patricia Ln	Front	2	Maple: Crimson King	Call - Trimming Request	7	25	2016	In-House Trimming
NE	902		Secretariat Ct	Front	1	Maple: Crimson King	Call - Trimming Request	7	26	2016	In-House Trimming
NE	902		Secretariat Ct	Side	2	Oak: Swamp White	Call - Trimming Request	7	26	2016	In-House Trimming
SE	714		6th Ave /S	Front	2	Maple: Crimson King	Call - Trimming Request	7	13	2016	In-House Trimming
SE	1000		Jackson Ave	Front	3	Maple: Silver	Call - Trimming Request	7	27	2016	In-House Trimming
SE	1000		Jackson Ave	Side	2	Maple: Crimson King	Call - Trimming Request	7	27	2016	In-House Trimming
SE	1107		Edward Ave	Front	2	Locust: Thornless Shademaster	Call - Trimming Request	7	12	2016	In-House Trimming

Quadrant	Address	Suffix	Street	Side	Site	Species	WorkType	Completed Date			Completed By
								MM	DD	YY	
SE	1224		Nicholas Ave	Front	1	Elm Accolade'	Call - Trimming Request	7	25	2016	In-House Trimming
SE	1224		Nicholas Ave	Front	2	Maple: Crimson King	Call - Trimming Request	7	25	2016	In-House Trimming
SE	1224		Nicholas Ave	Side	1	Maple: Crimson King	Call - Trimming Request	7	25	2016	In-House Trimming
SE	1705		7th Ave /S	Front	1	Plum: Newport Cherry	Call - Trimming Request	7	25	2016	In-House Trimming
SE	1747		Pleasant Ave	Front	1	Birch: River	Call - Trimming Request	7	12	2016	In-House Trimming
SE	1810		Emery Ct	Front	1	Elm: Commendation	Call - Trimming Request	7	12	2016	In-House Trimming
SW	1120		4th St /S	Front	1	Maple: Crimson King	Call - Trimming Request	7	25	2016	In-House Trimming
NE	402		Park Ave	Side	2	Linden Redmond	Call - Trimming Request	7	20	2016	In-House Trimming
NE	517		Longmeadow Cir	Front	1	Locust: Thornless Shademaster	Call - Trimming Request	7	25	2016	In-House Trimming
NE	1825		Huntington Rd	Front	2	Locust: Thornless Shademaster	Call - Trimming Request	7	28	2016	In-House Trimming
SE	316		4th Ave /S	Front	1	Stump	Call - Trimming Request	7	12	2016	In-House Trimming
SE	607		Spring Ave	Front	1	Maple: Silver	Call - Trimming Request	7	25	2016	In-House Trimming
SE	1000		Jackson Ave	Front	1	Maple: Crimson King	Call - Trimming Request	7	27	2016	In-House Trimming
SE	1000		Jackson Ave	Side	3	Maple: Crimson King	Call - Trimming Request	7	27	2016	In-House Trimming
SE	1224		Nicholas Ave	Side	2	Linden: Basswood	Call - Trimming Request	7	25	2016	In-House Trimming
SE	1553		Andover Ave	Front	1	No Tree Per Resident	Call - Trimming Request	7	14	2016	In-House Trimming
SE	1801		Cumberland Grn Dr	Front	1	Locust: Thornless Shademaster	Call - Trimming Request	7	25	2016	In-House Trimming
NE	11		2nd Ave /N	Front	1	Linden: Littleleaf	Prune - Crown Clean NE	7	14	2016	In-House Trimming
NE	105		2nd Ave /N	Front	1	Ash Removed	Prune - Crown Clean NE	7	14	2016	In-House Trimming
NE	105		2nd Ave /N	Front	3	Linden: Littleleaf	Prune - Crown Clean NE	7	14	2016	In-House Trimming
NE	112 X		2nd Ave /N	Front	1	Lilac Ivory Silk	Prune - Crown Clean NE	7	14	2016	In-House Trimming
NE	202		2nd Ave /N	Side	1	Chokecherry Canada Red	Prune - Crown Clean NE	7	14	2016	In-House Trimming
NE	304		2nd Ave /N	Front	3	Buckeye	Prune - Crown Clean NE	7	14	2016	In-House Trimming
NE	304		2nd Ave /N	Front	4	Pear: Redspire	Prune - Crown Clean NE	7	14	2016	In-House Trimming
NE	311 X		2nd Ave /N	Front	2	Maple: Crimson King	Prune - Crown Clean NE	7	14	2016	In-House Trimming
NE	312		2nd Ave /N	Front	1	Hawthorn: Thornless Cockspur	Prune - Crown Clean NE	7	14	2016	In-House Trimming
NE	416		2nd Ave /N	Side	3	Maple: Sugar	Prune - Crown Clean NE	7	14	2016	In-House Trimming
NE	506		2nd Ave /N	Side	2	Elm Homestead	Prune - Crown Clean NE	7	14	2016	In-House Trimming
NE	516		2nd Ave /N	Side	2	Maple: Silver	Prune - Crown Clean NE	7	14	2016	In-House Trimming
NE	606		2nd Ave /N	Side	2	Maple: Crimson King	Prune - Crown Clean NE	7	14	2016	In-House Trimming
NE	616		2nd Ave /N	Front	2	Maple: Autumn Blaze	Prune - Crown Clean NE	7	14	2016	In-House Trimming
NE	620		2nd Ave /N	Front	1	Elm Triumph	Prune - Crown Clean NE	7	14	2016	In-House Trimming
NE	627 X		2nd Ave /N	Front	4	Linden Redmond	Prune - Crown Clean NE	7	14	2016	In-House Trimming
NE	713 x		2nd Ave /N	Front	1	Ginkgo: Magyar	Prune - Crown Clean NE	7	14	2016	In-House Trimming
NE	713 X		2nd Ave /N	Front	3	Locust: Thornless Shademaster	Prune - Crown Clean NE	7	14	2016	In-House Trimming
NE	901		2nd Ave /N	Front	1	Oak: White	Prune - Crown Clean NE	7	14	2016	In-House Trimming
NE	1015		2nd Ave /N	Front	3	Lilac: China Snow	Prune - Crown Clean NE	7	14	2016	In-House Trimming
NE	1025		2nd Ave /N	Front	2	Serviceberry	Prune - Crown Clean NE	7	14	2016	In-House Trimming
NE	1905		Fairfax Rd	Front	1	Locust: Thornless Shademaster	Prune - Crown Clean NE	7	18	2016	In-House Trimming
NE	1905		Fairfax Rd	Side	1	Maple: Autumn Blaze	Prune - Crown Clean NE	7	18	2016	In-House Trimming

Quadrant	Address	Suffix	Street	Side	Site	Species	WorkType	Completed Date			Completed By
								MM	DD	YY	
NE	1915		Fairfax Rd	Front	1	Hornbeam: American	Prune - Crown Clean NE	7	18	2016	In-House Trimming
NE	1920		Fairfax Rd	Front	2	Ash Removed	Prune - Crown Clean NE	7	18	2016	In-House Trimming
NE	1935		Fairfax Rd	Front	1	Hackberry Common	Prune - Crown Clean NE	7	18	2016	In-House Trimming
NE	1935		Fairfax Rd	Front	2	Linden: Littleleaf	Prune - Crown Clean NE	7	18	2016	In-House Trimming
NE	2005		Fairfax Rd	Front	1	Hornbeam: American	Prune - Crown Clean NE	7	18	2016	In-House Trimming
NE	2015		Fairfax Rd	Front	1	Maple: Autumn Blaze	Prune - Crown Clean NE	7	18	2016	In-House Trimming
NE	2100		Fairfax Rd	Front	1	Maple: Brandywine	Prune - Crown Clean NE	7	18	2016	In-House Trimming
NE	2200		Fairfax Rd	Front	1	Planting Site NE	Prune - Crown Clean NE	7	18	2016	In-House Trimming
NE	2215		Fairfax Rd	Front	1	Ginkgo	Prune - Crown Clean NE	7	18	2016	In-House Trimming
NE	2225		Fairfax Rd	Front	1	Linden: Littleleaf	Prune - Crown Clean NE	7	18	2016	In-House Trimming
NE	17		2nd Ave /N	Side	2	Linden Redmond	Prune - Crown Clean NE	7	14	2016	In-House Trimming
NE	112	X	2nd Ave /N	Front	2	Lilac Ivory Silk	Prune - Crown Clean NE	7	14	2016	In-House Trimming
NE	202		2nd Ave /N	Side	2	Planting Site:Large	Prune - Crown Clean NE	7	14	2016	In-House Trimming
NE	304		2nd Ave /N	Front	2	Crabapple: Royal Raindrops	Prune - Crown Clean NE	7	14	2016	In-House Trimming
NE	416		2nd Ave /N	Side	1	Serviceberry	Prune - Crown Clean NE	7	14	2016	In-House Trimming
NE	416		2nd Ave /N	Rear	1	Crabapple: Red Jewel	Prune - Crown Clean NE	7	14	2016	In-House Trimming
NE	416		2nd Ave /N	Rear	2	Don't Replant	Prune - Crown Clean NE	7	14	2016	In-House Trimming
NE	416		2nd Ave /N	Rear	3	Linden: Summer Sprite	Prune - Crown Clean NE	7	14	2016	In-House Trimming
NE	506		2nd Ave /N	Front	2	No Tree Per Resident	Prune - Crown Clean NE	7	14	2016	In-House Trimming
NE	506		2nd Ave /N	Side	1	Maple: Crimson King	Prune - Crown Clean NE	7	14	2016	In-House Trimming
NE	516		2nd Ave /N	Front	2	Stump	Prune - Crown Clean NE	7	14	2016	In-House Trimming
NE	516		2nd Ave /N	Side	1	Maple: Marmo Freeman	Prune - Crown Clean NE	7	14	2016	In-House Trimming
NE	517	X	2nd Ave /N	Front	3	Oak: Chinkapin	Prune - Crown Clean NE	7	14	2016	In-House Trimming
NE	606		2nd Ave /N	Front	1	Maple: Crimson King	Prune - Crown Clean NE	7	14	2016	In-House Trimming
NE	606		2nd Ave /N	Front	2	Maple: Marmo	Prune - Crown Clean NE	7	14	2016	In-House Trimming
NE	616		2nd Ave /N	Front	1	Hackberry Common	Prune - Crown Clean NE	7	14	2016	In-House Trimming
NE	627	X	2nd Ave /N	Front	2	Commendation: Elm	Prune - Crown Clean NE	7	14	2016	In-House Trimming
NE	708		2nd Ave /N	Front	1	Maple: Royal Red	Prune - Crown Clean NE	7	14	2016	In-House Trimming
NE	718		2nd Ave /N	Front	1	Maple: Autumn Blaze	Prune - Crown Clean NE	7	14	2016	In-House Trimming
NE	2315		Fairfax Rd	Front	3	Cherry: Choke	Prune - Crown Clean NE	7	18	2016	In-House Trimming
NE	2325		Fairfax Rd	Front	1	Linden: Littleleaf	Prune - Crown Clean NE	7	18	2016	In-House Trimming
NE	2405		Fairfax Rd	Front	1	Linden: Littleleaf	Prune - Crown Clean NE	7	18	2016	In-House Trimming
NE	2415		Fairfax Rd	Front	1	Linden: Littleleaf	Prune - Crown Clean NE	7	18	2016	In-House Trimming
NE	2420		Fairfax Rd	Front	2	Linden: Littleleaf	Prune - Crown Clean NE	7	18	2016	In-House Trimming
NE	970		2nd Ave /N	Front	1	Oak: White	Prune - Crown Clean NE	7	14	2016	In-House Trimming
NE	1025		2nd Ave /N	Front	1	Crabapple: Royal Raindrops	Prune - Crown Clean NE	7	14	2016	In-House Trimming
NE	1026	X	2nd Ave /N	Front	1	Elm American	Prune - Crown Clean NE	7	14	2016	In-House Trimming
NE	1900		Fairfax Rd	Front	3	Maple: Crimson King	Prune - Crown Clean NE	7	18	2016	In-House Trimming
NE	1900		Fairfax Rd	Side	2	Maple: Crimson King	Prune - Crown Clean NE	7	18	2016	In-House Trimming
NE	1920		Fairfax Rd	Front	3	Locust: Thornless Skyline	Prune - Crown Clean NE	7	18	2016	In-House Trimming

Quadrant	Address	Suffix	Street	Side	Site	Species	WorkType	Completed Date			Completed By
								MM	DD	YY	
NE	1920		Fairfax Rd	Front	4	DNR	Prune - Crown Clean NE	7	18	2016	In-House Trimming
NE	1935		Fairfax Rd	Front	3	Maple: Crimson King	Prune - Crown Clean NE	7	18	2016	In-House Trimming
NE	2005		Fairfax Rd	Front	2	Ash Removed	Prune - Crown Clean NE	7	18	2016	In-House Trimming
NE	2010		Fairfax Rd	Front	1	Lilac Ivory Silk	Prune - Crown Clean NE	7	18	2016	In-House Trimming
NE	2020		Fairfax Rd	Front	1	Maple: State Street	Prune - Crown Clean NE	7	18	2016	In-House Trimming
NE	2105		Fairfax Rd	Front	2	Elm Accolade'	Prune - Crown Clean NE	7	18	2016	In-House Trimming
NE	2110		Fairfax Rd	Front	1	Maple: Autumn Blaze	Prune - Crown Clean NE	7	18	2016	In-House Trimming
NE	17		2nd Ave /N	Side	1	Linden Redmond	Prune - Crown Clean NE	7	14	2016	In-House Trimming
NE	304		2nd Ave /N	Side	2	Linden: Littleleaf	Prune - Crown Clean NE	7	14	2016	In-House Trimming
NE	312	X	2nd Ave /N	Front	1	DNR	Prune - Crown Clean NE	7	14	2016	In-House Trimming
NE	416		2nd Ave /N	Side	6	DNR	Prune - Crown Clean NE	7	14	2016	In-House Trimming
NE	417	X	2nd Ave /N	Front	1	Locust: Thornless Shademaster	Prune - Crown Clean NE	7	14	2016	In-House Trimming
NE	417	X	2nd Ave /N	Front	2	Linden: Littleleaf	Prune - Crown Clean NE	7	14	2016	In-House Trimming
NE	506		2nd Ave /N	Front	1	Maple: Crimson King	Prune - Crown Clean NE	7	14	2016	In-House Trimming
NE	506		2nd Ave /N	Front	3	Maple: Autumn Blaze	Prune - Crown Clean NE	7	14	2016	In-House Trimming
NE	516		2nd Ave /N	Front	1	Oak: Chinkapin	Prune - Crown Clean NE	7	14	2016	In-House Trimming
NE	516		2nd Ave /N	Side	3	Maple: Silver	Prune - Crown Clean NE	7	14	2016	In-House Trimming
NE	517	X	2nd Ave /N	Front	4	Pear: Redspire	Prune - Crown Clean NE	7	14	2016	In-House Trimming
NE	605	X	2nd Ave /N	Front	2	Locust: Thornless Shademaster	Prune - Crown Clean NE	7	14	2016	In-House Trimming
NE	606		2nd Ave /N	Side	3	Maple: Crimson King	Prune - Crown Clean NE	7	14	2016	In-House Trimming
NE	620		2nd Ave /N	Front	2	Maple: Autumn Blaze	Prune - Crown Clean NE	7	14	2016	In-House Trimming
NE	627	X	2nd Ave /N	Front	5	Maple: Green Mountain Sugar	Prune - Crown Clean NE	7	14	2016	In-House Trimming
NE	627	X	2nd Ave /N	Front	6	Locust: Thornless Shademaster	Prune - Crown Clean NE	7	14	2016	In-House Trimming
NE	628		2nd Ave /N	Front	2	Oak: Red	Prune - Crown Clean NE	7	14	2016	In-House Trimming
NE	712		2nd Ave /N	Front	1	No Tree Per Resident	Prune - Crown Clean NE	7	14	2016	In-House Trimming
NE	2115		Fairfax Rd	Front	2	Maple: Autumn Blaze	Prune - Crown Clean NE	7	18	2016	In-House Trimming
NE	2120		Fairfax Rd	Front	1	Maple: Crimson King	Prune - Crown Clean NE	7	18	2016	In-House Trimming
NE	2125		Fairfax Rd	Front	2	Maple: Autumn Blaze	Prune - Crown Clean NE	7	18	2016	In-House Trimming
NE	2130		Fairfax Rd	Front	1	Maple: Crimson King	Prune - Crown Clean NE	7	18	2016	In-House Trimming
NE	2130		Fairfax Rd	Front	2	Ash Removed	Prune - Crown Clean NE	7	18	2016	In-House Trimming
NE	2200		Fairfax Rd	Front	2	Linden: Littleleaf	Prune - Crown Clean NE	7	18	2016	In-House Trimming
NE	2210		Fairfax Rd	Front	2	Linden: Littleleaf	Prune - Crown Clean NE	7	18	2016	In-House Trimming
NE	2300		Fairfax Rd	Front	2	Maple: Green Mountain Sugar	Prune - Crown Clean NE	7	18	2016	In-House Trimming
NE	2305		Fairfax Rd	Front	1	Maple: Autumn Blaze	Prune - Crown Clean NE	7	18	2016	In-House Trimming
NE	2310		Fairfax Rd	Front	2	Unknown	Prune - Crown Clean NE	7	18	2016	In-House Trimming
NE	2320		Fairfax Rd	Front	1	Linden: Littleleaf	Prune - Crown Clean NE	7	18	2016	In-House Trimming
NE	2410		Fairfax Rd	Front	1	Linden: Littleleaf	Prune - Crown Clean NE	7	18	2016	In-House Trimming
NE	2415		Fairfax Rd	Front	2	Maple: Crimson King	Prune - Crown Clean NE	7	18	2016	In-House Trimming
NE	2420		Fairfax Rd	Front	1	Linden: Littleleaf	Prune - Crown Clean NE	7	18	2016	In-House Trimming
NE	713		2nd Ave /N	Front	4	Elm Homestead	Prune - Crown Clean NE	7	14	2016	In-House Trimming

Quadrant	Address	Suffix	Street	Side	Site	Species	WorkType	Completed Date			Completed By
								MM	DD	YY	
NE	960		2nd Ave /N	Front	1	Oak: White	Prune - Crown Clean NE	7	14	2016	In-House Trimming
NE	1015		2nd Ave /N	Front	2	Lilac: China Snow	Prune - Crown Clean NE	7	14	2016	In-House Trimming
NE	1016	X	2nd Ave /N	Front	2	Oak: White	Prune - Crown Clean NE	7	14	2016	In-House Trimming
NE	1035		2nd Ave /N	Front	2	Don't Replant	Prune - Crown Clean NE	7	14	2016	In-House Trimming
NE	1900		Fairfax Rd	Front	1	Elm: Spp.	Prune - Crown Clean NE	7	18	2016	In-House Trimming
NE	1900		Fairfax Rd	Front	2	Maple: Crimson King	Prune - Crown Clean NE	7	18	2016	In-House Trimming
NE	1900		Fairfax Rd	Side	1	Maple: Crimson King	Prune - Crown Clean NE	7	18	2016	In-House Trimming
NE	1905		Fairfax Rd	Front	2	Locust: Thornless Shademaster	Prune - Crown Clean NE	7	18	2016	In-House Trimming
NE	1925		Fairfax Rd	Front	2	Linden: Littleleaf	Prune - Crown Clean NE	7	18	2016	In-House Trimming
NE	1930		Fairfax Rd	Front	1	Buckeye: Yellow	Prune - Crown Clean NE	7	18	2016	In-House Trimming
NE	1930		Fairfax Rd	Front	2	Maple: Freeman	Prune - Crown Clean NE	7	18	2016	In-House Trimming
NE	2000		Fairfax Rd	Front	1	Elm: Patriot	Prune - Crown Clean NE	7	18	2016	In-House Trimming
NE	2000		Fairfax Rd	Front	2	Maple: Marmo	Prune - Crown Clean NE	7	18	2016	In-House Trimming
NE	2010		Fairfax Rd	Front	2	Oak: Red	Prune - Crown Clean NE	7	18	2016	In-House Trimming
NE	2020		Fairfax Rd	Front	2	Linden Littleleaf Greenspire	Prune - Crown Clean NE	7	18	2016	In-House Trimming
NE	2110		Fairfax Rd	Front	2	Linden Littleleaf Greenspire	Prune - Crown Clean NE	7	18	2016	In-House Trimming
NE	2125		Fairfax Rd	Front	1	Linden: Littleleaf	Prune - Crown Clean NE	7	18	2016	In-House Trimming
NE	2125		Fairfax Rd	Side	1	Maple: Crimson King	Prune - Crown Clean NE	7	18	2016	In-House Trimming
NE	2125		Fairfax Rd	Side	2	Elm Princeton	Prune - Crown Clean NE	7	18	2016	In-House Trimming
NE	2220		Fairfax Rd	Front	2	Linden: Littleleaf	Prune - Crown Clean NE	7	18	2016	In-House Trimming
NE	2300		Fairfax Rd	Front	1	Maple: Green Mountain Sugar	Prune - Crown Clean NE	7	18	2016	In-House Trimming
NE	2310		Fairfax Rd	Front	1	Unknown	Prune - Crown Clean NE	7	18	2016	In-House Trimming
NE	2320		Fairfax Rd	Front	2	Linden: Littleleaf	Prune - Crown Clean NE	7	18	2016	In-House Trimming
NE	2325		Fairfax Rd	Front	2	Unknown	Prune - Crown Clean NE	7	18	2016	In-House Trimming
NE	17		2nd Ave /N	Front	1	Linden Redmond	Prune - Crown Clean NE	7	14	2016	In-House Trimming
NE	105		2nd Ave /N	Front	2	Lilac Japanese Tree	Prune - Crown Clean NE	7	14	2016	In-House Trimming
NE	112	X	2nd Ave /N	Front	3	Lilac Ivory Silk	Prune - Crown Clean NE	7	14	2016	In-House Trimming
NE	115		2nd Ave /N	Front	1	Maple: Brandywine	Prune - Crown Clean NE	7	14	2016	In-House Trimming
NE	215		2nd Ave /N	Front	1	Maple: Crescendo Sugar	Prune - Crown Clean NE	7	14	2016	In-House Trimming
NE	215		2nd Ave /N	Front	2	Elm Triumph	Prune - Crown Clean NE	7	14	2016	In-House Trimming
NE	304		2nd Ave /N	Front	1	Pear: Redspire	Prune - Crown Clean NE	7	14	2016	In-House Trimming
NE	304		2nd Ave /N	Side	1	Apple: Common	Prune - Crown Clean NE	7	14	2016	In-House Trimming
NE	311	X	2nd Ave /N	Front	1	Maple: Crimson King	Prune - Crown Clean NE	7	14	2016	In-House Trimming
NE	416		2nd Ave /N	Side	2	Maple: Marmo	Prune - Crown Clean NE	7	14	2016	In-House Trimming
NE	416		2nd Ave /N	Side	4	Serviceberry	Prune - Crown Clean NE	7	14	2016	In-House Trimming
NE	416		2nd Ave /N	Side	5	DNR	Prune - Crown Clean NE	7	14	2016	In-House Trimming
NE	517	X	2nd Ave /N	Front	1	Elm Homestead	Prune - Crown Clean NE	7	14	2016	In-House Trimming
NE	517	X	2nd Ave /N	Front	2	Planetree: London	Prune - Crown Clean NE	7	14	2016	In-House Trimming
NE	605	X	2nd Ave /N	Front	1	Lilac: China Snow	Prune - Crown Clean NE	7	14	2016	In-House Trimming
NE	605	X	2nd Ave /N	Front	3	Maple: Green Mountain Sugar	Prune - Crown Clean NE	7	14	2016	In-House Trimming

Quadrant	Address	Suffix	Street	Side	Site	Species	WorkType	Completed Date			Completed By
								MM	DD	YY	
NE	606		2nd Ave /N	Front	3	Maple: State Street	Prune - Crown Clean NE	7	14	2016	In-House Trimming
NE	606		2nd Ave /N	Side	1	Elm American	Prune - Crown Clean NE	7	14	2016	In-House Trimming
NE	627	X	2nd Ave /N	Front	1	Maple: State Street	Prune - Crown Clean NE	7	14	2016	In-House Trimming
NE	627	X	2nd Ave /N	Front	3	Maple: Crimson King	Prune - Crown Clean NE	7	14	2016	In-House Trimming
NE	628		2nd Ave /N	Front	1	Future Planting Site NW	Prune - Crown Clean NE	7	14	2016	In-House Trimming
NE	708		2nd Ave /N	Front	2	Maple: Autumn Blaze	Prune - Crown Clean NE	7	14	2016	In-House Trimming
NE	712		2nd Ave /N	Front	2	No Tree Per Resident	Prune - Crown Clean NE	7	14	2016	In-House Trimming
NE	713	X	2nd Ave /N	Front	2	Elm: Regal	Prune - Crown Clean NE	7	14	2016	In-House Trimming
NE	718		2nd Ave /N	Front	2	Maple: Autumn Blaze	Prune - Crown Clean NE	7	14	2016	In-House Trimming
NE	955		2nd Ave /N	Front	1	Ash Removed	Prune - Crown Clean NE	7	14	2016	In-House Trimming
NE	965		2nd Ave /N	Front	1	Oak: White	Prune - Crown Clean NE	7	14	2016	In-House Trimming
NE	970		2nd Ave /N	Front	2	Oak: White	Prune - Crown Clean NE	7	14	2016	In-House Trimming
NE	975		2nd Ave /N	Front	1	Cherry: Black	Prune - Crown Clean NE	7	14	2016	In-House Trimming
NE	975		2nd Ave /N	Front	2	Elm American	Prune - Crown Clean NE	7	14	2016	In-House Trimming
NE	1015		2nd Ave /N	Front	1	Hornbeam: American	Prune - Crown Clean NE	7	14	2016	In-House Trimming
NE	1016	X	2nd Ave /N	Front	1	Oak: White	Prune - Crown Clean NE	7	14	2016	In-House Trimming
NE	1032		2nd Ave /N	Front	1	Oak: White	Prune - Crown Clean NE	7	14	2016	In-House Trimming
NE	1905		Fairfax Rd	Side	2	Maple: Marmo Freeman	Prune - Crown Clean NE	7	18	2016	In-House Trimming
NE	1915		Fairfax Rd	Front	2	Hornbeam: American	Prune - Crown Clean NE	7	18	2016	In-House Trimming
NE	1920		Fairfax Rd	Front	1	Maple: Karpick	Prune - Crown Clean NE	7	18	2016	In-House Trimming
NE	1925		Fairfax Rd	Front	1	Hornbeam: American	Prune - Crown Clean NE	7	18	2016	In-House Trimming
NE	2015		Fairfax Rd	Front	2	Locust: Thornless Skyline	Prune - Crown Clean NE	7	18	2016	In-House Trimming
NE	2105		Fairfax Rd	Front	1	Maple: Crimson King	Prune - Crown Clean NE	7	18	2016	In-House Trimming
NE	2105		Fairfax Rd	Front	3	Oak: Swamp White	Prune - Crown Clean NE	7	18	2016	In-House Trimming
NE	2115		Fairfax Rd	Front	1	Maple: Marmo	Prune - Crown Clean NE	7	18	2016	In-House Trimming
NE	2210		Fairfax Rd	Front	1	Linden: Littleleaf	Prune - Crown Clean NE	7	18	2016	In-House Trimming
NE	2220		Fairfax Rd	Front	1	Linden: Littleleaf	Prune - Crown Clean NE	7	18	2016	In-House Trimming
NE	2305		Fairfax Rd	Front	2	Linden: Littleleaf	Prune - Crown Clean NE	7	18	2016	In-House Trimming
NE	2315		Fairfax Rd	Front	1	Cherry: Choke	Prune - Crown Clean NE	7	18	2016	In-House Trimming
NE	2315		Fairfax Rd	Front	2	Linden: Littleleaf	Prune - Crown Clean NE	7	18	2016	In-House Trimming
NE	2315		Fairfax Rd	Front	4	Cherry: Choke	Prune - Crown Clean NE	7	18	2016	In-House Trimming
NE	2410		Fairfax Rd	Front	2	Unknown	Prune - Crown Clean NE	7	18	2016	In-House Trimming
SW	1426		12th St /S	Front	2	Locust: Thornless Shademaster	Prune - Hanger	7	1	2016	In-House Trimming
SE	1613		13th Ave /S	Front	1	Locust: Thornless Shademaster	Prune - Hazard Reduction	7	12	2016	In-House Trimming
SW	900		4th St /S	Front	1	Maple: Autumn Blaze	Prune - Young Tree	7	27	2016	In-House Trimming
NE	1490		Iroquois Ave	Front	1	Elm Accolade'	Trimming-Internal Request	7	28	2016	In-House Trimming
NE	1490		Iroquois Ave	Front	2	Hackberry Common	Trimming-Internal Request	7	28	2016	In-House Trimming
NE	1490		Iroquois Ave	Front	3	Maple: Crimson King	Trimming-Internal Request	7	28	2016	In-House Trimming
NW	3809		Grandview Ct.	Front	1	Elm Homestead	Trimming-Internal Request	7	14	2016	In-House Trimming
NE	1490		Iroquois Ave	Side	2	Hackberry Common	Trimming-Internal Request	7	28	2016	In-House Trimming

Quadrant	Address	Suffix	Street	Side	Site	Species	WorkType	Completed Date			Completed By
								MM	DD	YY	
NE	1490		Iroquois Ave	Side	1	Maple: Autumn Blaze	Trimming-Internal Request	7	28	2016	In-House Trimming
NE	1490		Iroquois Ave	Side	3	Locust: Thornless Skyline	Trimming-Internal Request	7	28	2016	In-House Trimming
SE	217		3rd Ave /S	Side	1	Maple: Autumn Blaze	Trimming-Internal Request	7	13	2016	In-House Trimming
SW	501		Walnut St	Front	1	Locust: Black	Call - CitySourcedReport	8	5	2016	In-House Trimming
SE	402		7th Ave /S	Front	4	Locust: Thornless Shademaster	Call - CitySourcedReport	8	8	2016	In-House Trimming
SE	1703		Rita Ave	Front	1	Maple: Autumn Blaze	Call - CitySourcedReport	8	5	2016	In-House Trimming
NW	204 X		Crane Rd	Front	2	DNR	Call - Trimming Request	8	17	2016	In-House Trimming
SW	533		14th St /S	Front	1	Maple: Red Sunset	Call - Trimming Request	8	5	2016	In-House Trimming
SW	818		Horne St	Front	1	Maple: Crimson King	Call - Trimming Request	8	10	2016	In-House Trimming
SW	818		Horne St	Front	2	Maple: Crimson King	Call - Trimming Request	8	10	2016	In-House Trimming
NE	1503		Keim Ct	Front	1	Maple: Red Sunset	Call - Trimming Request	8	8	2016	In-House Trimming
NE	1503		Keim Ct	Front	2	Locust: Thornless Shademaster	Call - Trimming Request	8	8	2016	In-House Trimming
SW	1108		10th St /S	Front	1	Ash Removed	Call - Trimming Request	8	10	2016	In-House Trimming
SW	1707		Evergreen St	Front	1	Locust: Thornless Shademaster	Call - Trimming Request	8	11	2016	In-House Trimming
SE	635		Ohio Ave	Front	1	Maple: Crimson King	Call - Trimming Request	8	10	2016	In-House Trimming
SE	1415		Rita Ave	Front	1	Linden: Basswood	Call - Trimming Request	8	5	2016	In-House Trimming
SE	1717		Cambridge Dr	Front	2	Locust: Thornless Shademaster	Call - Trimming Request	8	10	2016	In-House Trimming
SE	1902		Moore Ave	Front	1	Maple: Green Mountain Sugar	Call - Trimming Request	8	8	2016	In-House Trimming
NE	1503		Keim Ct	Front	3	Locust: Thornless Shademaster	Call - Trimming Request	8	8	2016	In-House Trimming
NE	2500 X		Fox Chase Blvd	Median	14	Apple: Common	Call - Trimming Request	8	1	2016	In-House Trimming
SE	927		12th Ave /S	Side	1	Coffeetree: Kentucky	Call - Trimming Request	8	8	2016	In-House Trimming
SE	1933		Forrest Blvd	Front	1	Locust: Thornless Shademaster	Call - Trimming Request	8	8	2016	In-House Trimming
NE	3807		King James Ct	Front	1	Elm Accolade'	Call - Trimming Request	8	10	2016	In-House Trimming
SE	1710		Cambridge Dr	Front	1	Locust: Thornless Shademaster	Call - Trimming Request	8	8	2016	In-House Trimming
NE	3808		King James Ct	Front	1	Maple: Freeman	Call - Trimming Request	8	10	2016	In-House Trimming
SE	406		6th Ave /S	Front	1	Maple: Crimson King	Call - Trimming Request	8	11	2016	In-House Trimming
SE	1902		Moore Ave	Front	3	Maple: Crimson King	Call - Trimming Request	8	8	2016	In-House Trimming
NW	202		Windsor Cir	Front	3	Linden: Littleleaf	Prune - Crown Clean NW	8	19	2016	In-House Trimming
NW	203		Windsor Cir	Front	3	Maple: Crimson King	Prune - Crown Clean NW	8	19	2016	In-House Trimming
NW	205		Windsor Cir	Front	1	Linden Redmond	Prune - Crown Clean NW	8	19	2016	In-House Trimming
NW	205		Windsor Cir	Rear	2	Don't Replant	Prune - Crown Clean NW	8	19	2016	In-House Trimming
NW	206		Windsor Cir	Front	1	Maple: Red Sunset	Prune - Crown Clean NW	8	19	2016	In-House Trimming
NW	207		Windsor Cir	Front	1	Linden: Littleleaf	Prune - Crown Clean NW	8	19	2016	In-House Trimming
NW	207		Windsor Cir	Rear	3	Don't Replant	Prune - Crown Clean NW	8	19	2016	In-House Trimming
NW	208		Windsor Cir	Front	4	Pear: Aristocrat	Prune - Crown Clean NW	8	19	2016	In-House Trimming
NW	211		Windsor Cir	Front	3	Maple: State Street	Prune - Crown Clean NW	8	19	2016	In-House Trimming
NW	303		Windsor Cir	Front	2	Linden: Littleleaf	Prune - Crown Clean NW	8	19	2016	In-House Trimming
NW	304		Windsor Cir	Front	4	Linden: Littleleaf	Prune - Crown Clean NW	8	19	2016	In-House Trimming
NW	309		Windsor Cir	Front	1	Locust: Thornless Skyline	Prune - Crown Clean NW	8	19	2016	In-House Trimming
NW	311		Windsor Cir	Front	1	Larch: American	Prune - Crown Clean NW	8	19	2016	In-House Trimming

Quadrant	Address	Suffix	Street	Side	Site	Species	WorkType	Completed Date			Completed By
								MM	DD	YY	
NW	311		Windsor Cir	Front	2	Oak: Red	Prune - Crown Clean NW	8	19	2016	In-House Trimming
NW	202		Windsor Cir	Front	1	Elm: Commendation	Prune - Crown Clean NW	8	19	2016	In-House Trimming
NW	202		Windsor Cir	Front	4	Linden: Littleleaf	Prune - Crown Clean NW	8	19	2016	In-House Trimming
NW	202		Windsor Cir	Front	5	Locust: Thornless Shademaster	Prune - Crown Clean NW	8	19	2016	In-House Trimming
NW	202		Windsor Cir	Side	1	Locust: Thornless Shademaster	Prune - Crown Clean NW	8	19	2016	In-House Trimming
NW	204		Windsor Cir	Front	2	Linden: Littleleaf	Prune - Crown Clean NW	8	19	2016	In-House Trimming
NW	207		Windsor Cir	Front	2	Linden: Littleleaf	Prune - Crown Clean NW	8	19	2016	In-House Trimming
NW	207		Windsor Cir	Rear	1	Don't Replant	Prune - Crown Clean NW	8	19	2016	In-House Trimming
NW	208		Windsor Cir	Front	1	Maple: Crimson King	Prune - Crown Clean NW	8	19	2016	In-House Trimming
NW	208		Windsor Cir	Front	5	Maple: Autumn Blaze	Prune - Crown Clean NW	8	19	2016	In-House Trimming
NW	302		Windsor Cir	Front	3	Maple: Crimson King	Prune - Crown Clean NW	8	19	2016	In-House Trimming
NW	302		Windsor Cir	Front	4	Maple: Red Sunset	Prune - Crown Clean NW	8	19	2016	In-House Trimming
NW	302		Windsor Cir	Front	6	Maple: Crimson King	Prune - Crown Clean NW	8	19	2016	In-House Trimming
NW	303		Windsor Cir	Front	1	Elm Homestead	Prune - Crown Clean NW	8	19	2016	In-House Trimming
NW	304		Windsor Cir	Front	1	Hackberry Common	Prune - Crown Clean NW	8	19	2016	In-House Trimming
NW	305		Windsor Cir	Front	3	Ginkgo	Prune - Crown Clean NW	8	19	2016	In-House Trimming
NW	202		Windsor Cir	Front	2	Maple: Crimson King	Prune - Crown Clean NW	8	19	2016	In-House Trimming
NW	202		Windsor Cir	Side	2	Maple: Brandywine	Prune - Crown Clean NW	8	19	2016	In-House Trimming
NW	202		Windsor Cir	Side	3	Maple: State Street	Prune - Crown Clean NW	8	19	2016	In-House Trimming
NW	202		Windsor Cir	Side	4	Hackberry Common	Prune - Crown Clean NW	8	19	2016	In-House Trimming
NW	203		Windsor Cir	Front	1	Maple: Green Mountain Sugar	Prune - Crown Clean NW	8	19	2016	In-House Trimming
NW	203		Windsor Cir	Front	4	Maple: Crimson King	Prune - Crown Clean NW	8	19	2016	In-House Trimming
NW	204		Windsor Cir	Front	1	Elm Frontier	Prune - Crown Clean NW	8	19	2016	In-House Trimming
NW	204		Windsor Cir	Front	3	Maple: Crimson King	Prune - Crown Clean NW	8	19	2016	In-House Trimming
NW	205		Windsor Cir	Front	2	Linden Redmond	Prune - Crown Clean NW	8	19	2016	In-House Trimming
NW	205		Windsor Cir	Rear	1	Don't Replant	Prune - Crown Clean NW	8	19	2016	In-House Trimming
NW	206		Windsor Cir	Front	2	Maple: Crescendo Sugar	Prune - Crown Clean NW	8	19	2016	In-House Trimming
NW	206		Windsor Cir	Front	4	Linden Littleleaf Greenspire	Prune - Crown Clean NW	8	19	2016	In-House Trimming
NW	206		Windsor Cir	Front	5	Unknown	Prune - Crown Clean NW	8	19	2016	In-House Trimming
NW	207		Windsor Cir	Front	3	Linden Littleleaf Greenspire	Prune - Crown Clean NW	8	19	2016	In-House Trimming
NW	207		Windsor Cir	Rear	2	Don't Replant	Prune - Crown Clean NW	8	19	2016	In-House Trimming
NW	211		Windsor Cir	Front	1	Pear Chanticleer	Prune - Crown Clean NW	8	19	2016	In-House Trimming
NW	211		Windsor Cir	Front	2	Maple: Freeman	Prune - Crown Clean NW	8	19	2016	In-House Trimming
NW	301		Windsor Cir	Front	3	Linden: Littleleaf	Prune - Crown Clean NW	8	19	2016	In-House Trimming
NW	302		Windsor Cir	Front	5	Linden: Littleleaf	Prune - Crown Clean NW	8	19	2016	In-House Trimming
NW	305		Windsor Cir	Front	1	Linden Littleleaf Greenspire	Prune - Crown Clean NW	8	19	2016	In-House Trimming
NW	305		Windsor Cir	Front	2	Maple: Marmo	Prune - Crown Clean NW	8	19	2016	In-House Trimming
NW	307		Windsor Cir	Front	1	Maple: Autumn Blaze	Prune - Crown Clean NW	8	19	2016	In-House Trimming
NW	309		Windsor Cir	Front	2	Ironwood: Hophornbeam	Prune - Crown Clean NW	8	19	2016	In-House Trimming
NW	203		Windsor Cir	Front	2	Maple: Marmo	Prune - Crown Clean NW	8	19	2016	In-House Trimming

Quadrant	Address	Suffix	Street	Side	Site	Species	WorkType	Completed Date			Completed By
								MM	DD	YY	
NW	205		Windsor Cir	Front	3	Linden Redmond	Prune - Crown Clean NW	8	19	2016	In-House Trimming
NW	206		Windsor Cir	Front	3	Linden Littleleaf Greenspire	Prune - Crown Clean NW	8	19	2016	In-House Trimming
NW	206		Windsor Cir	Front	6	Unknown	Prune - Crown Clean NW	8	19	2016	In-House Trimming
NW	208		Windsor Cir	Front	2	Linden: Littleleaf	Prune - Crown Clean NW	8	19	2016	In-House Trimming
NW	208		Windsor Cir	Front	3	Maple: Crimson King	Prune - Crown Clean NW	8	19	2016	In-House Trimming
NW	208		Windsor Cir	Front	6	Maple: Crimson King	Prune - Crown Clean NW	8	19	2016	In-House Trimming
NW	209		Windsor Cir	Front	1	Linden: Littleleaf	Prune - Crown Clean NW	8	19	2016	In-House Trimming
NW	209		Windsor Cir	Front	2	Hornbeam: American	Prune - Crown Clean NW	8	19	2016	In-House Trimming
NW	301		Windsor Cir	Front	1	Oak: White	Prune - Crown Clean NW	8	19	2016	In-House Trimming
NW	301		Windsor Cir	Front	2	Linden: Littleleaf	Prune - Crown Clean NW	8	19	2016	In-House Trimming
NW	302		Windsor Cir	Front	1	Linden: Littleleaf	Prune - Crown Clean NW	8	19	2016	In-House Trimming
NW	302		Windsor Cir	Front	2	Maple: Crescendo Sugar	Prune - Crown Clean NW	8	19	2016	In-House Trimming
NW	304		Windsor Cir	Front	2	Hackberry Common	Prune - Crown Clean NW	8	19	2016	In-House Trimming
NW	304		Windsor Cir	Front	3	Linden Sterling Silver	Prune - Crown Clean NW	8	19	2016	In-House Trimming
NW	304		Windsor Cir	Front	5	Hackberry Common	Prune - Crown Clean NW	8	19	2016	In-House Trimming
NW	309		Windsor Cir	Front	3	Maple: Autumn Blaze	Prune - Crown Clean NW	8	19	2016	In-House Trimming
SW	32		Roosevelt St	Front	1	Hackberry Common	Prune - Hanger	8	9	2016	In-House Trimming
SW	1202		10th St /S	Front	2	Maple: Crimson King	Trimming-Internal Request	8	5	2016	In-House Trimming
SE	1710		Cambridge Dr	Side	2	Black Tupelo	Trimming-Internal Request	8	8	2016	In-House Trimming
SW	907		4th St /S	Front	1	Maple: Crimson King	Call - Trimming Request	8	12	2016	Skyline-Trimming.
SW	323		Walnut St	Front	1	Maple: Crimson King	Call - Trimming Request	8	3	2016	Skyline-Trimming.
SW	323		Walnut St	Front	2	Maple: Crimson King	Call - Trimming Request	8	10	2016	Skyline-Trimming.
SW	323		Walnut St	Side	1	Maple: Green Mountain Sugar	Call - Trimming Request	8	10	2016	Skyline-Trimming.
SW	121		7th St /N	Side	1	Mulberry: Spp.	Trimming-Internal Request	8	12	2016	Skyline-Trimming.
						Total In House Trimming:	339				
						Total Contracted Trimming:	5				
						Total Tree's Trimmed:	344				

Individual site detail available upon request

September-October Fall Planting

Planting team will start in the West quadrant.

September-October 2016 Planting Information

Planting Sites In-House:	
Current Number of Planting Sites Contracted (final number TBD):	140
Sites Removed from Planting*:	
Sites Added during planting:	
Planting Sites:	
Warranty Re-plants	0
Trees Currently on Fall Planting List	140

PLANTING SITES BY QUADRANT		
	FW:	7
	SW	22
	NW	23
	SE	47
	NE	<u>41</u>
		140

**Sites unable to replant due to proximity to utilities, private plantings, driveway, or other undesirable growth space conditions.*